

13-37N20D DRAFTING CHAIR ASSEMBLY INSTRUCTIONS



FEATURE

- PNEUMATIC SEAT HEIGHT ADJUSTMENT**
 To raise seat remove pressure from seat and lift lever (1) up.
 To lower seat height sit on chair and lift lever (1) up.
- FOOTRING HEIGHT ADJUSTMENT**
 To adjust footring height, loosen knob (2) adjust footring to desired height, and tighten knob (2) completely to secure footring into position.

PART	QTY
1. Base	1
2. Casters	5
3. Pneumatic Cylinder	1
4. Footring	1
5. Seat Cushion	1
6. Back Assembly	1
7. Allen Screws	4
8. Back Support (Pre-Installed)	1
9. Allen Wrench	1

Remove all parts from carton, separate by part numbers indicated on parts list, and verify part quantities.

STEP 1 Insert five Casters (2) into Base (1), push hard until you feel or hear the Caster (2) snap into place.

STEP 2 Slide Pneumatic Cylinder (3) through Footring (4) and into Base (1).

STEP 3 Attach Back Support (8) to rear of Seat Cushion (5) using four Allen Screws (7),

FULLY TIGHTEN ALL SCREWS USING ALLEN WRENCH (9).

STEP 4 Place the assembled seat on top of Pneumatic Cylinder (3) and apply downward pressure.

ATTENTION: MAKE SURE ALL SCREWS ARE FULLY TIGHTENED BEFORE USING CHAIR.

STEP 1

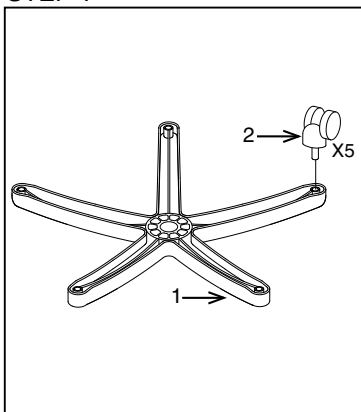

STEP 2

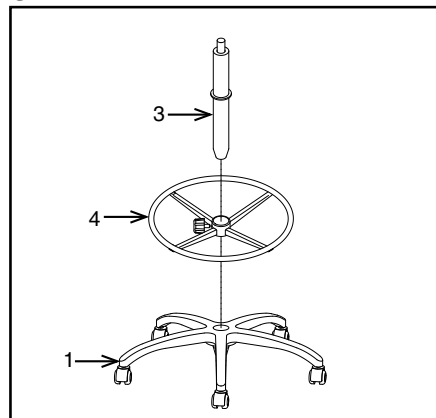

STEP 3

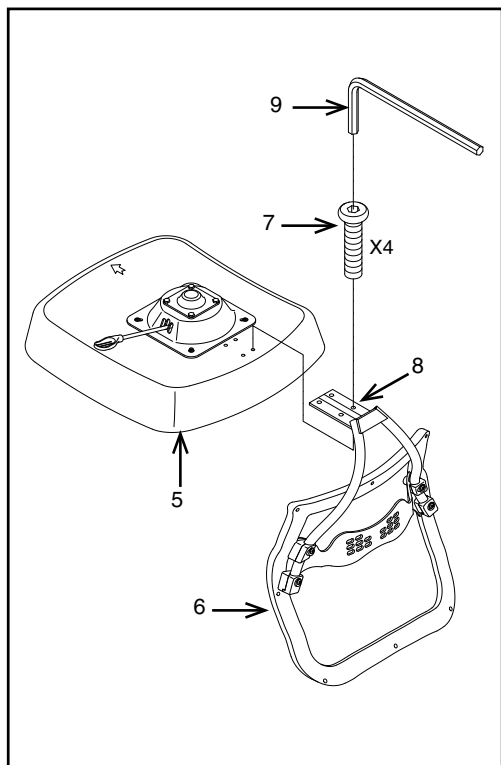

STEP 4

