

desk it.	
Kent Series	2
Studio Series	5
Madison Series	8
Nexus Series	11
Ultra Series	14
connect it.	17
space it.	29
big & tall it.	35
raise it.	37
nest it.	39
mesh it.	41
screen it.	45
task it.	45
leather it.	46
manage it.	47
healthcare it.	55
lounge it.	56
accent it. /Prado Series.....	62
guest it.	65
stack it.	67
café it.	70
add it.	73
cube it.	74
swatch it.	79
find it.	83
order it.	84

desk it.



Mahogany

- K-47GM Bullet Desk with Glass Modesty 72"x36"
- K-70 Bridge 48"x24"
- K-43 Credenza Shell 72"x20"
- K-44H Open Overhead Hutch 72"x14"
- K-4DG Glass Door Kit for Open Overhead Hutch
- K-75 File/File Ped for Credenza



LCH - Light Cherry



MAH - Mahogany



ESP - Espresso

Kent Series

Kent features genuine wood veneer surfaces, fluted edge styling and curved metal pulls for a beautiful compliment to any office environment. Choose from many contour shape surfaces for contemporary design solutions in offices, reception and conference areas. Tops feature common grain direction on all components of L- and U-shape workstations. All models feature select hardwood veneers crafted in traditional fashion and finished in Mahogany, Light Cherry, or Espresso multi-step finishes for subtle elegance.

Modular design allows for quick and easy changes and reconfigurations for long-term flexibility. Desk, return and credenza shells are non-handed for left or right use. Desk shells ship flat for easy handling and protection; simple assembly required. Pedestals are built fully assembled for immediate use – slide underneath shells or permanently mount.



Reeded Edge Styling

2 we stock it.

Kent Series Typicals



Light Cherry
 K-89 Bow Top Desk 72"x39"
 K-50 4-Door Credenza 72"x20"
 K-44H Open Overhead Hutch 72"x14"
 K-4DW Wood Door Kit for Open Overhead Hutch



Espresso
 K-89 Bow Top Desk Shell 72"x39"
 K-70 Bridge 48"x24"
 K-43 Credenza Shell 72"x20"
 K-44H Open Overhead Hutch 72"x14"
 K-4DG Glass Door Kit for Open Overhead Hutch
 K-75 File/File Ped for Credenza



Legal/letter filing with pre-installed hardware. Includes full-extension, steel ball-bearing drawer slide.



Single-key, full-locking pedestals are standard. Units keyed alike with multiple lock numbers available for an additional charge. Folding key design.



Elegant fluted edge design.



Desk pads or glass recommended for protection of wood veneer surfaces.



Bow Top Desk
 72"x39"
KTYP1
 27.3 cu.ft. - 295 lbs.
 Consists of: K-89, 65, 74
List \$3,250



Double Ped Desk
 72"x36"
KTYP2
 26.5 cu.ft. - 291 lbs.
 Consists of: K-01, 65, 74
List \$3,180



Double Ped Desk
 66"x30"
KTYP3
 24.5 cu.ft. - 260 lbs.
 Consists of: K-02, 65, 74
List \$2,950



Kneespace Credenza
 72"x20"
KTYP5
 20.9 cu.ft. - 218 lbs.
 Consists of: K-43, 66, 75
List \$2,615



Kneespace Credenza
 66"x20"
KTYP6
 20.3 cu.ft. - 211 lbs.
 Consists of: K-11, 66, 75
List \$2,525



Double Lateral File Credenza
 72"x20"
KTYP7
 34.7 cu.ft. - 287 lbs.
 Consists of: K-43, 68, 68
List \$3,700



L-Shape w/Bow Top
 72"x87"
KTYP8
 30.5 cu.ft. - 362 lbs.
 Consists of: K-89, 65, 45, 75
List \$4,020



L-Shape
 66"x78"
KTYP9
 27.7 cu.ft. - 326 lbs.
 Consists of: K-02, 65, 45, 75
List \$3,720



Executive Office
KTYP11
 57.5 cu.ft. - 642 lbs.
 Consists of: K-89, 65, 74, 43, 66, 75, 44H, 4DW
List \$7,725

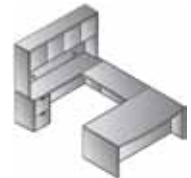

U-Shape w/Hutch
 72"x107"
KTYP12
 47.5 cu.ft. - 582 lbs.
 Consists of: K-89, 65, 70, 43, 75, 44H, 4DW
List \$6,890



U-Shape w/Hutch + Storage
 108"x107"
KTYP13
 69.3 cu.ft. - 785 lbs.
 Consists of: K-89, 65, 70, 43, 75, 44H, 4DW, 12, 55
List \$9,600



Reception Station
 72"x72"x43"
KTYP19
 37.2 cu.ft. - 472 lbs.
 Consists of: K-122, 65, 125, 75, 124
List \$5,005

LCH = Light Cherry MAH = Mahogany ESP = Espresso

*Measurements are rounded to the nearest inch. For exact dimensions, please call.

Kent Series

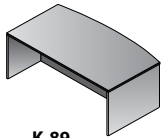

K-89
72"x39"x29"
Bow Top
Desk Shell
List \$1,635

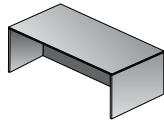

K-01
72"x36"x29"
Desk Shell
List \$1,565

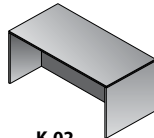

K-02
66"x30"x29"
Desk Shell
List \$1,335

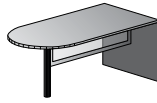

K-47GM
72"x36"x29"
Bullet
List \$1,555

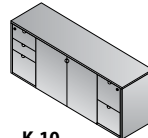

K-10
72"x20"x29"
Storage Credenza
Ships Assembled
List \$3,000

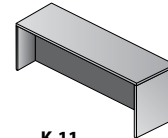

K-11
66"x20"x29"
Credenza Shell
List \$1,060

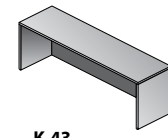

K-43
72"x20"x29"
Credenza Shell
List \$1,150

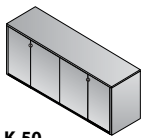

K-50
72"x20"x29"
4-Door Credenza
List \$2,295

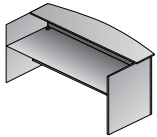

K-122
72"x30"/36"x43"
Reception Desk
List \$2,110

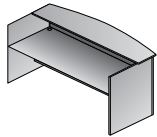

K-122GM
72"x30"/36"x43"
Reception Desk
(Glass Top)
List \$2,240

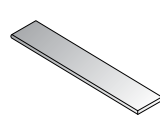

K-124
60"x12.5"x1"
Counter for Return
List \$400

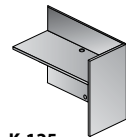

K-125
42"x20"x42"
Reception Return
List \$885

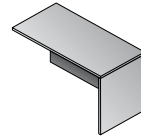

K-45
48"x24"x29"
Return Shell
List \$775

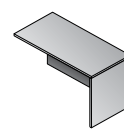

K-96
42"x24"x29"
Return Shell
List \$685

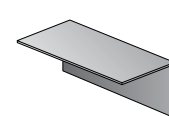

K-70
48"x24"x29"
Bridge
List \$635

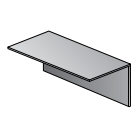

K-98
42"x24"x29"
Bridge
List \$575

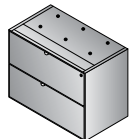

K-68
35"x18"x27"
Lateral File Ped
Ships Assembled
List \$1,275

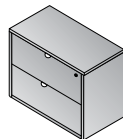

K-12
37"x20"x29"
Lateral File
Ships Assembled
List \$1,625

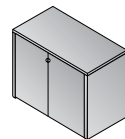

K-13
37"x20"x29"
Storage Cabinet
List \$1,470

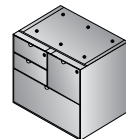

K-69
32"x18"x27"
Combo File Ped
Ships Assembled
List \$1,525

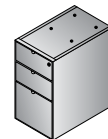

K-65
15.5"x24"x27"
BBF Ped - Desk
Ships Assembled
List \$880

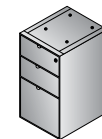

K-66
15.5"x18"x27"
BBF Ped - Credenza/Return
Ships Assembled
List \$735

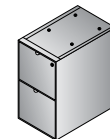

K-74
15.5"x24"x27"
FF Ped - Desk
Ships Assembled
List \$735

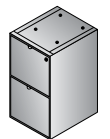

K-75
15.5"x18"x27"
FF Ped - Credenza/Return
Ships Assembled
List \$730

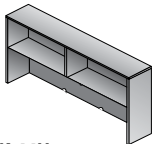

K-44H
72"x14"x42"
Open Overhead Hutch
List \$1,625

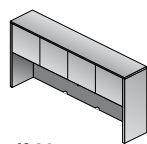

K-39
66"x14"x42"
Overhead Hutch
w/wood doors
List \$1,600

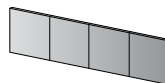

K-4DW
Wood Door Kit for
Open Overhead Hutch
List \$235

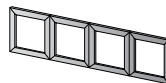

K-4DG
Glass Door Kit for
Open Overhead Hutch
List \$550

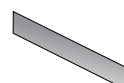

K-TACK67
Black Fabric
Tackboard
for K-44H Overhead
List \$240

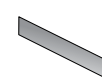

K-TACK63
Black Fabric
Tackboard
for K-39 Overhead
List \$235

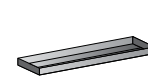

OFD-LED.20
Task Light
for Overhead/Shelf
List \$240

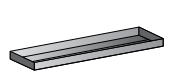

OFD-LED.38
Task Light
for Overhead/Shelf
List \$270

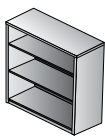

K-55
36"x14"x42"
Bookcase/
Open Hutch
List \$1,085

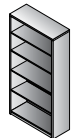

K-56
36"x14"x70"
5-Shelf Bookcase
List \$1,525

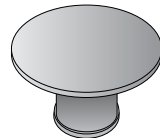

K-58
42" Dia. x29"H
Round Table
List \$1,275

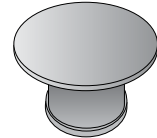

K-59
48" Dia. x29"H
Round Table
List \$1,415

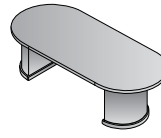

K-35
72"x36"x29"
6' Racetrack Table
List \$1,785

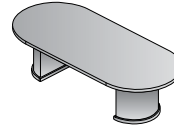

K-60
96"x42"x29"
8' Racetrack Table
List \$2,200

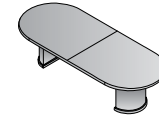

K-61
120"x48"x29"
10' Racetrack Table
List \$2,850

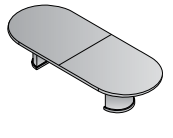

K-62
144"x48"x29"
12' Racetrack Table
List \$3,900

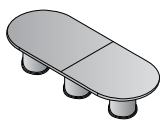

K-63
168"x48"x29"
14' Racetrack Table
List \$4,600

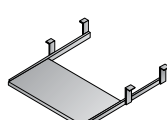

K-14
26"x12"
Keyboard Tray
List \$135

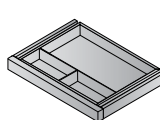

K-15
20"x14"
Center Drawer
List \$135

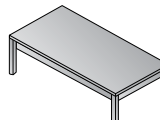

K-19
48"x24"x16"
Coffee Table
List \$665

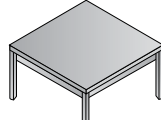

K-20
24"x24"x20"
End Table
List \$475

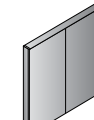

K-100
48"x4"x48"
Presentation Board
Ships Assembled
List \$1,525



OSP001-OSP0050
Lock Core
and Keys
List \$25

LCH = Light Cherry MAH = Mahogany ESP = Espresso



Cherry
 (STYP12CHY)
 S-89 Bow Top Desk 72"x39"
 S-65 Box/Box/File Ped
 S-70 Bridge 48"x24"
 S-43 Credenza Shell 72"x20"
 S-75 File/File Ped
 S-44 Overhead Storage 72"x14"

Studio Series

Studio features soft radius edges and compound curved corners, beautiful in any office environment. Select hardwood veneers and solid wood edges are carefully crafted and finished in Cherry with multi-step, medium-gloss finish for sophisticated appearance. Tops feature common grain direction on all components of L- and U-shape workstations. Returns and bridges include reverse-cope edges for smooth work surface connections.



Radius Edge Styling

Studio Series Typical



Cherry
S-62 12' Racetrack Table
S-56 5-Shelf Bookcase



Cherry
(STYP11CHY)
S-89 Bow Top Desk 72"x39"
S-65 Box/Box/File Ped
S-74 File/File Ped
S-43 Credenza Shell 72"x20"
S-66 Box/Box/File Ped
S-75 File/File Ped
S-44 Overhead Storage 72"x14"



Legal/letter filing with pre-installed hardware. Includes full-extension, steel ball-bearing drawer slide.



Single-key, full-locking pedestals are standard. Units keyed alike with multiple lock numbers available for an additional charge. Folding key design.



Soft radius edge design.



Desk pads or glass recommended for protection of wood veneer surfaces.

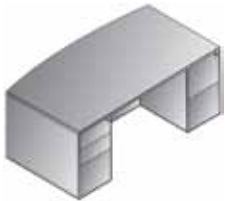

Bow Top Desk
72"x39"
STYP1
22.3 cu.ft. - 336 lbs.
Consists of: S-89, 65, 74
List \$3,250

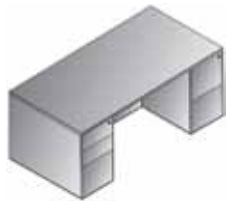

Double Ped Desk
72"x36"
STYP2
21.4 cu.ft. - 322 lbs.
Consists of: S-01, 65, 74
List \$3,180



Double Ped Desk
66"x30"
STYP3
19.8 cu.ft. - 281 lbs.
Consists of: S-02, 65, 74
List \$2,950



Kneespace Credenza
72"x20"
STYP5
16.6 cu.ft. - 234 lbs.
Consists of: S-43, 66, 75
List \$2,615



Double Lateral File Credenza
72"x20"
STYP7
28.8 cu.ft. - 311 lbs.
Consists of: S-43, 68, 68
List \$3,700



L-Shape w/Bow Top
72"x87"
STYP8
24.2 cu.ft. - 404 lbs.
Consists of: S-89, 65, 45, 75
List \$4,020



L-Shape
66"x78"
STYP9
22 cu.ft. - 349 lbs.
Consists of: S-02, 65, 45, 75
List \$3,720

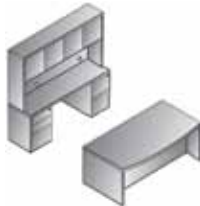

Executive Office
STYP11
46.6 cu.ft. - 833 lbs.
Consists of: S-89, 65, 74, 43, 66, 75, 44
List \$7,725

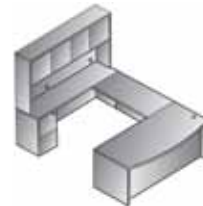

U-Shape w/Hutch
72"x107"
STYP12
36.9 cu.ft. - 675 lbs.
Consists of: S-89, 65, 70, 43, 75, 44
List \$6,890



Reception Station
72"x72"x43"H
STYP19
26.7 cu.ft. - 488 lbs.
Consists of: S-122, 65, 125, 75, 124
List \$5,005

Studio Series

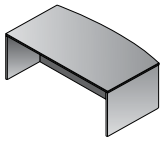

S-89-CHY
72"x39"x29"
Bow Top
Desk Shell
List \$1,635

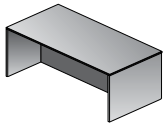

S-01-CHY
72"x36"x29"
Desk Shell
List \$1,565

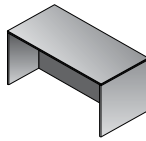

S-02-CHY
66"x30"x29"
Desk Shell
List \$1,335

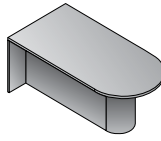

S-47-CHY
72"x36"x29"
Bullet
List \$1,555

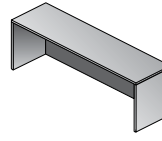

S-43-CHY
72"x20"x29"
Credenza Shell
List \$1,150

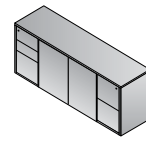

S-10-CHY
72"x20"x29"
Storage Credenza
Ships Assembled
List \$3,000

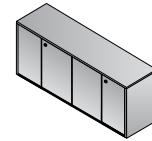

S-50-CHY
72"x20"x29"
4-Door Credenza
List \$2,295

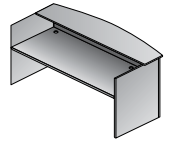

S-122-CHY
72"x30"/36"x43"
Reception Desk
List \$2,110

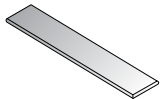

S-124-CHY
60"x12.5"x1"
Counter for Return
List \$400

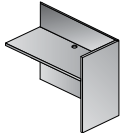

S-125-CHY
42"x20"x42"
Reception Return
List \$885

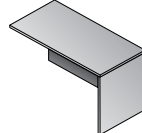

S-45-CHY
48"x24"x29"
Return Shell
List \$775

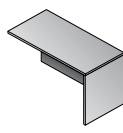

S-96-CHY
42"x24"x29"
Return Shell
List \$685

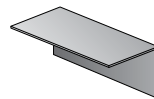

S-70-CHY
48"x24"x29"
Bridge
List \$635

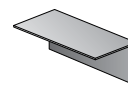

S-98-CHY
42"x24"x29"
Bridge
List \$575

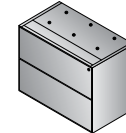

S-68-CHY
35"x18"x27"
Lateral File Ped
Ships Assembled
List \$1,275

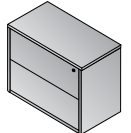

S-12-CHY
37"x20"x29"
Lateral File
Ships Assembled
List \$1,625

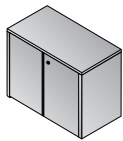

S-13-CHY
37"x20"x29"
Storage Cabinet
List \$1,470

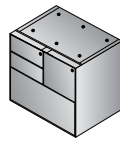

S-69-CHY
32"x18"x27"
Combo File Ped
Ships Assembled
List \$1,525

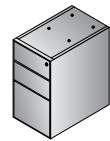

S-65-CHY
15.5"x24"x27"
BBF Ped - Desk
Ships Assembled
List \$880

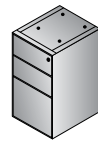

S-66-CHY
15.5"x18"x27"
BBF Ped -
Credenza/Return
Ships Assembled
List \$735

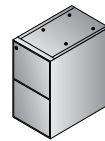

S-74-CHY
15.5"x24"x27"
FF Ped - Desk
Ships Assembled
List \$735

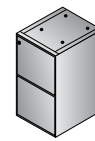

S-75-CHY
15.5"x18"x27"
FF Ped -
Credenza/Return
Ships Assembled
List \$730

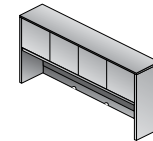

S-44-CHY
72"x14"x42"
Overhead Storage
List \$1,860

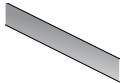

S-TACK67
Black Fabric
Tackboard
for S-44 Overhead
List \$240

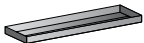

OFD-LED.20
Task Light
for Overhead/Shelf
List \$240



OFD-LED.38
Task Light
for Overhead/Shelf
List \$270

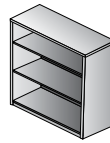

S-55-CHY
36"x14"x42"
Bookcase/Open Hutch
List \$1,085

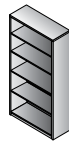

S-56-CHY
36"x14"x70"
5-Shelf Bookcase
List \$1,525

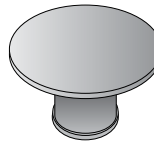

S-58-CHY
42" Dia. x29"H
Round Table
List \$1,275

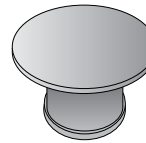

S-59-CHY
48" Dia. x29"H
Round Table
List \$1,415

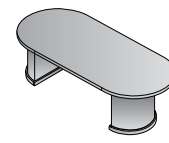

S-35-CHY
72"x36"x29"
6' Racetrack Table
List \$1,785

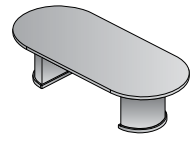

S-60-CHY
96"x42"x29"
8' Racetrack Table
List \$2,200

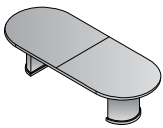

S-61-CHY
120"x48"x29"
10' Racetrack Table
List \$2,850

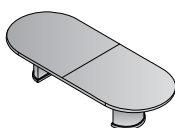

S-62-CHY
144"x48"x29"
12' Racetrack Table
List \$3,900

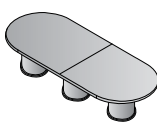

S-63-CHY
168"x48"x29"
14' Racetrack Table
List \$4,600

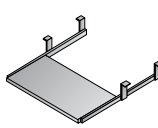

S-14-CHY
26"x12"
Keyboard Tray
List \$135

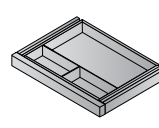

S-15-CHY
20"x14"
Center Drawer
List \$135

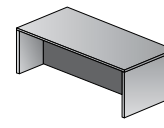

S-19-CHY
48"x24"x16"
Coffee Table
List \$665

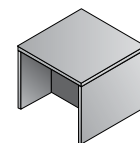

S-20-CHY
24"x24"x20"
End Table
List \$475

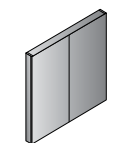

S-100-CHY
48"x4"x48"
Presentation Board
Ships Assembled
List \$1,525



OSP0001-OSP0050
Lock Core
and Keys
List \$25

CHY = Cherry

*Measurements are rounded to the nearest inch. For exact dimensions, please call.

desk it.



Cherry

(MTYP13CHY)

- M-89 Bow Desk Top/Mod Set 72"x42"
- M-65 Box/Box/File Ped for 72"/84" Desk
- M-71 False Ped for 72"/84" Desk
- M-70 Bridge Top/Mod Set 49.5"x24"
- M-43 Credenza Top/Mod Set 72"x24"
- M-73 False Ped for Credenza
- M-75 File/File Ped for Credenza/Return
- M-84 Glass Door Hutch 72"x16"
- M-12 Lateral File 36"x24"
- M-55 Bookcase/Open Hutch 36"x16"



CHY - Satin Cherry



FMAH - Figured Mahogany

Madison Series

A design for the connoisseur, Madison blends executive style, scale and characteristics with the beauty of wood craftsmanship. Hardwood veneers are carefully selected and book-matched for the natural beauty of wood. Contrasting inlay accents the design. Tops feature common grain direction on all components of L- and U-shape workstations. Returns and bridges feature reverse-cope, multistep edges for smooth work surface connections.

Executive details include 79" vertical storage heights, glass-door display hutch with light kit, and available legal-width pedestals. Conference tables feature contemporary round and racetrack tops paired with full and half-cylinder bases with veneer surfaces and solid hardwood floor-level trim.

Satin Cherry finish features subtle sheen and American cherry veneer work surfaces. Figured Mahogany finish features low sheen work surfaces.



Contrasting Inlay Accents

8 we stock it.

Madison Series Typicals



Cherry
M-04 Table Desk with Bow Front 72"x42"
M-10 Storage Credenza 72"x24"
M-84 Glass Door Hutch 72"x16"



Figured Mahogany Desk Top



Legal/letter filing with pre-installed hardware. Includes full-extension, steel ball-bearing drawer slide.



Single-key, full-locking pedestals are standard. Units keyed alike with multiple lock numbers available for an additional charge. Folding key design.



Contrasting inlay accents the design.



Desk pads or glass recommended for protection of wood veneer surfaces.



Bow Top Desk
72"x42"
MTYP1
37.8 cu.ft. - 372 lbs.
Consists of: M-89, 65, 74
List \$4,830



Double Ped Desk
72"x36"
MTYP2
36.8 cu.ft. - 352 lbs.
Consists of: M-01, 65, 74
List \$4,870

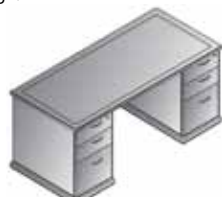

Double Ped Desk
66"x30"
MTYP3
27.6 cu.ft. - 272 lbs.
Consists of: M-02, 63, 63
List \$3,985



Kneespace Credenza
72"x24"
MTYP5
23.1 cu.ft. - 254 lbs.
Consists of: M-43, 66, 75
List \$3,400



L-Shape w/Bow Desk
72"x90"
MTYP8
51.7 cu.ft. - 463 lbs.
Consists of: M-89, 65, 71, 45, 75
List \$6,175



L-Shape
72"x84"
MTYP9
50.7 cu.ft. - 441 lbs.
Consists of: M-01, 65, 71, 45, 75
List \$6,215



Executive Office
MTYP11
100.1 cu.ft. - 864 lbs.
Consists of: M-89, 65, 74, 43, 66, 75, 84
List \$11,430

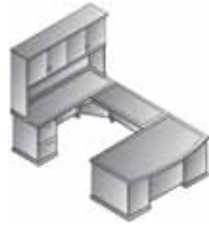

U-Shape w/Hutch
72"x115"
MTYP12
105.8 cu.ft. - 818 lbs.
Consists of: M-89, 65, 71, 70, 43, 73, 75, 44
List \$10,865

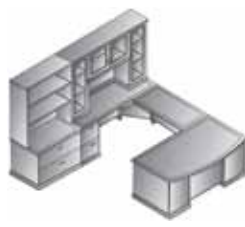

U-Shape w/Hutch + Storage
108"x115"
MTYP13
130.3 cu.ft. - 1,108 lbs.
Consists of: M-89, 65, 71, 70, 43, 73, 75, 84, 12, 55
List \$14,940



Reception Station
72"x90"
MTYP19
56.5 cu.ft. - 565 lbs.
Consists of: M-01, 65, 71, 45, 75, 127, 128
List \$8,580



Conference Group
MTYP20
50.3 cu.ft. - 465.3 lbs.
Consists of: M-60, 13, 100
List \$7,660

CHY = Satin Cherry FMAH = Figured Mahogany

*Measurements are rounded to the nearest inch. For exact dimensions, please call.

Madison Series

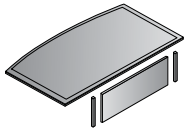

M-89
72"x42"x30"
72" Bow Desk Top/
Mod Set
List \$1,920



M-01
72"x36"x30"
Desk Top/Mod Set
List \$1,960



M-02
66"x30"x30"
Desk Top/Mod Set
List \$1,415

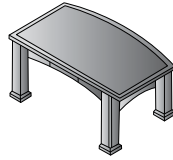

M-04
72"x42"x30"
Table Desk
List \$3,675

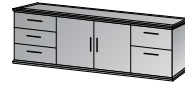

M-10
72"x24"x30"
Storage Credenza
Ships Assembled
List \$4,255

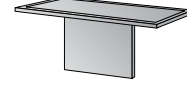

M-43
72"x24"x30"
Credenza Top/Mod Set
List \$1,300

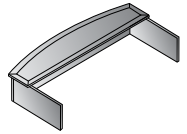

M-127
72"x35"x13"
Reception Unit Main
List \$1,445

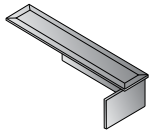

M-128
71.5"x24"x13"
Reception Unit Return
List \$920

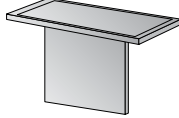

M-45
48.5"x24"x30"
Return Top/Mod Set
List \$950

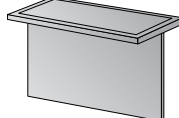

M-70
49.5"x24"x30"
Bridge Top/Mod Set
List \$1,045



M-65
20"x35.5"x28"
BBF Ped-72"/"84" Desk
Ships Assembled
List \$1,465



M-63
17"x29.5"x28"
BBF Ped-66" Desk
Ships Assembled
List \$1,285

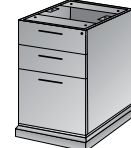

M-66
17"x23.5"x28"
BBF Ped-Credenza/Return
Ships Assembled
List \$1,075

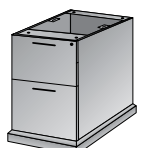

M-74
20"x35.5"x28"
FF Ped-72"/"84" Desk
Ships Assembled
List \$1,445

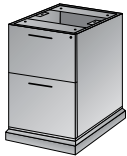

M-75
17"x23.5"x28"
FF Ped-Credenza/Return
Ships Assembled
List \$1,025

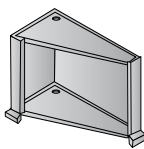

M-71
20"x35.5"x28"
False Ped-72"/"84" Desk
Ships Assembled
List \$815

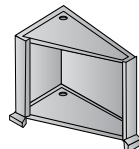

M-67
17"x29.5"x28"
False Ped-66" Desk
Ships Assembled
List \$655

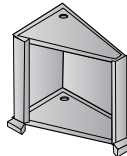

M-73
17"x23.5"x28"
False Ped-Credenza
Ships Assembled
List \$565

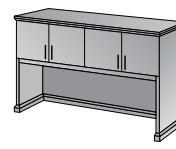

M-44
72"x16"x49"
Overhead-Wood Doors
List \$2,730



M-84
72"x16"x49"
Overhead-Glass Doors
List \$3,200



OFD-LED.20
Task Light
for 36" Overhead/Shelf
List \$240

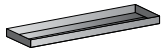

OFD-LED.38
Task Light
for 48" Overhead/Shelf
List \$270

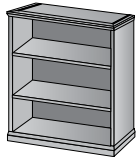

M-55
36"x16"x49"
Bookcase/Open Hutch
List \$1,470

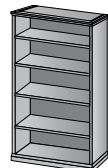

M-56
36"x16"x79"
5-Shelf Bookcase
List \$1,735

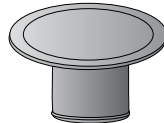

M-59
48" Dia. x29"H
Round Table
List \$2,075

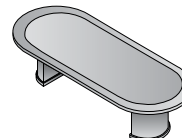

M-60
96"x42"x30"
Conference Table
List \$3,495

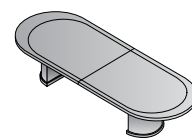

M-61
120"x48"x30"
Conference Table
List \$4,300

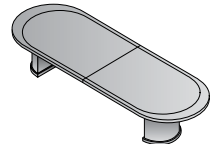

M-62
144"x48"x30"
Conference Table
List \$5,065

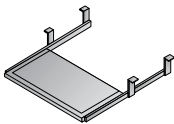

M-14
26"x12"
Keyboard Tray
List \$420

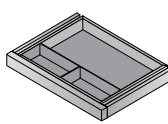

M-15
20"x16"
Center Drawer
List \$265

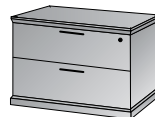

M-12
36"x24"x30"
Lateral File
Ships Assembled
List \$2,135

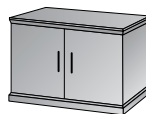

M-13
36"x24"x30"
Storage Cabinet
List \$1,855

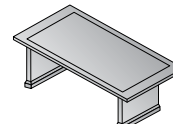

M-19
48"x24"x16"
Coffee Table
List \$905

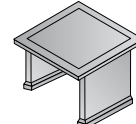

M-20
24"x24"x20"
End Table
List \$840

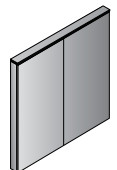

M-100
48"x6"x48"
Presentation Board
Ships Assembled
List \$2,310

CHY = Satin Cherry FMAH = Figured Mahogany



Espresso
 N-89 Bow Top Desk Shell 72"x41"
 N-70 Bridge 48"x24"
 N-43 Credenza Shell 71"x24"
 N-65 Box/Box/File Ped
 N-44H Open Overhead Hutch 71"x15"
 N-4DG Glass Door Kit for Open Overhead Hutch
 N-12 Lateral File
 N-53 Open Hutch



CHY - Cherry



MAH - Mahogany



ESP - Espresso

Nexus Reeded Edge Laminate Series

Nexus Series

Nexus is built to support today's businesses with solutions for offices, conference and reception areas that provide long-lasting furnishing value. From the executive and managers offices, to multi-person configurations, Nexus offers multiple solutions in popular Cherry, Mahogany, and Espresso colors with reeded edges.



Reeded Edge Styling

Nexus Series Typical

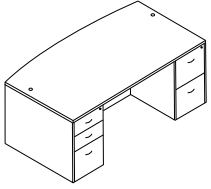

Bow Top Desk
71"x41"
NTYP1
21.3 cu.ft. - 325 lbs.
Consists of: N-89, 65, 74
List \$1,625

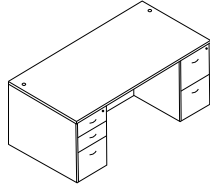

Double Ped Desk
71"x35"
NTYP2
20.4 cu.ft. - 314 lbs.
Consists of: N-01, 65, 74
List \$1,585

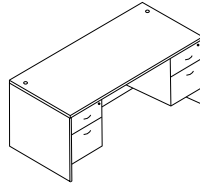

Double Ped Desk
66"x30"
NTYP3
15.7 cu.ft. - 257 lbs.
Consists of: N-02, 80, 80
List \$1,245

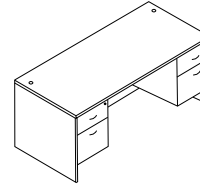

Double Ped Desk
60"x30"
NTYP4
15.6 cu.ft. - 249 lbs.
Consists of: N-03, 80, 80
List \$1,225

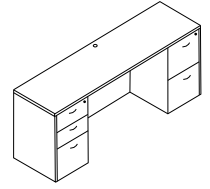

Kneespace Credenza
71"x24"
NTYP5
19.1 cu.ft. - 275 lbs.
Consists of: N-43, 65, 74
List \$1,415

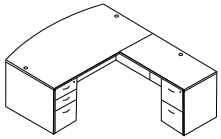

L-Shape w/Bow
71"x89"
NTYP8
25.1 cu.ft. - 416 lbs.
Consists of: N-89, 65, 45, 74
List \$1,970

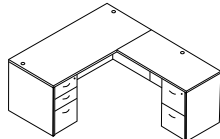

L-Shape
66"x78"
NTYP9
22.9 cu.ft. - 379 lbs.
Consists of: N-02, 65, 45, 74
List \$1,810

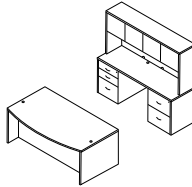

Executive Office
NTYP11
47.3 cu.ft. - 740 lbs.
Consists of: N-89, 65, 74, 43, 65, 74, 44H, 4DW
List \$3,615

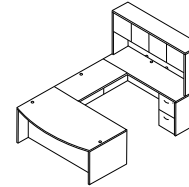

U-Shape w/Hutch
71"x113"
NTYP12
36.2 cu.ft. - 658 lbs.
Consists of: N-89, 65, 70, 43, 74, 44H, 4DW
List \$2,870

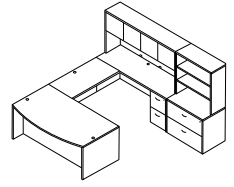

U-Shape w/Hutch + Storage
107"x113"
NTYP13
55.5 cu.ft. - 890 lbs.
Consists of: N-89, 65, 70, 43, 74, 44H, 4DW, 12, 53
List \$4,230

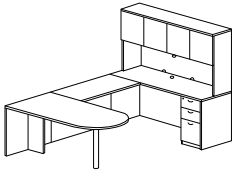

U-Shape w/Bullet
107"x72"
NTYP14
28.4 cu.ft. - 525 lbs.
Consists of: N-47, 70, 43, 65, 44H, 4DW
List \$2,330

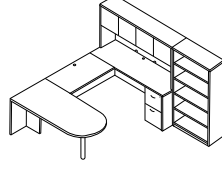

U-Shape w/Bullet + Bookcase
107"x108"
NTYP16
35.2 cu.ft. - 674 lbs.
Consists of: N-47, 70, 43, 74, 44H, 4DW, 56
List \$2,815

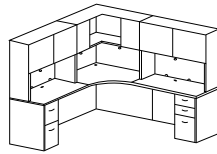

Corner Workstation
90"x90"x65"
NTYP17
41.1 cu.ft. - 801 lbs.
Consists of: N-45, 74, 83, 45, 65, 34, 84, 34
List \$3,595

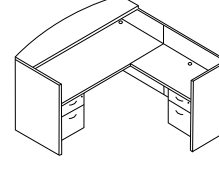

Reception Station
71"x71"x42"H
NTYP19
22.2 cu.ft. - 419 lbs.
Consists of: N-122, 80, 125, 80
List \$1,925

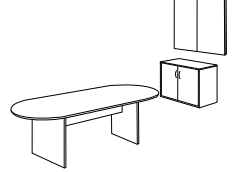

Conference Group
NTYP20
24.8 cu.ft. - 409 lbs.
Consists of: N-36, 13, 100
List \$1,865

NTYP13

List \$4,230



Mahogany
N-89 Bow Top Desk 71"x41"
N-65 Box/Box/File Ped
N-70 Bridge 48"x24"
N-43 Credenza Shell 71"x24"
N-74 File/File Ped
N-44H Open Overhead Hutch 71"x15"
N-4DW 4-Door Laminate Kit
N-12 Lateral File 36"x22"
N-53 Open Hutch 36"x14"

Cherry
N-02 Straight Front Desk 66"x30"
N-45 Return 48"x24"
N-80 Mobile Ped (2)

CHY = Cherry MAH = Mahogany ESP = Espresso

Nexus Series

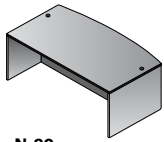

N-89
71"x41"x29"
Bow Top Desk Shell
List \$605

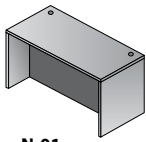

N-01
71"x36"x29"
Desk Shell
List \$565

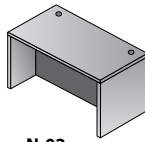

N-02
66"x30"x29"
Desk Shell
List \$445

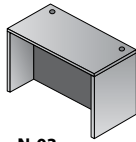

N-03
60"x30"x29"
Desk Shell
List \$425

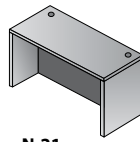

N-21
48"x30"x29"
Desk Shell
List \$405

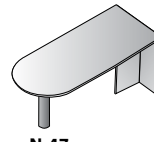

N-47
71"x36"x29"
Bullet
List \$550

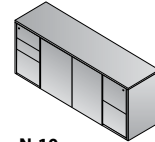

N-10
72"x22"x29"
Storage Credenza
List \$1,550

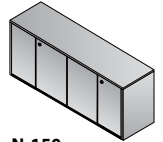

N-150
71"x24"x29"
Storage Credenza
List \$1,550

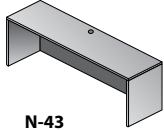

N-43
71"x24"x29"
Credenza Shell
List \$395

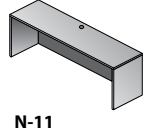

N-11
66"x24"x29"
Credenza Shell
List \$350

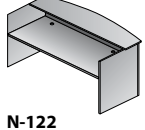

N-122
71"x30"/36"x42"
Reception Desk
List \$730

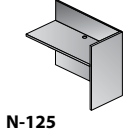

N-125
42"x24"x41"
Reception Return
List \$395

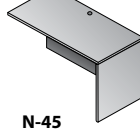

N-45
48"x24"x29"
Return Shell
List \$345

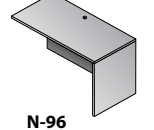

N-96
42"x24"x29"
Return Shell
List \$315

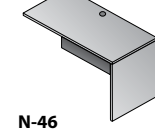

N-46
42"x20"x29"
Return Shell
(Use N-76 Pedestal)
List \$285

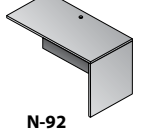

N-92
35"x24"x29"
Return Shell
List \$280

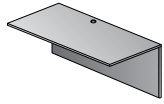

N-70
48"x24"x29"
Bridge
List \$275

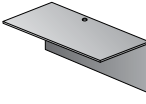

N-98
42"x24"x29"
Bridge
List \$245

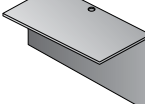

N-93
35"x24"x29"
Bridge
List \$220

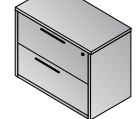

N-12
36"x22"x29"
Lateral File
Ships Assembled
List \$1,035

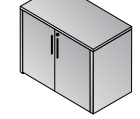

N-13
36"x22"x29"
Storage Cabinet
List \$475

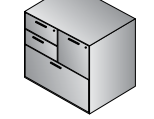

N-69
31"x23"x29"
Combo File
Ships Assembled
List \$955

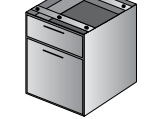

N-80
15.5"x22"x21"
Hanging Ped - Desk
Ships Assembled
List \$400

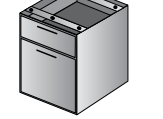

N-76
15.5"x18.5"x21"
Hanging Ped (for N-46)
Ships Assembled
List \$375

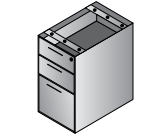

N-65
15.5"x22"x28"
BBF Ped
Ships Assembled
List \$535

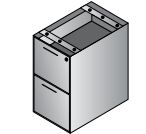

N-74
15.5"x20"x28"
FF Ped
Ships Assembled
List \$485

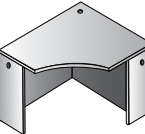

N-83
42"x42"x29"
Corner Unit
List \$430

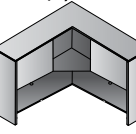

N-84
42"x42"x36"
Corner Hutch
List \$625

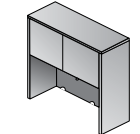

N-34
48"x15"x36"
Hutch w/Doors
List \$415

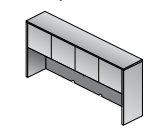

N-39
66"x15"x36"
Overhead Storage
w/Laminate Doors
List \$510

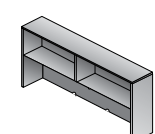

N-44H
71"x15"x36"
Open Overhead Hutch
List \$445

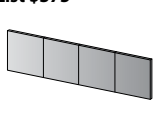

N-4DW
4-Door Laminate Kit
for Open Overhead
List \$130

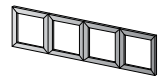

N-4DG
4-Door Glass Kit
for Open Overhead
Aluminum Frame
List \$420

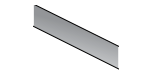

N-TACK44
Black Fabric
Tackboard for N-34
Overhead
List \$210

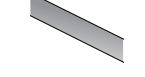

N-TACK63
Black Fabric
Tackboard for N-39
Overhead
List \$235



N-TACK67
Black Fabric
Tackboard for N-44H
Overhead
List \$210

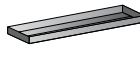

OFD-LED.20
Task Light
for Overhead/Shelf
List \$240

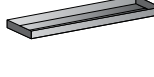

OFD-LED.38
Task Light
for Overhead/Shelf
List \$270

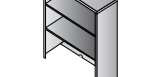

N-53
36"x14"x36"
Open Hutch
List \$325



N-55
36"x14"x42"
3-Shelf Bookcase
List \$395

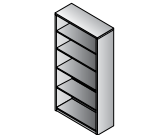

N-56
36"x14"x65"
5-Shelf Bookcase
List \$535

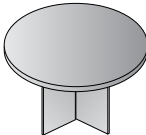

N-23
47" Dia. x29"H
Round Table
List \$595

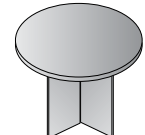

N-27
42" Dia. x29"H
Round Table
List \$565

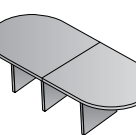

N-38N
144"x48"x29"
12' Racetrack Table
List \$1,525

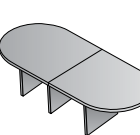

N-37N
120"x48"x29"
10' Racetrack Table
List \$1,045

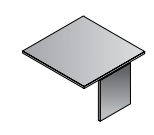

N-3738EXT
48"x48"x29"
Conference Table
Extension (for N-37N
and N-38N)
List \$550

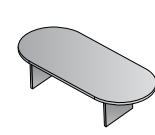

N-36
95"x44"x29"
8' Racetrack Table
List \$765

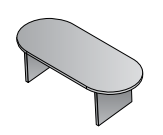

N-35
71"x35"x29"
6' Racetrack Table
List \$585

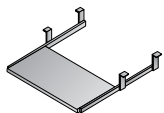

N-14
28"x14"
Keyboard Tray
List \$100

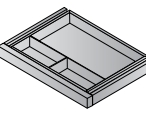

N-15
20"x15"
Center Drawer
List \$100



N-152
22.5"x24"x65"
Wardrobe Cabinet
Ships Assembled
List \$1,425

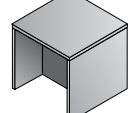

N-20
24"x24"x20"
End Table
List \$195

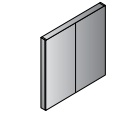

N-100
48"x4"x48"
Presentation Board
Ships Assembled
List \$625

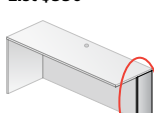

N-243LEG
28"x11"
Half Leg for Credenza/
Return Shell (LEG ONLY)
List \$85



UN401C-450C
Lock Core
and Keys
List \$25

CHY = Cherry MAH = Mahogany ESP = Espresso

*Measurements are rounded to the nearest inch. For exact dimensions, please call.

desk it.

NEW
Walnut Strand
Finish!

Walnut Strand

- OFD-189 Bow Front Shell 36"/41" x 71"
- OFD-175 File/File Ped
- OFD-170 Bridge 48"x24"
- OFD-166 Box/Box/File Ped
- OFD-143 Credenza Shell 24 "x 71"
- OFD-144 Overhead Hutch 71"x36"
- OFD-4DG 4-Door Glass Kit



CHE - Cherry



MAH - Mahogany



ESP - Espresso

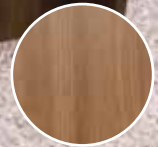

WAL - Walnut Strand

Contemporary Laminate Series

Ultra Laminate Series

Distinguish your office with the sophisticated look of the Ultra Laminate Series. They are thermally fused laminates with 3mm PVC, dura-edge detailing on all exposed edges. All peds are fully assembled, reversible and lockable. Ultra offers full modesty panels and full ball-bearing suspension. Colors of the Ultra Laminate include Cherry, Mahogany, Espresso and Walnut Strand.

Great Value!
get it.

14 we stock it.

Ultra Laminate Series Typicals

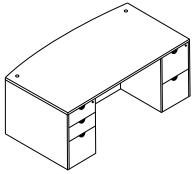

Bow Top Desk
71"x41"
UTYP1
21.3 cu.ft. - 347 lbs.
Consists of: OFD-189,
166, 175
List \$1,305

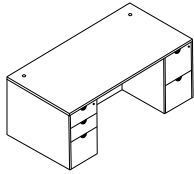

Double Ped Desk
71"x36"
UTYP2
20.4 cu.ft. - 336 lbs.
Consists of: OFD-101,
166, 175
List \$1,270

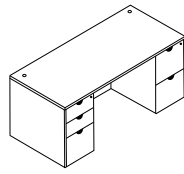

Double Ped Desk
66"x30"
UTYP3
19.1 cu.ft. - 263 lbs.
Consists of: OFD-102,
166, 175
List \$1,240

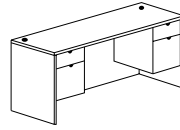

Kneespace Credenza
w/Hanging Peds
71"x24"
UTYP4
16 cu.ft. - 245 lbs.
Consists of: OFD-143,
107, 107
List \$945

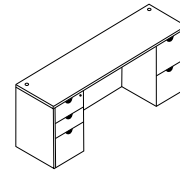

Kneespace Credenza
71"x24"
UTYP5
19.1 cu.ft. - 300 lbs.
Consists of: OFD-143, 166,
175
List \$1,175

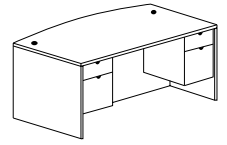

Bow Top Desk
w/Hanging Peds
71"x41"
UTYP6
19 cu.ft. - 388 lbs.
Consists of: OFD-189, 107,
107
List \$1,075

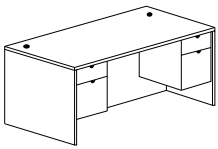

Double Ped Desk
w/Hanging Peds
71"x35"
UTYP7
18 cu.ft. - 280 lbs.
Consists of: OFD-101,
107, 107
List \$1,040

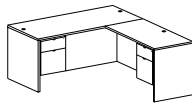

L-Shape w/Hanging Peds
71"x77"
UTYP8
20.4 cu.ft. - 361 lbs.
Consists of: OFD-101, 146,
107, 107
List \$1,275

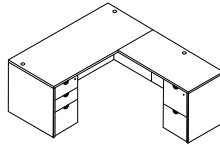

L-Shape
66"x78"
UTYP9
22.9 cu.ft. - 379 lbs.
Consists of: OFD-102, 166,
145, 175
List \$1,505

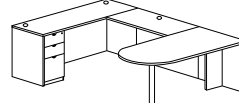

Bullet U-Shape
71"x108"
UTYP10
22.9 cu.ft. - 418 lbs.
Consists of: OFD-147, 170,
143, 166
List \$1,365

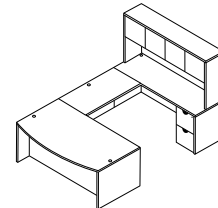

U-Shape w/Hutch
71"x113"
UTYP12
36.2 cu.ft. - 658 lbs.
Consists of: OFD-189, 166,
175, 143, 170, 144, 4DW
List \$2,425

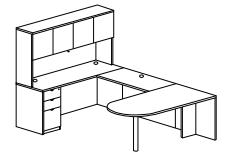

Bullet U-Shape set
71"x108"
UTYP14
31.1 cu.ft. - 608 lbs.
Consists of: OFD-147, 170,
143, 144, 4DW, 166
List \$1,940

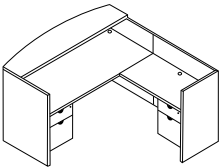

Reception Station
71"x71"x42"H
UTYP19
22.2 cu.ft. - 419 lbs.
Consists of: OFD-169, 180,
107, 107
List \$1,600

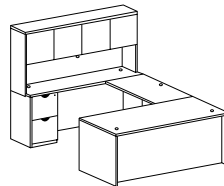

Straight Front U-Shape set
71"x108"
UTYP21
35.2 cu.ft. - 620 lbs.
Consists of: OFD-101, 170,
143, 144, 4DW, 175, 166
List \$2,390

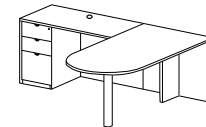

Bullet L-Shape
84"x71"
UTYP27
17.7 cu.ft. - 307 lbs.
Consists of: OFD-147, 145,
166
List \$1,085

UTYP14

List \$1,940



Espresso
OFD-147 Bullet Desk 71"x36"
OFD-170 Bridge 48"x24"
OFD-143 Credenza Shell 71"x24"
OFD-166 Box/Box/File Ped
OFD-144 Overhead Hutch
OFD-4DW 4-Door Laminate Kit

UTYP19

List \$1,600



Cherry
OFD-169 Reception Desk Shell 71"x30"
OFD-180 Reception Return Shell 42"x24"
OFD-107 Hanging Ped (2 qty.)

(All Ultra hutches do not include tackboard.)

CHE = Cherry MAH = Mahogany ESP = Espresso WAL = Walnut Strand

*Measurements are rounded to the nearest inch. For exact dimensions, please call.

Ultra Laminate Series

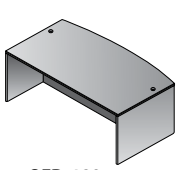

OFD-189
71"x41"x29"
Bow Desk Shell
List \$465

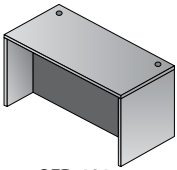

OFD-101
71"x36"x29"
Desk Shell
List \$430

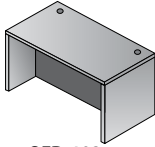

OFD-102
66"x30"x29"
Desk Shell
List \$400

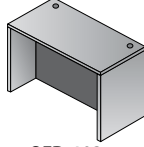

OFD-103
60"x30"x29"
Desk Shell
List \$305

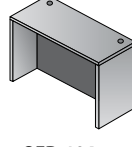

OFD-104
48"x24"x29"
Desk Shell
List \$265

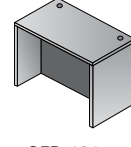

OFD-121
48"x30"x29"
Desk Shell
List \$285

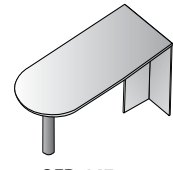

OFD-147
71"x36"x29"
Bullet
List \$400

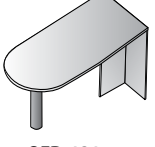

OFD-131
66"x30"x29"
Bullet
List \$350

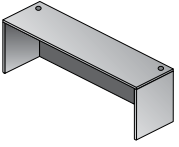

OFD-143
71"x24"x29"
Credenza Shell
List \$335

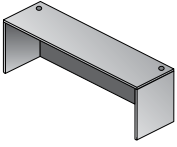

OFD-111
66"x24"x29"
Credenza Shell
List \$300

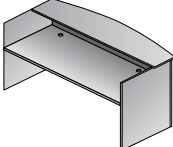

OFD-169
71"x30"/36"x42"
Reception Desk Shell
List \$680

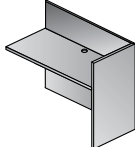

OFD-180
42"x24"x41"
Reception Return Shell
List \$310

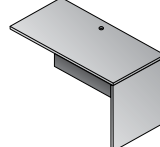

OFD-145
48"x24"x29"
Return Shell
List \$265

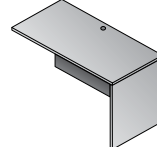

OFD-146
41"x24"x29"
Return Shell
List \$235

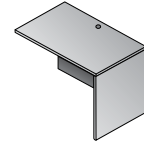

OFD-179
30"x24"x29"
Return Shell
List \$195

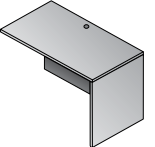

OFD-192
36"x24"x29"
Return Shell
List \$210

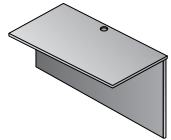

OFD-170
48"x24"x29"
Bridge
List \$210

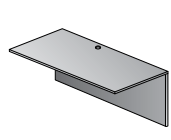

OFD-172
41"x24"x29"
Bridge
List \$195

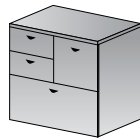

OFD-114
31"x22"x29"
Combo File
Ships Assembled
List \$695



OFD-166
15"x22"x28"
BBF Ped-Desk
Ships Assembled
List \$420

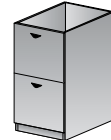

OFD-175
15"x22"x28"
FF Ped-Desk
Ships Assembled
List \$420

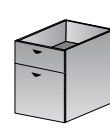

OFD-107
15"x18.5"x21"
Hanging Ped
Ships Assembled
List \$305

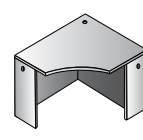

OFD-184
36"x36"x29"
Corner Unit
List \$390

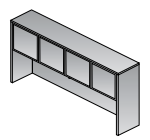

OFD-140
66"x15"x36"
Overhead Storage
w/Laminate Doors
List \$510

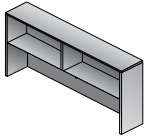

OFD-144
71"x15"x36"
Open Overhead
Hutch
List \$445

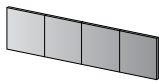

OFD-4DW
4-Door Laminate Kit
for Open Overhead
List \$130

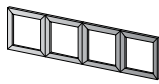

OFD-4DG
4-Door Glass Kit
for Open Overhead
List \$420

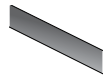

OFD-TACK63
Black Fabric Tackboard
for OFD-140 Overhead
List \$235

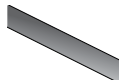

OFD-TACK67
Black Fabric Tackboard
for OFD-144 Overhead
List \$240



OFD-LED.20
Task Light
for Overhead/Shelf
List \$240

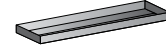

OFD-LED.38
Task Light
for Overhead/Shelf
List \$270

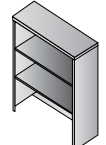

OFD-163
36"x14"x35"
Open Hutch
List \$275

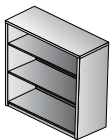

OFD-155
35.4"x14"x42"
3-Shelf Bookcase
List \$290

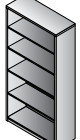

OFD-156
35.4"x14"x65"
5-Shelf Bookcase
List \$400

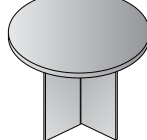

OFD-123
47" Dia. x29"H
Round Table
List \$405

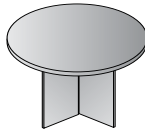

OFD-127
42" Dia. x29"H
Round Table
List \$380

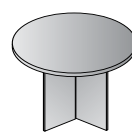

OFD-128
36" Dia. x29"H
Round Table
List \$345

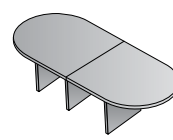

OFD-138T
144"x48"x29"
Conference Table
List \$1,450

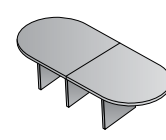

OFD-137T
120"x48"x29"
Conference Table
List \$995

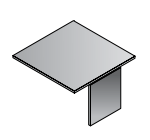

OFD-13738EXT
48"x48"x29"
Conference Table
Extension (for OFD-137
and OFD-138)
List \$500

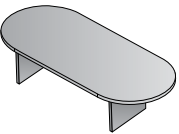

OFD-136
95"x44"x29"
Conference Table
List \$635

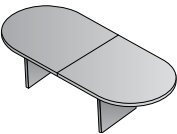

OFD-136-2
95"x44"x29"
2 Piece Conference Table
List \$635

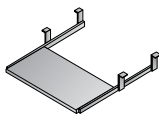

OFD-14
26"x12.75"
Keyboard Tray
List \$100

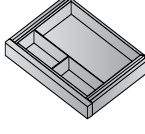

OFD-185
20"x15"
Center Drawer
List \$100

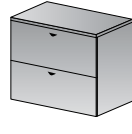

OFD-112
36"x22"x29"
Lateral File
List \$685

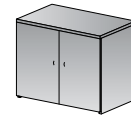

OFD-113
35.5"x22"x29"
2-Door Cabinet
List \$390



OFD-187
36"x22"x57"
4-Drawer Lateral
List \$1,200



OFD-207
24"x24"x65"
Wardrobe Cabinet
List \$1,075

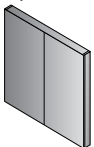

OFD-100
47.5" x 47.5"
Visual Board
List \$610

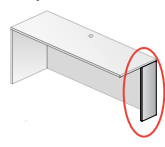

OFD-243LEG
28"x11"
Half Leg for Credenza/
Return Shell (LEG ONLY)
List \$85



UN401L-450C
Lock Core
and Keys
List \$25

CHE = Cherry MAH = Mahogany ESP = Espresso WAL = Walnut Strand



Connect it Series

Connect it is a new look for the workplace that combines functionality with a contemporary style. This is a desking/benching system that can be used free standing or combined with our new segmented panel system. Free design and space planning available.

The typical shown above provides a functional work area complete with segmented panels and power capability, drop down storage credenzas and lateral files as well as mobile pedestals with cushions to compliment the overall design. Glass and acrylic screens, high pressure laminate work surfaces and fabric cushions are available with several choices. Metal tiles for panels, storage units and pedestals are all metal and available in white or brushed silver.

Get connected with



Connect it | Typical Workstations

OFD-CITYP14

2-Pod Workstation
6'x6' each Station
Includes Lateral Files with Cushions, Mobile Pedestals with Cushions, Screens and Panels
List \$9,087
Optional Power Available.

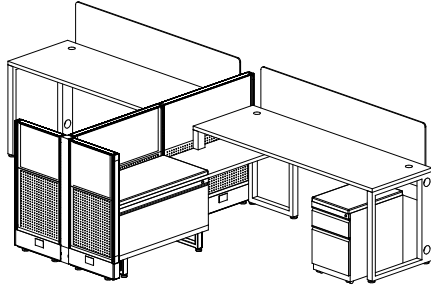

OFD-CITYP1

Level Station 24"x60" Main,
24"x48" Return
5'x6'
Includes BBF Pedestal
List \$1,230

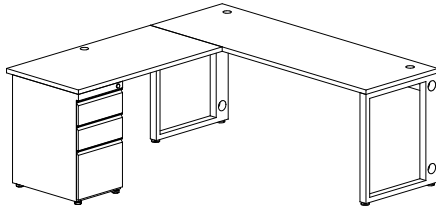

OFD-CITYP2

Level Station 24"x66" Main,
24"x48" Return
5.5'x6'
Includes BBF Pedestal
List \$1,325

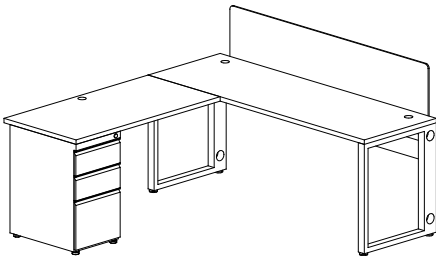

OFD-CITYP3

Level Station 24"x72" Main,
24"x48" Return
6'x6'
Includes BBF Pedestal
List \$1,335

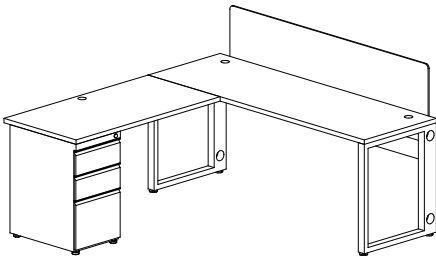

OFD-CITYP7

Level Station 24"x72" Main
with Screen, 24"x48" Return
6'x6'
Includes BBF Pedestal and Screen
List \$1,800

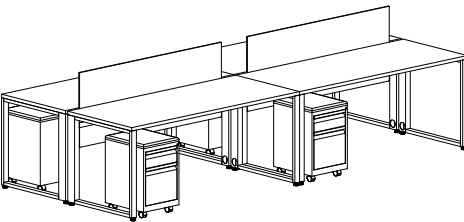

OFD-CITYP11

4-Pod Benching Workstation
Includes Mobile Pedestals
with Cushions, and Screens
List \$6,894

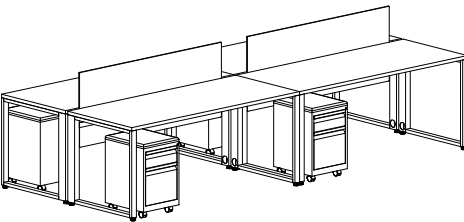

OFD-CITYP13

4-Pod Benching Workstation
Includes Screens
List \$2,720

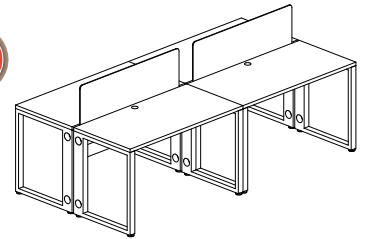

OFD-CITYP24

Level Station 30"x60" Main,
24"x42" Return
5'x6'
Includes BBF Ped and FF Ped
List \$1,688

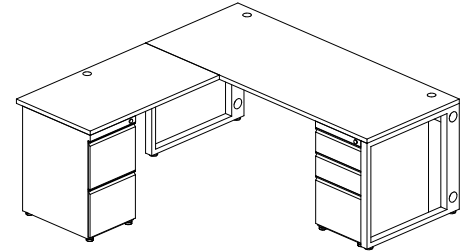

OFD-CITYP25

Level Station 30"x66" Main,
24"x42" Return
5.5'x6'
Includes BBF Ped and FF Ped
List \$1,738

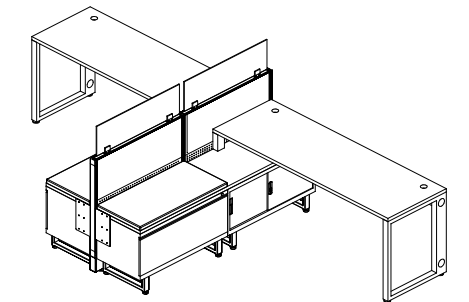

OFD-CITYP26

Level Station 30"x72" Main,
24"x42" Return
6'x6'
Includes BBF Ped and FF Ped
List \$1,748

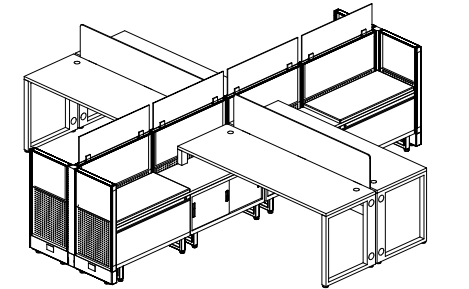

OFD-CITYP8

2-Pod Workstation
6'x6' each Station
Includes Lateral Files with Cushions, Storage Credenzas, Screens and Panels
List \$7,127
Optional Power Available.

OFD-CITYP27

4-Pod Workstation
6'x6' each Station
Includes Lateral Files with Cushions, Storage Credenzas, Screens and Panels
List \$16,857
Optional Power Available.

All screens, glass or acrylic, are optional. Wire management troughs included with work surfaces.
All electric options available, please call for specification and pricing.



Connect it | Typical Workstations

OFD-CITYP18
4-Pod Workstation
 6'x6' each Station
 Includes Lateral Files with
 Cushions and Screens
List \$9,360

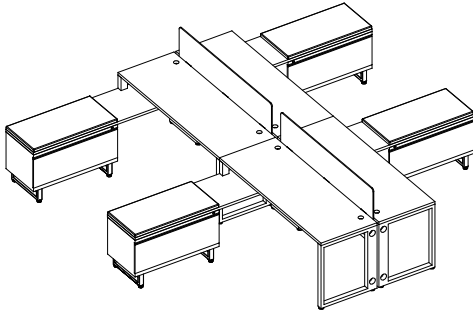

OFD-CITYP19
3-Pod Workstation
 120 Degree each Station
 Includes Box/File Peds with
 Cushions and Screens
List \$6,384

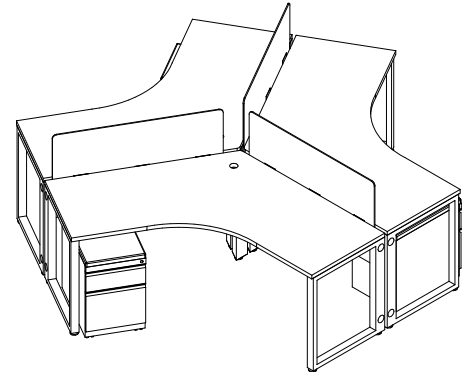

OFD-CITYP17
Cube Workstation
 6'x6' Station
 Includes Panels, Screens and
 BBF Ped.
List \$6,187

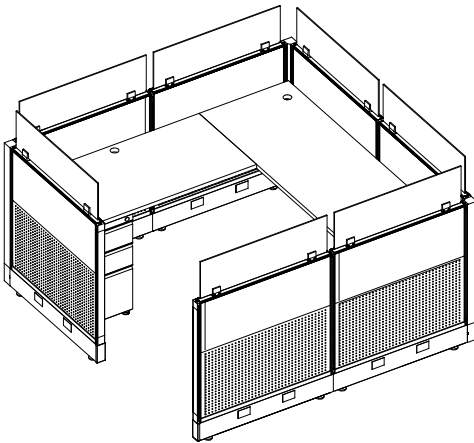

OFD-CITYP15
Executive U-Set
 36"x72" Main
 Includes BBF and FF Ped
List \$2,561

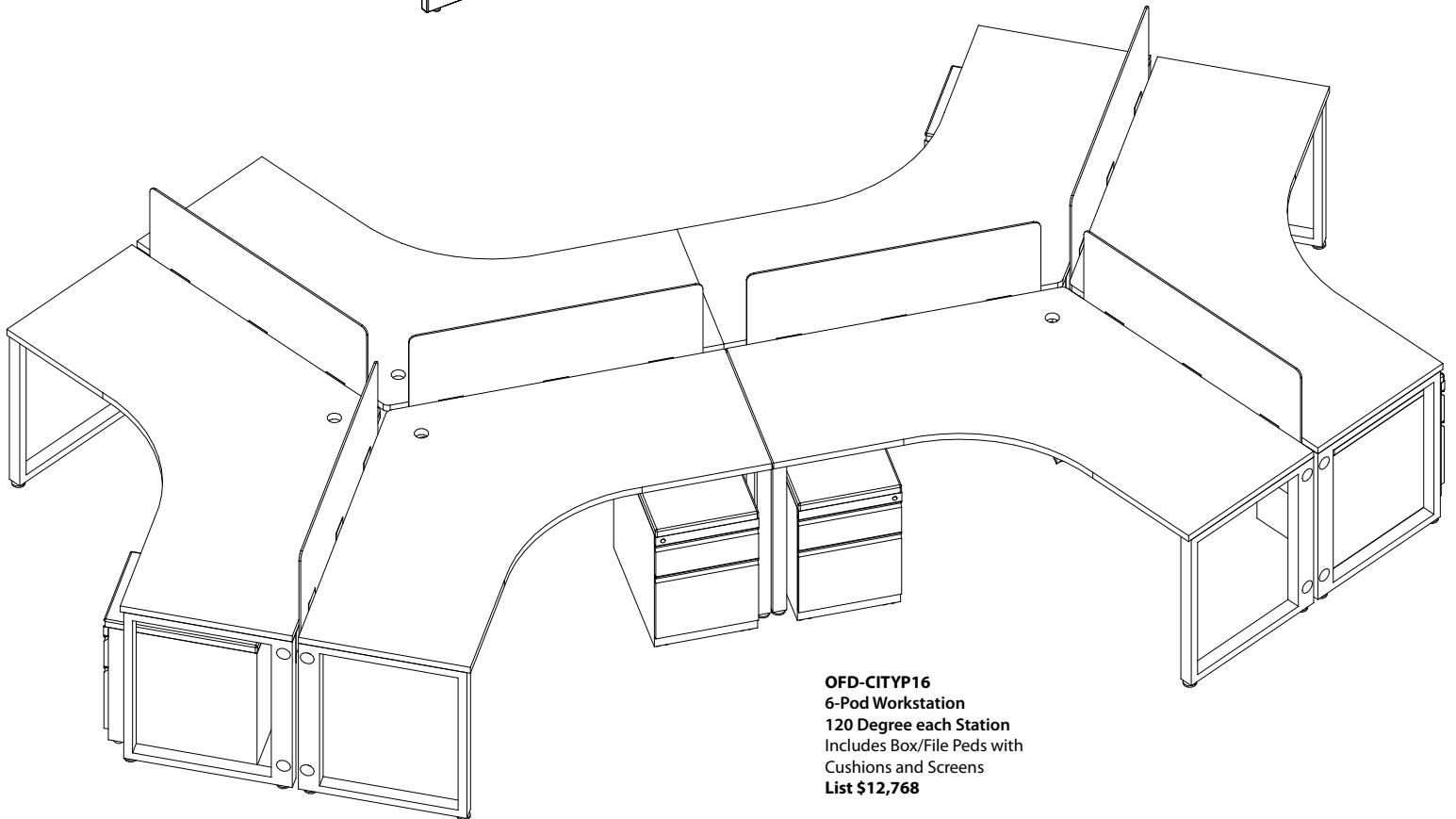
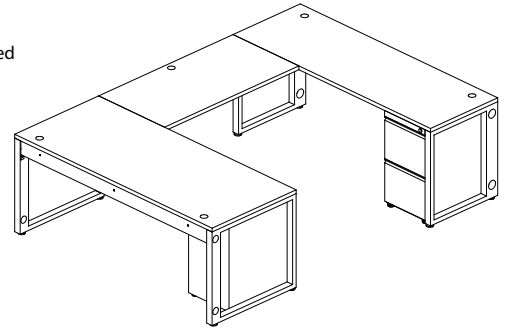

OFD-CITYP16
6-Pod Workstation
 120 Degree each Station
 Includes Box/File Peds with
 Cushions and Screens
List \$12,768

Connect it Series

Rectangle Work Surfaces - HPL

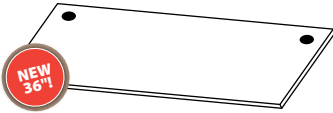

- OFD-CI7236WS - 72"x36" with Wire Mgt Trough, 2 1/4" Grommet Holes..... List \$464
- OFD-CI7224WS - 72"x24" with Wire Mgt Trough, 2 1/4" Grommet Holes..... List \$445
- OFD-CI7230WS - 72"x30" with Wire Mgt Trough, 2 1/4" Grommet Holes..... List \$450
- OFD-CI6624WS - 66"x24" with Wire Mgt Trough, 2 1/4" Grommet Holes..... List \$435
- OFD-CI6630WS - 66"x30" with Wire Mgt Trough, 2 1/4" Grommet Holes..... List \$440
- OFD-CI6024WS - 60"x24" with Wire Mgt Trough, 2 1/4" Grommet Holes..... List \$340
- OFD-CI6030WS - 60"x30" with Wire Mgt Trough, 2 1/4" Grommet Holes..... List \$390

120° Work Surface - HPL

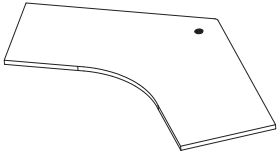

- OFD-CI1202448WS - 120° 24"x48"x48"x24" with (2) Wire Mgt Troughs..... List \$730

Rectangle Work Surfaces for Drop Down Storage - HPL

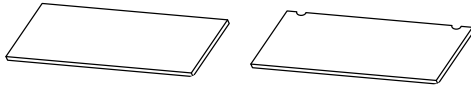

- OFD-CI7218WS - Work Surface for Drop Down 72"x18" List \$269
- OFD-CI7219WS - Work Surface, (2) Half Grommets for Drop Down 72"x19".... List \$280

Panel Frames

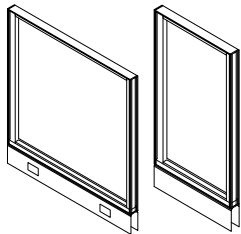

- OFD-CI3936N
Panel Frame 36"x39",
Black Raceway Covers
List \$268
- OFD-CI3918N
Panel Frame 18"x39",
Black Raceway Covers
List \$227
- OFD-CI3936E
Panel Frame with
Power 36"x39", Black
Raceway Covers
List \$379

Panel Tiles

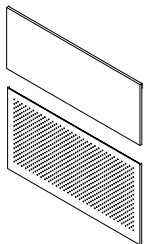

- OFD-CIMT3614-BS
Metal Tile 36"x14",
Brushed Silver
List \$59
- OFD-CIMP3618-BS
Metal Perforated Tile
for Lower 36"x18",
Brushed Silver
List \$82
- OFD-CIMT1814-BS
Metal Tile 18"x14",
Brushed Silver
List \$39
- OFD-CIMP1818-BS
Metal Perforated Tile
for Lower 18"x18",
Brushed Silver
List \$47
- OFD-CIMGB3614-FG
Marker/Magnetic
Glass Tile 36"x14", (Fits
Top Tile on 36" Panel)
White
List \$280
- OFD-CIMT3614-WH
Metal Tile 36"x14",
White
List \$59
- OFD-CIMP3618-WH
Metal Perforated Tile
for Lower 36"x18",
White
List \$82
- OFD-CIMT1814-WH
Metal Tile 18"x14",
White
List \$39
- OFD-CIMP1818-WH
Metal Perforated Tile
for Lower 18"x18",
White
List \$47

Rectangle Return Work Surfaces - HPL

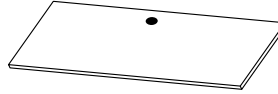

- OFD-CI4824WS - Return Work Surface 48"x24" with 2 1/4" Grommet Hole..... List \$225
- OFD-CI4224WS - Return Work Surface 42"x24" with 2 1/4" Grommet Hole..... List \$220

Support Leg

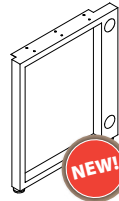

- OFD-CIOLEG24L - Support Leg 24" Left, Brushed Silver List \$140
- OFD-CIOLEG24R - Support Leg 24" Right, Brushed Silver List \$140
- OFD-CIOLEG30L - Support Leg 30" Left, Brushed Silver List \$154
- OFD-CIOLEG30R - Support Leg 30" Right, Brushed Silver List \$154
- OFD-CIOLEG36L - Support Leg 36" Left, Brushed Silver List \$180
- OFD-CIOLEG36R - Support Leg 36" Right, Brushed Silver List \$180

Drop Down Work Surface Support



- OFD-CILWS - Drop Down Work Surface Support, Brushed Silver List \$57

Triangle Leg Support



- OFD-CITL120 - Triangle Leg for 120° Top, Brushed Silver..... List \$72

Acrylic Privacy/Modesty Screens

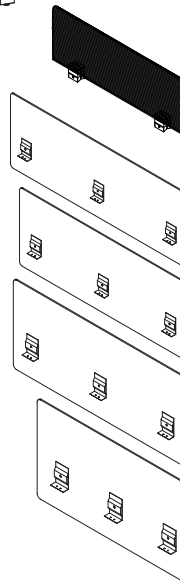

- OFD-CISGFG
Frosted Glass Privacy
Screen for 36"x10"
Panel with Brackets
List \$129
- OFD-CISGCG
Clear Glass Privacy
Screen for 36"x10"
Panel with Brackets
List \$119
- OFD-CISCREEN72
Acrylic Privacy/Modesty
Screen for 72" Work
Surface, 24"H
List \$465
- OFD-CISCREEN48
Acrylic Privacy/Modesty
Screen for 48" Work
Surface, 24"H
List \$420
- OFD-CISCREEN66
Acrylic Privacy/Modesty
Screen for 66" Work
Surface, 24"H
List \$450
- OFD-CISCREEN60
Acrylic Privacy/Modesty
Screen for 60" Work
Surface, 24"H
List \$433

Privacy/Modesty Screens

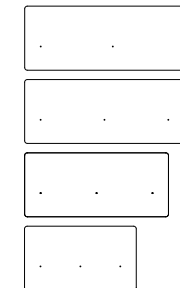

- OFD-CISCREEN72-100
Privacy/Modesty Screen,
White Sea Board for 72"
Work Surface, 24"H
List \$295
- OFD-CISCREEN72-200
Privacy/Modesty Screen,
Silver/Gray Sea Board for
72" Work Surface, 24"H
List \$295
- OFD-CISCREEN66-100
Privacy/Modesty Screen,
White Sea Board for 66"
Work Surface, 24"H
List \$280
- OFD-CISCREEN66-200
Privacy/Modesty Screen,
Silver/Gray Sea Board for
66" Work Surface, 24"H
List \$280
- OFD-CISCREEN60-100
Privacy/Modesty Screen,
White Sea Board for 60"
Work Surface, 24"H
List \$260
- OFD-CISCREEN60-200
Privacy/Modesty Screen,
Silver/Gray Sea Board for
60" Work Surface, 24"H
List \$260
- OFD-CISCREEN48-100
Privacy/Modesty Screen,
White Sea Board for 48"
Work Surface, 24"H
List \$220
- OFD-CISCREEN48-200
Privacy/Modesty Screen,
Silver/Gray Sea Board for
48" Work Surface, 24"H
List \$220

Connect it Series

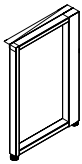

Half Leg

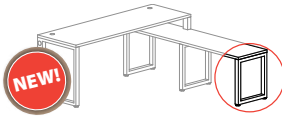

- OFD-CIHALFLEG18-BS - 18" Half Leg, Brushed Silver List \$95
- OFD-CIHALFLEG18-WH - 18" Half Leg, White List \$95

Pedestals

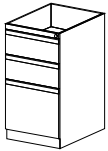

OFD-BBF-BS
Box/Box/File
Pedestal 27.5"H,
Brushed Silver
List \$385

OFD-BBF-WH
Box/Box/File
Pedestal 27.5"H,
White
List \$385

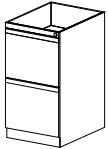

OFD-FF-BS
File/File Pedestal
27.5"H, Brushed Silver
List \$385

OFD-FF-WH
File/File Pedestal
27.5"H, White
List \$385

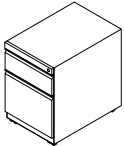

OFD-CIBF-BS
Mobile Pedestal 22"H
Box/File, Brushed
Silver
List \$468

OFD-CIBF-WH
Mobile Pedestal 22"H
Box/File, White
List \$468

Credenzas/Laterals

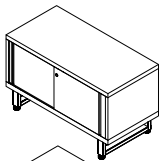

OFD-CID00R36-BS
36" Sliding Door
Credenza, Brushed
Silver
List \$655

OFD-CID00R36-WH
36" Sliding Door
Credenza, White
List \$655

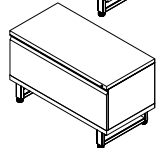

OFD-CILF36-BS
36" Single Drawer
Lateral File, Brushed
Silver
List \$800

OFD-CILF36-WH
36" Single Drawer
Lateral File, White
List \$800



OFD-CIPMSB-BS
Panel Mount Support
Bracket, Brushed
Silver
List \$23

OFD-CIPMSB-WH
Panel Mount Support
Bracket, White
List \$23

Cushions



- OFD-CICUSHBF - Cushion Top for Mobile B/F Pedestal List \$298
- OFD-CICUSHLAT36 - Cushion Top for Lateral/Storage List \$419

Conference O-Leg

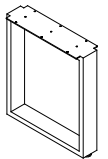

- OFD-CICONFOLEG24 - Conf O-Leg 24", Brushed Silver List \$225ea

Conference Tables - 1 1/2" HPL

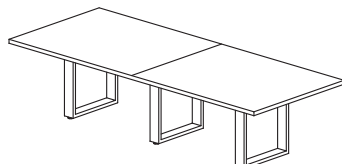
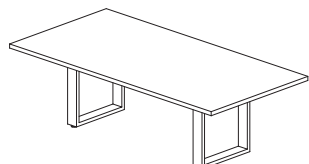

- OFD-CI44192CONF - 44"x192" Conf Table Top, Includes (5) 24" Legs List \$3,145
- OFD-CI44168CONF - 44"x168" Conf Table Top, Includes (5) 24" Legs List \$2,945
- OFD-CI44144CONF - 44"x144" Conf Table Top, Includes (3) 24" Legs List \$2,295
- OFD-CI44120CONF - 44"x120" Conf Table Top, Includes (3) 24" Legs List \$1,895
- OFD-CI4496CONF - 44"x96" Conf Table Top, Includes (2) 24" Legs List \$1,350

Receptacles



- OFD-CIRECP1 - Receptacle #1 List \$25
- OFD-CIRECP2 - Receptacle #2 List \$25
- OFD-CIRECP3 - Receptacle #3 List \$25
- OFD-CIRECP4 - Receptacle #4 List \$25

Draw Rods



- OFD-CIDR34-BU - Draw Rod for Panels, Black List \$21

Connectors

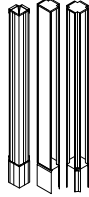

- OFD-CI2W39-BS - 2 Way 39" Connector 90°, Brushed Silver List \$100
- OFD-CI3W39-BS - 3 Way 39" Connector 90°, Brushed Silver List \$120
- OFD-CI4W39-BS - 4 Way 39" Connector 90°, Brushed Silver List \$136

Pass Through Cable



- OFD-CIPTP-2 - Panel to Panel Long Electric Festoon (Jumper) List \$73

Base Power Feed



- OFD-CIBASEIN-L - Base Power Feed from Left List \$278
- OFD-CIBASEIN-R - Base Power Feed from Right List \$278

Finished End Trim



- OFD-CIFE34-BS - Finished End Trim for 39" Panel, Brushed Silver.. List \$43



Power Block



- OFD-CIBLOCK-BLK - Single Sided Pwr Block, Black List \$121

Flat Mounting Bracket



- OFD-CI78MB - Used for 8-Wire Double Sided Blocks List \$8

Single Circuit Power Feed



- OFD-CI8420AP1-72-24 - 20-Amp Standard Plug w/15 Amp Adapter.. List \$227

Jumper Cable For Power Block



- OFD-CI84FF-48 - Desking Pwr Jumper Cable, 48" List \$133
- OFD-CI84FF-60 - Desking Pwr Jumper Cable, 60" List \$147
- OFD-CI84FF-66 - Desking Pwr Jumper Cable, 66" List \$154
- OFD-CI84FF-72 - Desking Pwr Jumper Cable, 72" List \$161
- OFD-CI84FF-90 - Desking Pwr Jumper Cable, 90" List \$183

Base in Feed Starter Cable for Power Block



- OFD-CI84SB2-108 - Base in Feed Starter Cable, 108" List \$189
- OFD-CI84SB2-144 - Base in Feed Starter Cable, 144" List \$232
- OFD-CI84SB2-72 - Base in Feed Starter Cable, 72" List \$146

Duplex Removal Tool for Power Block



- OFD-CI8SR - Duplex Removal Tool List \$6

Desk Mount Power Block

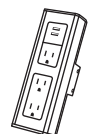

- OFD-CI3USB-WH - Pwr Block w/3 Pwr and 2 USB, Gloss White List \$393
- OFD-CI3USB-BS - Pwr Block w/3 Pwr and 2 USB, Silver Pearl List \$393

Connect it Series - Height Adjustable Tables



Electric Height Adjustable Bases

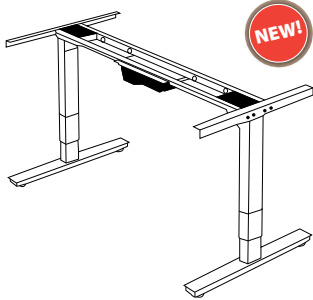

NEW!

OFD-CIEL3BASE-BS Electric Base 27.5"H, Brushed Silver List \$1,400	OFD-CIEL3BASE-WH Electric Base 27.5"H, White List \$1,400
--	---

OFD-CIEL120BASE-BS Electric Base 22"H, Brushed Silver List \$2,200	OFD-CIEL120BASE-WH Electric Base 22"H, White List \$2,200
--	---

Connect It Work Surfaces - HPL, Top Only

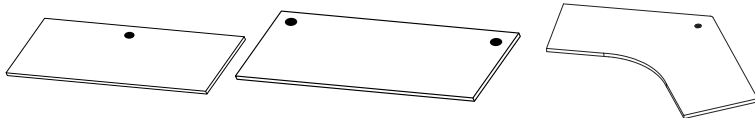

OFD-CI4824TOP - Connect It Work Surface 48"x24" with a 2 1/4" Center Grommet Hole ..	List \$214
OFD-CI6024TOP - Connect It Work Surface 60"x24" with two 2 1/4" Grommet Holes	List \$265
OFD-CI6624TOP - Connect It Work Surface 66"x24" with two 2 1/4" Grommet Holes	List \$355
OFD-CI7224TOP - Connect It Work Surface 72"x24" with two 2 1/4" Grommet Holes	List \$360
OFD-CI6030TOP - Connect It Work Surface 60"x30" with two 2 1/4" Grommet Holes	List \$315
OFD-CI6630TOP - Connect It Work Surface 66"x30" with two 2 1/4" Grommet Holes	List \$360
OFD-CI7230TOP - Connect It Work Surface 72"x30" with two 2 1/4" Grommet Holes	List \$365
OFD-CI7236TOP - Connect It Work Surface 72"x36" with two 2 1/4" Grommet Holes	List \$385
OFD-CI1202448TOP - 120° 24"x48"x48"x24" with a 2 1/4" Center Grommet Hole	List \$600



Burnt Strand Laminate

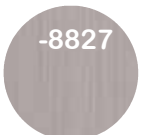

Sarum Twill Laminate

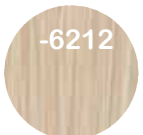

Wheat Strand Laminate



Brite White Laminate



Wenge Strand Laminate

NEW!

Height Range:
With OFD 1.1" Top:
25 1/4" to 49 1/2"
(with glides installed
on base, all the way in)

OFD-CIEL120BASE-WH

OFD-CIEL3BASE-BS

Height Range:
With OFD 1.1" Top: 24 3/4" to
49 1/4" (with glides installed
on base, all the way in)

Height Control

Warranty

- 2-year warranty on the motors
- 5-year warranty on the base

Connect it Series - Height Adjustable Tables

Ultra2 Rectangle Work Surfaces - HPL

Use Ultra2 Program
for Ultra2 Tops

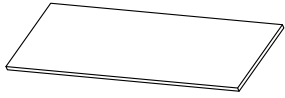

- U2TOP-2448L - Ultra2 Top 48"x24" Sq Edge, Dark Tone 3MM Edge Band List \$326
- U2TOP-2460L - Ultra2 Top 60"x24" Sq Edge, Dark Tone 3MM Edge Band List \$392
- U2TOP-2472L - Ultra2 Top 72"x24" Sq Edge, Dark Tone 3MM Edge Band List \$466



Cloud White
Laminate



Wild Cherry
Laminate



Light Gray
Laminate

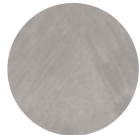

Brushed Nickel
Laminate

Training Table Rectangle Work Surfaces - HPL

Use Training Table Program
for Training Tops

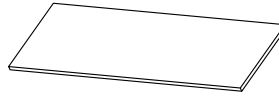

- OFD-TT4824 - Training Table Top 47 $\frac{7}{8}$ "x23 $\frac{3}{8}$ " 3MM Edge Band List \$180
- OFD-TT6024 - Training Table Top 59 $\frac{7}{8}$ "x23 $\frac{3}{8}$ " 3MM Edge Band List \$225
- OFD-TT7224 - Training Table Top 71 $\frac{7}{8}$ "x23 $\frac{3}{8}$ " 3MM Edge Band List \$270



Gray
Laminate



Cherry
Laminate



Mahogany
Laminate



Espresso
Laminate

Manual Height Adjustable Bases with White Tops



OFD-HAT60261-1



White
Laminate

OFD-HAT60241-
Max. Overall Size: 47.25Wx23.5D
Adjusts to 30.25 - 43.25H, White
Frame, White Laminate Top
List \$900

OFD-HAT60251-1
Max. Overall Size: 59Wx23.5D
Adjusts to 30.25 - 43.25H, White
Frame, White Laminate Top
List \$950

OFD-HAT60261-1
Max. Overall Size: 70.75Wx23.5D
Adjusts to 30.25 - 43.25H, White
Frame, White Laminate Top
List \$1,000



OFD-HAT60241-1

Height Control



OFD-CIEL120BASE-WH



OFD-HAT60241-1

connect it.



get it.

24 we stock it.

connect it.



Get connected with



connect it.



we stock it. 25

Connect it | Specifications

Work Surfaces

- High pressure laminates for all work surfaces.
- 1.1" thick work surfaces.
- 3mm coordinating edge banding.
- Grommets included on work surfaces.
- Power/data wire management troughs included.
- In stock colors are Brite White, Burnt Strand, Sarum Twill, Wenge Strand, and Wheat Strand.

Storage

- Storage units are all metal providing stability and durability.
- Storage units are 36"W and include a single drawer lateral file unit or a sliding door credenza unit. These units can be mixed and matched.
- All storage units have locking capabilities.
- All storage units are available in white or brushed silver.
- Drop down storage units require a laminate top of your choice.

Pedestals

- Mobile pedestals are 22"H Box/File.
- Free standing full pedes are available as Box/Box/File or File/File 27.5"H.
- All pedestals are available in white or brushed silver.

Cushions

- Cushions are available for mobile pedestals as well as drop down storage units.
- Pedestal cushion size is 22"x15".
- Drop down storage unit cushion size is 36"x18".
- In stock colors are Gaia, Mystic, Autumn, Black, Rain and Theater.

Panels

- All connect it panels are 36"Wx39"H, available with or without power.
- Frames and top caps are all brushed silver with all metal tiles available in white and brushed silver.
- Tiles are perforated on the bottom tile 18"H with a solid metal tile on top 14"H, white or brushed silver.
- Raceways are black and are flush with the panel.
- New 14"W x 39"H wing panels – non-powered only.

Privacy/Modesty Screens

- Privacy/Modesty screens can be added in ¼" acrylic.
- Privacy/Modesty screens are 24"H.
- In stock colors are Frosted Green Acrylic, Frosted Red Acrylic, Frosted Purple Acrylic, Frosted Orange Acrylic, and Frosted Lime Green Acrylic.
- In stock options include Sea Board in Silver Gray and White.
- Glass privacy screens are available in ¼" clear or frosted glass. These can easily be added to 36" panels.
- Glass privacy screens are 35"Wx10"H.
- Brushed silver brackets included with glass screens.

Electrical

- All electric options available, please call our design department for specification and pricing.

Conference Tables!



Great Style!



In Stock Options

Work Surface Laminate Choices

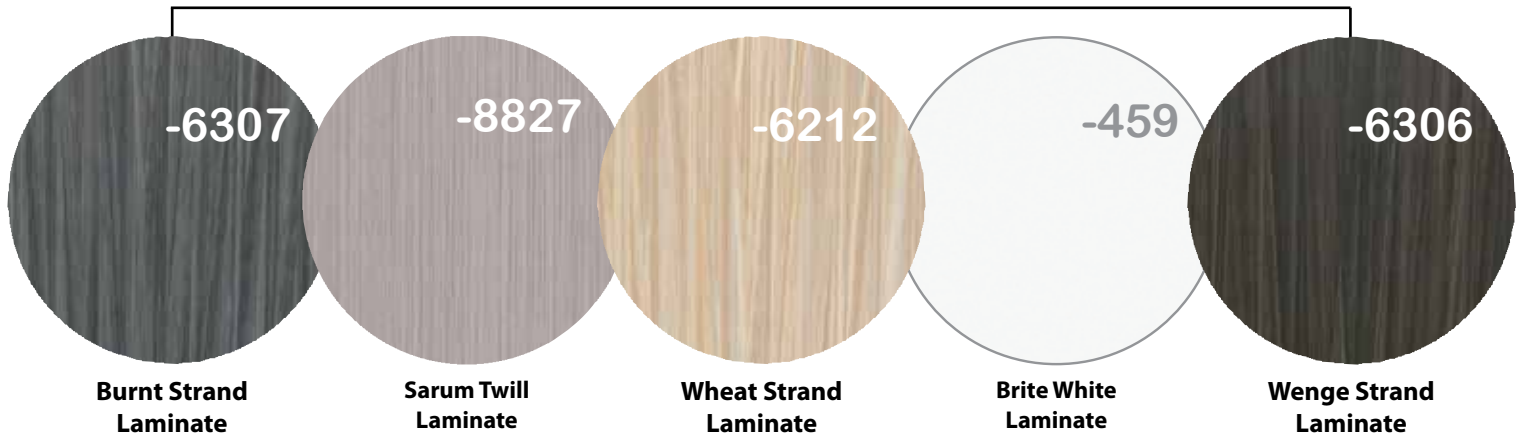

Acrylic Screens

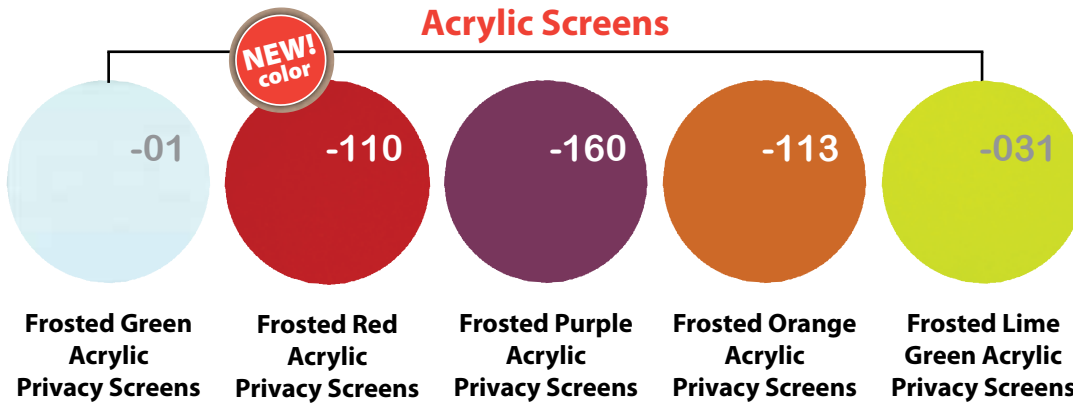

Privacy Screens



Cushions/Fabric



Paint

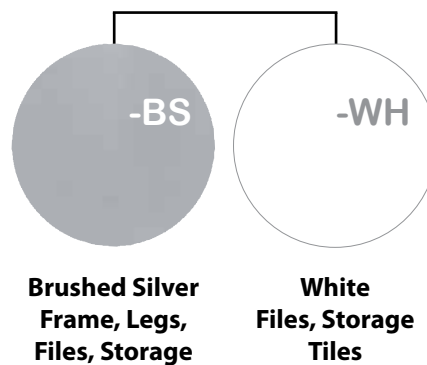



5200W-
List \$525
 Choose a fabric

space it.

Mesh Fabric Seat and Back
 (-7) Blue
 White Coated Nylon Base

317W-W11C1F2W
List \$795

space it.

White Breathable Mesh Seat and Back
 White Coated Nylon Base

Side View Arms Down

317W-W1C1F2W-
List \$750
 Choose a fabric

space it.

White Breathable Mesh Back
 (-512) Purple Mesh Fabric Seat
 White Coated Nylon Base

- One touch pneumatic seat height adjustment
- 2-to-1 synchro tilt control
- Height adjustable flip arms
- Tilt tension
- Tilt Lock

All items on this page have achieved GREENGUARD Certification.

Height Adjustable Flip Arm!

317-6C61F6-

List \$695

Choose a fabric below

space it.



317-ME36C61F6

List \$675

space it.



317-66C61F6

List \$695

space it.



- One touch pneumatic seat height adjustment
- 2-to-1 synchro tilt control
- 4-Way adjustable flip arms
- Adjustable lumbar support
- Adjustable tilt tension
- Tilt tension
- Tilt lock

MI-8810W-

White Frame

List \$290

Choose a fabric below
(7-10 day lead time)

space it.

(-7) Blue Mesh Fabric Seat

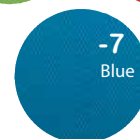
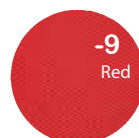
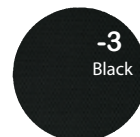

SPACE SEATING

30 we stock it.

Height Adjustable
Flip Arm!



529-R22N1F2

List \$550

SpaceGrid® Back
and Seat

Black
Nylon Base



529-E3R2N1F2

List \$500

Black
Nylon Base

SpaceGrid® Back
and Black Eco
Leather Seat

- One touch pneumatic seat height adjustment
- Adjustable lumbar support
- Height adjustable flip arms
- 2-to-1 synchro tilt control with tilt lock, and tilt tension control



529-3R2N1F2

List \$500

SpaceGrid®
Back

Black Mesh
Fabric Seat

Black
Nylon Base



Back Detail



All items on
this page
have achieved
GREENGUARD
Certification.



SPACE
SEATING

space it.



space it.

5500
List \$375

Black Mesh Fabric Seat

Dark AIR GRID[®] Back

Black Nylon Base

Back Detail

space it.

5500-
List \$395
Choose a fabric

Mesh Fabric Seat (-9) Red

Dark AIR GRID[®] Back

Black Nylon Base

FUN COLORS FABRIC PROGRAM



- One touch pneumatic seat height adjustment
- Adjustable arms
- 2-to-1 synchro tilt control
- Tilt tension
- Tilt lock

GREENGUARD
All items on this page have achieved GREENGUARD Certification.

SPACE[®]
SEATING

32 we stock it.

space it.



5700E
List \$385

Dark AIR GRID Back

(E) Black Eco Leather Seat Black Nylon Base

space it.



5505-
List \$360

Dark AIR GRID Back

Fixed Angled Arms

(-18) Orange Mesh Fabric Seat

Sled Base

NEW!

Choose a fabric below (7-10 day lead time)

- 3 Black
- 6 Green
- 512 Purple
- 7 Blue
- 9 Red
- 18 Orange

FUN COLORS FABRIC PROGRAM

space it.



5505
List \$340

Dark AIR GRID Back

Fixed Angled Arms

Black Mesh Fabric Seat

Sled Base



Side View

- One touch pneumatic seat height adjustment
- Adjustable arms
- 2-to-1 synchro tilt control
- Tilt tension
- Tilt lock

space it.



2300
List \$615

Black Breathable Mesh Back

Gunmetal Base

Black Mesh Fabric Seat

Adjustable lumbar support



Back Detail

get it.

All items on this page have achieved GREENGUARD Certification.



SPACE SEATING

335-E37P918P

List \$695

space it.

Black Eco
Leather
Trim and
Seat



Dark
AIR GRID
Back

Back
Detail



Polished
Aluminum
Base

- One touch pneumatic seat height adjustment
- 2-to-1 synchro tilt control
- Adjustable arms
- Adjustable lumbar support
 - Tilt tension
 - Tilt lock

5540

List \$500

space it.

Black Mesh
Fabric Seat
and Trim



Black Nylon
Base

Dark
AIR GRID
Back

55403

List \$595

space it.

- Adjustable headrest

Black Nylon
Base



Black Mesh
Fabric Seat
and Trim

Dark
AIR GRID
Back

818-31G9C18P

List \$875

space it.

Black
Breathable
Mesh Back

Gunmetal Base



300
lb
weight limit

Black Mesh
Fabric Seat

- Deluxe 2-to-1 synchro tilt
- Seat slider
- Seat depth adjustment

OS

Back
Detail



All items on this page have achieved GREENGUARD Certification.

SPACE
SEATING

839-11B35WA

List \$975

- Auto adjusting synchro tilt
- Deluxe 2-to-1 synchro tilt
- Anti-kick back



cushion it.

Breathable Mesh Seat and Back



Gunmetal Base

400 lb. weight limit



839-11B35WA

75-37A773

List \$850

- Tilt tension
- Mid pivot knee tilt



cushion it.

Black Mesh Fabric Seat



Gunmetal Base

Dark Double AIR GRID Back

400 lb. weight limit

63-37A773HM

List \$995

- Tilt tension
- Mid pivot knee tilt
- Adjustable headrest



cushion it.

Black Mesh Fabric Seat, Trim, and Headrest



Gunmetal Base

Dark AIR GRID Back

400 lb. weight limit

75-47A773

List \$925

- Tilt tension
- Mid pivot knee tilt



cushion it.

Black Leather Seat



Gunmetal Base

Dark Double AIR GRID Back

400 lb. weight limit

- One touch pneumatic seat height adjustment
- Tilt lock
- 2-way adjustable arms
- Adjustable lumbar support



All items on this page have achieved GREENGUARD Certification.



SPACE SEATING

we stock it. 35

big & tall it.



39200

39200
List \$675
 • Flip arms
 OS

cushion it.

Black Bonded Leather

400 lb. weight limit

Coated Metal Base

NEW!

39203
List \$675
 • Flip arms
 OS

cushion it.

Black Fabric Seat and Back

400 lb. weight limit

Coated Metal Base

Arm Detail

NEW!

39202
List \$675
 • Flip arms
 OS

cushion it.

Charcoal Fabric Seat and Back

400 lb. weight limit

Coated Metal Base

NEW!

EC1283C-EC3
List \$550
 OS

cushion it.

(-EC3) Black Eco Leather

350 lb. weight limit

Chrome Base

Reverse Stitching

- One touch pneumatic seat height adjustment
- Tilt tension
- Tilt lock

SPACE SEATING

36 we stock it.

OS Oversized Seating Item - Check Shipping Program



A15

List \$85
Opt. Height Adjustable Arms
Only for: 13-37N20D



13-37N20D

List \$495



Black Mesh Fabric Seat

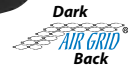

Overall Size 21.25"Wx25.5"Dx51"H

Black Nylon Base

Height Adjustment 27.5" to 32.5"

• Adjustable footring

Big & Tall

15-37A720D

List \$595

• Adjustable footring

raise it.



Black Mesh Fabric Seat



Height Adjustment 28" to 33"

Overall Size 21.5"Wx25.5"Dx54.5"H

Gunmetal Base



A27WA

List \$98

Opt. Height and Width Adjustable Arms
Only for: 15-37A720D

• One touch pneumatic seat height adjustment



213-37N2F3D

List \$600

• 4-way adjustable flip arms

raise it.



Black Mesh Fabric Seat



Overall Size 27.5"Wx23.75"Dx48.25"H

Height Adjustment 20" to 27.5"

Black Nylon Base

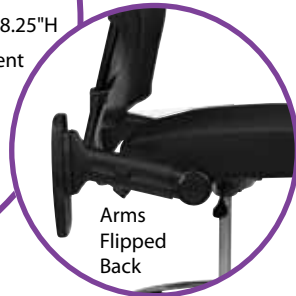

Arms Flipped Back



15-37A720D

DC51000NV

List \$335

raise it.

Breathable Woven Mesh Back

(-V) Black Vinyl Seat

Overall Size
24"Wx21.5"Dx46.25"H

Height Adjustment
19.25" to 26.75"

Black Nylon Base

NEW!



DC51000N-231

List \$335

raise it.

Breathable Woven Mesh Back

(-231) Black Icon Fabric Seat

Overall Size
24"Wx21.5"Dx46.25"H

Height Adjustment
19.25" to 26.75"

Black Nylon Base

NEW!



DC2990-231

Black Fabric Seat

DC2990V

Black Vinyl Seat

List \$310

• Seat depth adjustment

raise it.

Black Breathable Mesh Back

(-231) Black Icon Fabric Seat

Overall Size
26"Wx23"Dx50.25"H

Height Adjustment
24.25" to 33.75"

Black Nylon Base

DC2990V Detail



DC8309C

List \$200

raise it.

Plastic Seat and Back

Overall Size
19.75"Wx22"D
x44"H

Chrome Sled Base

NEW!



• Adjustable footing

• One touch pneumatic seat height adjustment



DC2990-231

Ganging Capabilities!

nest it.



Black Screen Flex Back

Titanium Arms and Legs

(-231) Black Icon Fabric Seat

FC8487-231

List \$275

• Dual wheel carpet casters

nest it.



White Screen Flex Back

Black Armrests

White Finish Frame

(-6) Green Mesh Fabric Seat

848W-3

List \$285

Black Mesh (in stock)

848W-

List \$305

Choose a fabric below (7-10 day lead time)

- 6 Green
- 512 Purple
- 7 Blue
- 9 Red
- 18 Orange

NEW!

nest it.



Ventilated Black Plastic Back

(-30) Coal FreeFlex® Fabric Seat

Titanium Arms and Legs

NI-2000-30

List \$245

nest it.



Ventilated Black Plastic Back

(-30) Coal FreeFlex® Fabric Seat

Titanium Legs

NI-2200-30

List \$225

• Seat folds for horizontal nesting

nest it.



Built-in Lumbar Support

(-30) Coal FreeFlex® Fabric Seat

Titanium Arms and Legs

NI-1000-30

List \$335

Black Pro GRID® Back

nest it.



Built-in Lumbar Support

(-30) Coal FreeFlex® Fabric Seat

Titanium Legs

NI-1200-30

List \$315

Black Pro GRID® Back

All items on this page have achieved GREENGUARD Certification.



Ganging Capabilities!

nest it.

Gray Top



Titanium Base

Overall Size
72"x24"

- NI-84226TG
- Gray
- NI-84226TC
- Cherry
- NI-84226TM
- Mahogany
- NI-84226TE
- Espresso
- List \$910



- 1" Laminate top with impact-resistant PVC Edges
- Single-lever folding



nest it.

Cherry Top



Titanium Base

Overall Size
60"x24"

- NI-84225TG
- Gray
- NI-84225TC
- Cherry
- NI-84225TM
- Mahogany
- NI-84225TE
- Espresso
- List \$820

- Space-saver nesting capability
- Easy-roll, locking carpet casters



nest it.

Mahogany Top



Titanium Base

Overall Size
48"x24"

- NI-84224TG
- Gray
- NI-84224TC
- Cherry
- NI-84224TM
- Mahogany
- NI-84224TE
- Espresso
- List \$730

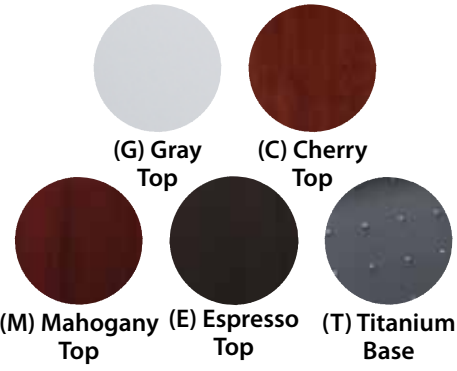

nest it.

Gray Top



Titanium Base

Overall Size
48"x24"

- NI-842HR24TG
- Gray
- NI-842HR24TC
- Cherry
- NI-842HR24TM
- Mahogany
- NI-842HR24TE
- Espresso
- List \$650

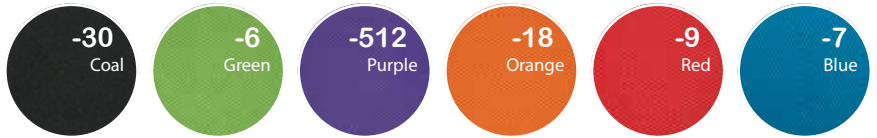

mesh it.

MI-2102-30

List \$425
Coal FreeFlex® Fabric

Black Nylon Base

Black Pro GRID® Back

FUN COLORS FABRIC PROGRAM

(-9) Red Mesh Fabric Seat

NEW!

MI-2102-

List \$464

Choose a fabric

- 3-position locking 2-to-1 Synchro tilt
- Tilt tension
- Tilt lock
- Fixed back

mesh it.

MI-2502-30

List \$460
Coal FreeFlex® Fabric

Black Nylon Base

Black Pro GRID® Back

FUN COLORS FABRIC PROGRAM

(-6) Green Mesh Fabric Seat

NEW!

MI-2502-

List \$499

Choose a fabric

- Multi-function control
- Fixed back

mesh it.

MI-97728-EC3

List \$595

Titanium Base

Black Pro GRID® Back

(-EC3) Black Eco Leather Seat

- Synchro tilt control with infinite lock
- Tilt tension
- Tilt lock
- OS
- One touch pneumatic seat height adjustment
- 3-Way adjustable arms
- Seat depth adjustment
- Seat slider

mesh it.

MI-97720-30

List \$575

(-30) Coal FreeFlex® Fabric Seat

Titanium Base

Black Pro GRID® Back

- Synchro tilt control with infinite lock
- Tilt tension
- Tilt lock
- OS



mesh it.

MI-93720

List \$650

Titanium Base

Black Pro GRID® Seat and Back

- Synchro tilt control with infinite lock
- Tilt tension
- Tilt lock
- OS



OFD-MIHR108M

List \$65

Opt. Headrest Only for:
MI-2102,
MI-2502,
MI-97728-EC3,
MI-97720-30,
MI-93720

NEW!



OFD-MIHR109F

List \$85

Opt. Headrest Only for:
MI-2102,
MI-2502,
MI-97728-EC3,
MI-97720-30,
MI-93720

NEW!

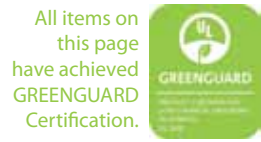

mesh it.



Black Nylon Base

Black Pro GRID[®] Back

FUN COLORS FABRIC PROGRAM

(-7) Blue Mesh Fabric Seat

NEW!

MI-1122-30

List \$379
Coal FreeFlex[®] Fabric

MI-1122-

List \$418
Choose a fabric
• 2-to-1 Synchro tilt
• 2-way adjustable arms

• One touch pneumatic seat height adjustment



mesh it.



Black Nylon Base

Black Pro GRID[®] Back

FUN COLORS FABRIC PROGRAM

(-18) Orange Mesh Fabric Seat

NEW!

MI-1522-30

List \$450
Coal FreeFlex[®] Fabric

MI-1522-

List \$489
Choose a fabric
• Multi-function control
• 3-way adjustable arms

mesh it.



(-30) Coal FreeFlex[®] Fabric Seat

Titanium Frame

Black Pro GRID[®] Back

MI-1500-30

List \$290

• Seat slider
• Ratchet back



Stacking Detail



mesh it.



Black Mesh Fabric Seat

Breathable Mesh Back

Black Nylon Base

MI-95893

List \$475
• Multi Function Control
• 4-way adjustable arms

mesh it.



Titanium Frame

(-30) Coal FreeFlex[®] Fabric Seat

Black Pro GRID[®] Back

85670-30

List \$250



Back Detail



mesh it.



Titanium Frame

(-30) Coal FreeFlex[®] Fabric Seat

Black Pro GRID[®] Back

85640-30

List \$260





MI-95672-2

List \$525
Gray Fabric (in stock)

MI-95672-

List \$545
Choose a fabric
(7-10 day lead time)

- Deluxe 2-to-1 Synchro tilt
- 2-Way adjustable arms
- Seat depth adjustment
- Tilt tension
- Tilt lock
- Seat slider

- One touch pneumatic seat height adjustment
- Back height adjustment
- Ratchet back



MI-95673
Back Detail



MI-95673-2

List \$500
Gray Fabric (in stock)

MI-95673-

List \$520
Choose a fabric
(7-10 day lead time)

- Deluxe 2-to-1 Synchro tilt
- 2-Way adjustable arms
- Seat depth adjustment
- Tilt tension
- Tilt lock
- Seat slider



MI-8810W-

White Frame
List \$290

Choose a fabric below
(7-10 day lead time)

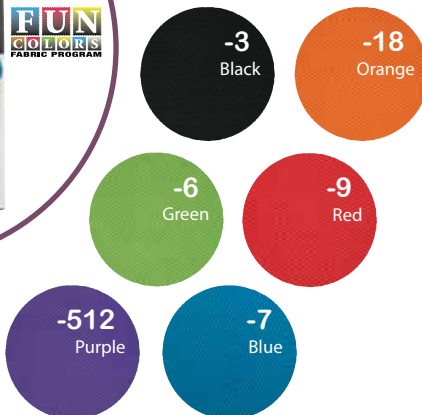

MI-8810W-6
Detail

MI-4102-3

List \$390

- 2-to-1 Synchro tilt
- Tilt lock
- Adjustable tilt tension



- One touch pneumatic seat height adjustment

MI-1800-3

List \$275

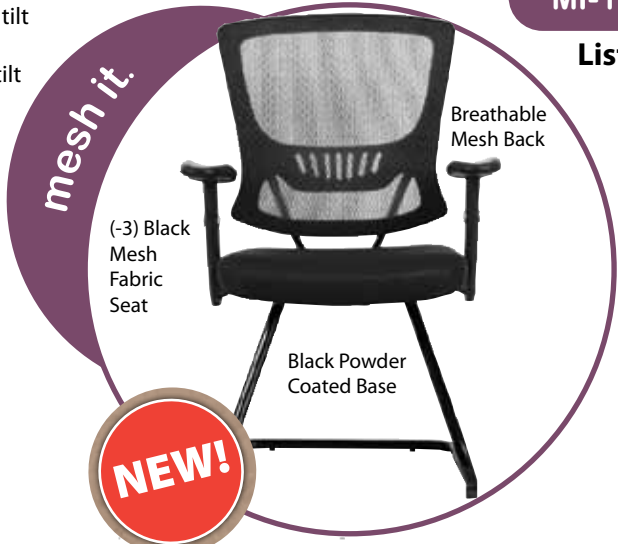

69906-3

List \$370

- 2-to-1 Synchro tilt
- Tilt lock
- Adjustable tilt tension
- Padded flip arms with silver accents

Available April 15

MI-2817

List \$275

- Ratchet back
- Back height adjustment



MI-28174

List \$340

- Adjustable arms
- Ratchet back
- Back height adjustment



EM51022N-3

List \$250
250 lbs. weight limit

- One touch pneumatic seat height adjustment
- Locking tilt control with tilt lock, and tilt tension control

Great Value!

183305

List \$169
200 lbs. weight limit

- 5 Year warranty
- 2 Years on component parts including pneumatic cylinders, control mechanisms, wood, plastic parts, base and casters.
- 1 Year on upholstery fabric and foam against wear and deterioration.
- Leather is not warranted against routine scratching and scuffing, as leather is subject to minor blemishes in use.
- 200 lbs. weight limit.

Recommended for residential use.

screen it.



screen it.



TI-2402-231

List \$475

- Seat slider
- Seat depth adjustment
- 3-position, 2-to-1 synchro tilt control with tilt lock, and tilt tension control



task it.



- One touch pneumatic seat height adjustment
- 2-way adjustable arms

task it.

TI-1102-30

List \$370

- 2-to-1 synchro tilt control with tilt lock, and tilt tension control



leather it.



Black
Nylon Base

(-G1) Espresso
Glove Soft
Leather

Glove Soft
Leather

OFD-6640-B13

Black

OFD-6640-G1

**Espresso
List \$640**

Executive High Back

- Locking tilt control
- Padded arms

- One touch pneumatic seat height adjustment

- Tilt lock
- Tilt tension

leather it.



(-3) Black Leather

Chrome Base

8200-3

Black

7270

**White
List \$695**

High Back

- Mid-pivot knee tilt control



leather it.



White Leather

Chrome Base

7271

White

8201-3

Black

List \$650

Mid Back

- Mid-pivot knee tilt control



leather it.



(-3) Black Leather

Chrome Base

8205-3

Black

7275

**White
List \$595**

Sled Base



All items on this page have achieved GREENGUARD Certification.

manage it.



519117HC-EC3

List \$525
Executive High Back
• 2-to-1 synchro tilt

Chrome Base

Black Mesh Back

(-EC3) Black Eco Leather Seat

NEW!

manage it.



519117MC-EC3

List \$495
Executive Mid Back
• 2-to-1 synchro tilt

Chrome Base

Black Mesh Back

(-EC3) Black Eco Leather Seat

NEW!



518317HA-EC3

- One touch pneumatic seat height adjustment
- Tilt tension
- Tilt lock

518317HA-EC3

List \$540
• 2-to-1 synchro tilt

manage it.



Chrome Base

(-EC3) Black Eco Leather

NEW!



519117HC-EC3

519117MC-EC3



manage it.

Chrome Finish Base

(-U6) Black Faux Leather

FL1327C-

List \$425

Black Faux Leather (in stock)

Fabric below has 7-10 day lead time. OS

-U9 Red Faux Leather

-U11 White Faux Leather

-U28 Cream Faux Leather



FL1327C-U6

• Locking tilt control with tilt tension control



manage it.

Padded Arms

(-U6) Black Faux Leather

Polished Aluminum Base

FL5380C-U6

Black

FL5380C-U11

White

FL5380C-U22

Smoke

List \$450

Executive High Back OS



manage it.

(-U11) White Faux Leather

Padded Arms

Polished Aluminum Base

FL5388C-U11

White

FL5388C-U6

Black

FL5388C-U22

Smoke OS

List \$395

Executive Mid Back

Great style!

• One touch pneumatic seat height adjustment

ECH70537-EC3

List \$450

- Adjustable padded arms

(-EC3) Black Eco Leather

Titanium Base

- Tilt lock
- Tilt tension control

manage it.



NEW!

FL89675-U6

List \$265

Flip Arms

(-U6) Black Faux Leather

Black Nylon Base

Flip Arm!



manage it.



ECH68807-EC3

Black/Titanium
List \$460

Padded Arms

Coated Base with Black End Caps

(-EC3) Black Eco Leather

- One touch pneumatic seat height adjustment

manage it.



FL9097-U6

List \$375

Padded Arms with Polished Aluminum Accents

(-U6) Black Faux Leather

Black Nylon Base with Polished Aluminum Accents

manage it.



ECH83507-EC3

Black/Titanium
List \$450

Coated Base with Black End Caps

(-EC3) Black Eco Leather

manage it.



9333E

List \$685

- 2-to-1 Synchro tilt
- Fixed cantilever arms

Gunmetal Base and Arms

(-E) Black Eco Leather

manage it.



Arm Detail



OFD-605-BLK

List \$249



OFD-6583-EC3

List \$325



OFD-6583-EC10

List \$325



EC6582-EC9

List \$325



OPH61606-EC3

List \$625



- Knee tilt control
- Height adjustable arms

- One touch pneumatic seat height adjustment
- Locking tilt control with tilt lock, and tilt tension control

manage it.



Black Faux Leather

Black Nylon Base

OFD-7000-BLK

Black

OFD-7000-SAD

Saddle

List \$325

Executive High Back



Black has Reverse Stitching

manage it.



Saddle Faux Leather

Black Nylon Base

OFD-7100-BLK

Black

OFD-7100-SAD

Saddle

List \$299

Executive Mid Back

manage it.



Black Faux Leather

OFD-7200-BLK

Black

OFD-7200-SAD

Saddle

List \$265

Guest Chair



Black has Reverse Stitching

- One touch pneumatic seat height adjustment
- Mid-pivot knee tilt control with tilt lock, and tilt tension control

manage it.



(-U6) Black Faux Leather

Black Nylon Base

FL3422-U6

List \$350



Reverse Stitching



FL7480-U6

List \$270

Executive/Conference High Back

manage it.

(-U6) Black Faux Leather

Black Nylon Base



- Padded arm
- Dual wheel carpet casters

- Thick padded seat and back with built-in lumbar support
- Locking tilt control with adjustable tilt tension

FL7481-U6

List \$250

Executive Mid Back

manage it.

(-U6) Black Faux Leather

Black Nylon Base



FL7484-U6

List \$230

Guest Chair

manage it.

(-U6) Black Faux Leather

Black Nylon Base



FL7485-U6

List \$230

Guest Chair

manage it.

(-U6) Black Faux Leather



Great Value!



healthcare it.

OFD-BC9601-

21" Wide

List \$475

Choose an antimicrobial vinyl



300 lb.
weight limit

-R105
Blue

-R104
Buff

• Antimicrobial Vinyl

- Soft PU arm pads
- Sturdy metal frame with metal back bar re-enforcement
- Matching frame - allows for gangability from the bottom of the legs.

healthcare it.

OFD-BC9602-

26" Wide

List \$525

Choose an antimicrobial vinyl OS



400 lb.
weight limit

-R105
Blue

-R104
Buff

• Replacement seats and backs are available. Please call customer service for details.



healthcare it.

OFD-BC9603-

30" Wide

List \$575

Choose an antimicrobial vinyl OS



500 lb.
weight limit

-R105
Blue

-R104
Buff

These antimicrobial vinyl also available. Please allow 7-14 business days.

-R100
Lipstick

-R101
Snow

-R102
Java

-R103
Stratus

-R106
Sage

-R107
Black

All items on this page have achieved GREENGUARD Certification.





SL9802-EC3

SL9802-EC3

List \$1,095

Loveseat

- Chrome finish legs and accents
- (-EC3) Black Eco Leather



SL9801-EC3

List \$795

Club Chair



SL9803-EC3

List \$1,395

Sofa



PAC51-V18

Black



Overall Size
32"Wx31"Dx29.5"H

PAC51-V34

Espresso
List \$435
Club Chair

• (-V34)
Espresso
Faux Leather

• (-V18)
Black
Faux Leather

PAC52-V34

Espresso



Overall Size
51.5"Wx31"Dx29.5"H

PAC52-V18

Black
List \$580
Loveseat

• Silver
finish legs



Overall Size
72.75"Wx31.5"Dx29.75"H

PAC53-V18

Black

PAC53-V34

Espresso
List \$795
Sofa

OFD-SL8471

List \$750
Club Chair



Overall Size
32"Wx33.5"Dx30.75"H

OFD-SL8472

List \$1,125
Loveseat



Overall Size
58"Wx33.5"Dx30.75"H

OFD-SL8473

List \$1,425
Sofa

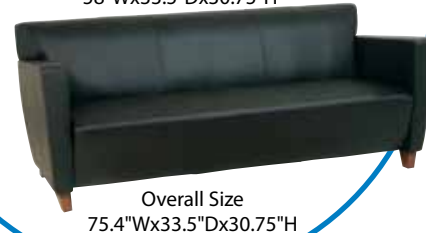

Overall Size
75.4"Wx33.5"Dx30.75"H

• Cherry
finish legs

• Black eco
leather



PAC51-V18
PAC52-V18
YLD09 (2)

Cannot be shipped FedEx/UPS.

lounge it.



Overall Size
30.5"Wx28"Dx31"H

- (-B18) Black,
(-E34) Espresso or
(-W32) White faux
leather

WST51A-B18

Black

WST51A-E34

Espresso

WST51A-W32

White

List \$540

Arm Chair



Black Faux Leather

WST51RF-B18

Black

WST51RF-E34

Espresso

WST51RF-W32

White

List \$485

Right Arm Facing
Modular
Component



lounge it.



Overall Size
27"Wx28"Dx31"H

WST51C-B18

Black

WST51C-E34

Espresso

WST51C-W32

White

List \$540

Corner Modular
Component



lounge it.



Overall Size
28"Wx28"Dx31"H

Espresso

lounge it.



Overall Size
27"Wx28"Dx31"H

WST51LF-B18

Black

WST51LF-E34

Espresso

WST51LF-W32

White

List \$485

Left Arm Facing
Modular Component



- Chrome
frame



Espresso Faux Leather

WST51N-B18

Black

WST51N-E34

Espresso

WST51N-W32

White

List \$405

Armless Facing
Modular Component



lounge it.



Overall Size
23"Wx28"Dx31"H



All items on
this page
have achieved
GREENGUARD
Certification.



lounge it.

Overall Size
26"Wx33"Dx32"H

Chrome Base

NEW!

MUP51-R107

Black Antimicrobial Vinyl

MUP51-R101

Snow Antimicrobial Vinyl
List \$495



lounge it.

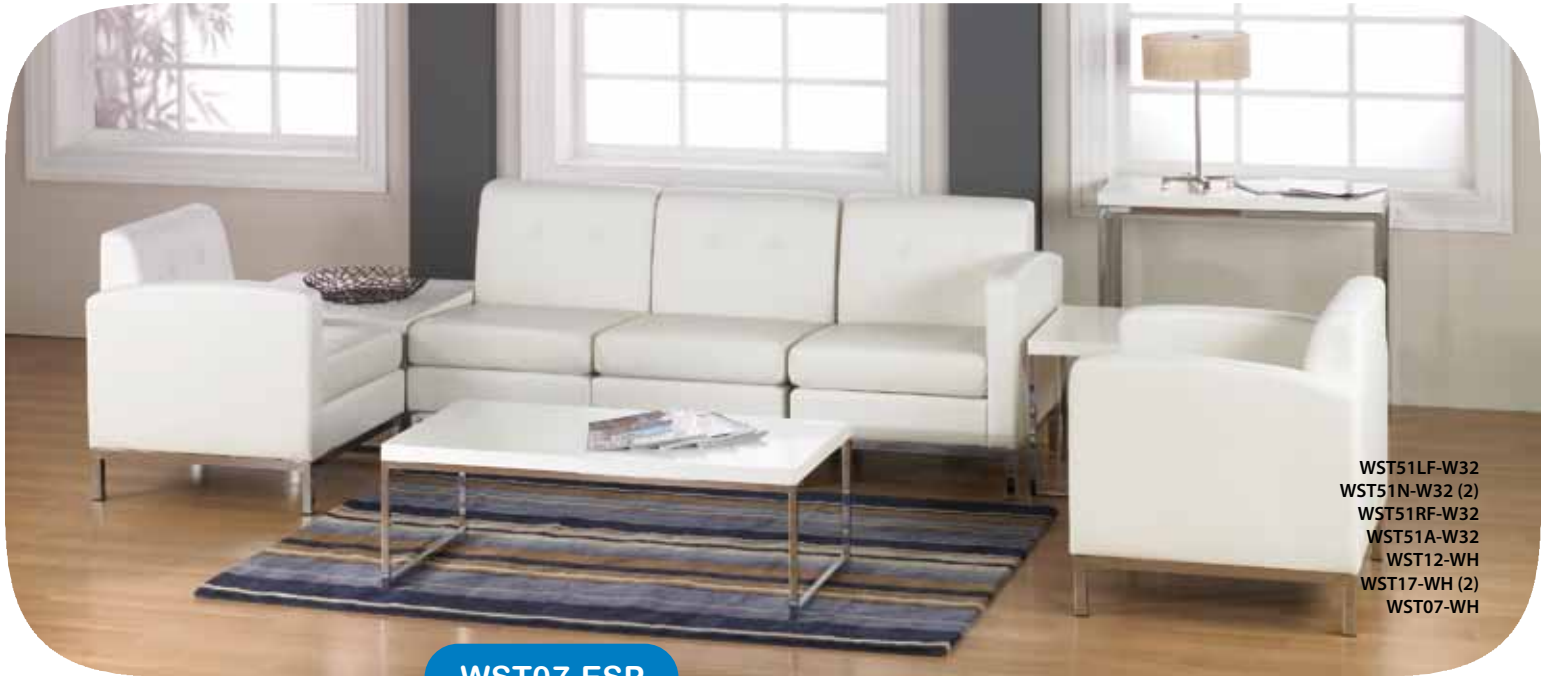

WST51LF-W32
WST51N-W32 (2)
WST51RF-W32
WST51A-W32
WST12-WH
WST17-WH (2)
WST07-WH

WST07-ESP

Espresso Finish Top

Espresso



Overall Size
36"Wx15"Dx29"H

Chrome Frame

WST07-BK

Black

WST07-WH

White

List \$450
Sofa Table

WST09-ESP

Espresso

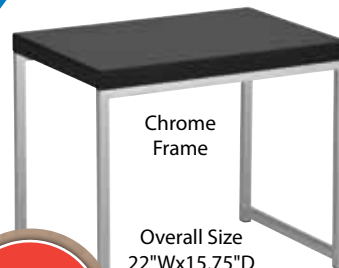

Black Wood Veneer Top

Chrome
Frame

Overall Size
22"Wx15.75"D
x18.5"H

WST09-BK

Black

WST09-WH

White

List \$185
End Table

WST12-ESP

Espresso

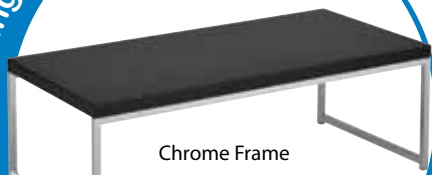

Black Wood Veneer Top

Chrome Frame

Overall Size
44"Wx22"Dx15"H

WST12-BK

Black

WST12-WH

White

List \$290
Coffee Table

WST17-ESP

Espresso



White Wood Veneer Top

Chrome Frame

Overall Size
28"Wx28"Dx17"H

WST17-BK

Black

WST17-WH

White

List \$330
Corner Table

get it.



All items on
this page
have achieved
GREENGUARD
Certification.

58 we stock it.

ATH51-B18

Black



(-B18)
Black Faux
Leather

Chrome
Base

Overall Size
26"Wx33"Dx32"H

NEW!

ATH51-W32

White

ATH51-K26

Charcoal
List \$500

ATH52-B18

Black

ATH52-W32

White

ATH52-K26

Charcoal
List \$850

lounge it.



(-W32) White Faux
Leather

Chrome
Base

Overall Size
58"Wx33"Dx32"H

NEW!

• (-B18)
Black faux
leather, (-W32)
White faux leather
or (-K26) Klein
charcoal fabric

YLD14

List \$115

lounge it.



Glass Top

Chrome
Frame

Overall Size
17"Dia.x21"H

WST16-ESP

Espresso

WST16-BK

Black

WST16-WH

White

List \$250
Side Table

lounge it.



Espresso Finish Top

Overall Size
16"Wx16"Dx24.25"H

Chrome Frame

NEW!

YLD12

List \$235

Coffee Table

lounge it.



Overall Size
44"Wx22"Dx15"H

Overall Size
22"Wx15.75"D
x18.5"H

YLD09

List \$160

End Table

lounge it.

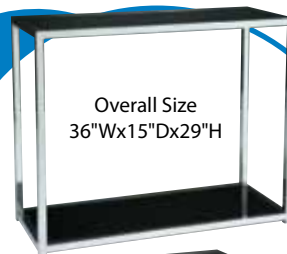

Overall Size
36"Wx15"Dx29"H

Overall Size
28"Wx28"D
x17"H

YLD07

List \$330

Sofa Table

YLD17

List \$235

Corner Table

• Black
glass top
• Chrome
frame



The Curve



OFD-CUR-

Black LeatherSoft
List \$995
Club Chair

accent it.



Overall Size
33.75"Wx30"D
x43"H

Aluminum
Base

Chrome Column

NEW!

-9
Black
LeatherSoft

-10
White
LeatherSoft

-11
Brown
LeatherSoft

-15
Red
LeatherSoft

MST51-S22

accent it.



Espresso
legs

Woven Seaweed
List \$525
Club Chair

-W12
Woven
Charcoal

Overall Size
30"Wx29.5"D
x32"H

-S22
Woven
Seaweed

MST52-W12

accent it.



Espresso
arms and
legs

Overall Size
49.25"Wx29.5"Dx32"H

Woven Charcoal
List \$725
Loveseat

MST53-S22

Woven Seaweed
List \$995
Sofa



Overall Size
75"Wx30.5"Dx32.5"H

-W12
Woven
Charcoal

-S22
Woven
Seaweed

NEW!

MST51-K1R7

accent it.



Espresso
arms and legs

Black/Onyx
List \$875
Club Chair

-K6R4
Buff/Birch

Overall Size
30"Wx29.5"Dx32"H

-K1R7
Black/Onyx

MST52-K6R4

accent it.



Espresso arms and legs

Buff/Birch
List \$1,265
Loveseat

-K6R4
Buff/Birch

Overall Size
49.25"Wx29.5"D
x32"H

-K1R7
Black/Onyx

(All accent seating is in stock in California.
Please allow 7-10 business days.)

MST55-W12

Woven Charcoal
List \$275
 Club Chair

-W12
 Woven
 Charcoal

-S22
 Woven
 Seaweed



Overall Size
 24.25"Wx26.5"D
 x34.5"H

Espresso
 legs

DVS51-K21

Klein Sea
List \$425
 Club Chair

-K21
 Klein Sea

-K12
 Klein Otter

-L32
 Linen



Overall Size
 26.75"Wx28.5"D
 x31.75"H

Espresso
 arms and
 legs

NEW!

MRG12SR1-

Choose a finish
List \$450
 Square Coffee Table

MRG09S-

Choose a finish
List \$349
 Square End Table



Overall Size
 30"Wx30"Dx18.25"H



Overall Size
 20"Wx20"Dx20.75"H

Black Shown

Cherry Shown

Finish Options for
 MRG12SR1, MRG09S, MRG12, MRG09, MRG07R1

-BK
 Black

-CHE
 Cherry

-MAH
 Mahogany

-ESP
 Espresso

MRG07R1-

Choose a finish
List \$469
 Foyer Table



Overall Size
 36"Wx15"Dx30.25"H

Cherry Shown

MRG12-

Choose a finish
List \$595
 Round Coffee Table



Overall Size
 36"Wx36"Dx18"H

Espresso Shown



Overall Size
 20"Wx20"Dx22"H
 Mahogany
 Shown

accent it.

MRG09-

Choose a finish
List \$315
 Round End Table

MST19

Espresso
List \$275
 Nesting Table



Overall Size
 (L) 20.5"Wx17.25"Dx19.75"H
 (S) 16.75"Wx15.5"Dx17"H

accent it.

MST12

Espresso
List \$275
 Coffee Table



Overall Size
 44"Wx22"Dx18"H

accent it.

(All accent seating is in stock in California.
 Please allow 7-10 business days.)

Cannot be shipped FedEx/UPS.

Prado Series Laminate

All Prado Series Below are in stock in California.
Please allow 7-10 business days.

Overall Size
30"Wx60"Dx29.5"H

Matching Metal
Finish Legs

NEW!

PRD3060D-BLK

PRD3060D-WH

List \$575

Overall Size
60"Wx65.75"Dx29.75"H

Matching Metal
Finish Legs

NEW!

PRD3060-BLK

PRD3060-WH

List \$750

Overall Size
15.5"Wx19.5"Dx28"H

Locking
Castors

Hidden
Drawer

NEW!

PRD3085-BLK

PRD3085-WH

List \$500

3/4" Shelf Thickness

Overall Size
31.5"Wx12"Dx30"H

NEW!

PRD3230-BLK

PRD3230-WH

List \$175

Overall Size
42"Wx42"Dx29.5"H

Matching
Metal
Finish Legs

NEW!

PRD42RT-BLK

PRD42RT-WH

List \$450

Overall Size
31.5"Wx12"Dx48"H

3/4" Shelf
Thickness

Adjustable
Height
Shelves

NEW!

PRD3248-BLK

PRD3248-WH

List \$240

Overall Size
31.5"Wx12"Dx60"H

3/4" Shelf
Thickness

Adjustable
Height
Shelves

NEW!

PRD3260-BLK

PRD3260-WH

List \$299

(Use Seating Discount on Chairs Below)

guest it.



(-44) Black Fabric

NEW!
color

GI-100-CHE

Cherry

GI-100-MAH

Mahogany

GI-100-ESP

Espresso

GI-100-WAL

Walnut Strand
List \$295

Matches laminate series



-WAL
Walnut Strand

guest it.



(-44) Black Fabric

NEW!
color

GI-125-CHE

Cherry

GI-125-MAH

Mahogany

GI-125-ESP

Espresso

GI-125-WAL

Walnut Strand
List \$315

Matches laminate series

guest it.



(-33) Black Fabric

S-129-CHY

Cherry

K-129-MAH

Mahogany

K-129-LCH

Light Cherry

K-129-ESP

Espresso

List \$400

Matches reeded & radius edge wood series

guest it.



(-33) Black Fabric

K-99-LCH

Light Cherry

K-99-MAH

Mahogany

K-99-ESP

Espresso

S-99-CHY

Cherry

List \$380

Matches reeded & radius edge wood series

K - Kent

S - Studio

M - Madison

guest it.



(-33) Black Fabric

M-94-CHY

Satin Cherry

List \$510

Matches inlay wood series

guest it.



Wrap Around Back

(-03) Black Vinyl

(-JTO) Oxblood Vinyl

Padded Arms

TR-102-JTO

Oxblood

TR-102-03

Black Vinyl

List \$225

No Casters

TR-101-03

Black Vinyl

TR-101-JTO

Oxblood

List \$235

With Casters

• Mahogany finish wood frame

Cannot be shipped FedEx/UPS.



GI-300C-

Cherry
List \$280
 Choose -316,
 -363 or -U6 fabric

- 363 Black Triangle
- U6 Black Faux Leather

(-316) Taupe Fabric



GI-300M-

Mahogany
List \$280
 Choose -316,
 -363 or -U6 fabric

- U6 Black Faux Leather
- 316 Taupe

(-363) Black Triangle Fabric



GI-300E-

Espresso
List \$280
 Choose -316,
 -363 or -U6 fabric

- 363 Black Triangle
- 316 Taupe

(-U6) Black Faux Leather



GI-400C-

Cherry
List \$400
 Choose -316,
 -363 or -U6 fabric

- U6 Black Faux Leather
- 316 Taupe

(-363) Black Triangle Fabric



GI-400M-

Mahogany
List \$400
 Choose -316,
 -363 or -U6 fabric

- 363 Black Triangle
- U6 Black Faux Leather

(-316) Taupe Fabric



GI-400E-

Espresso
List \$400
 Choose -316,
 -363 or -U6 fabric

- 363 Black Triangle
- 316 Taupe

(-U6) Black Faux Leather



WD300-

Add on Kit
 Choose a finish
 and a fabric
List \$215

Kit includes:
 1 middle arm,
 1 seat and 1 back
ONLY
 GI-300 is needed to
 complete

- CHE Cherry
- MAH Mahogany
- ESP Espresso
- 363 Black Triangle
- U6 Black Faux Leather
- 316 Taupe

(-MAH) Mahogany (-363) Black Triangle Fabric



82740-30

List \$205
Stacks 4-6 high

stack it.

Titanium
Finish
Frame



(-30) Coal
FreeFlex®
Fabric Seat and
Back

86710-30

List \$205
Stacks 4-6 high

stack it.

Titanium
Finish
Frame



(-30) Coal
FreeFlex®
Fabric Seat and
Back

Black
Pro
GRID®
Back

86724-30

List \$205
Stacks 4-6 high

stack it.

Titanium
Finish
Frame



(-30) Coal
FreeFlex®
Fabric Seat and
Back

Black
Pro
GRID®
Back

86725-30

List \$225
Stacks 4-6 high

stack it.

Titanium
Finish
Frame



(-30) Coal
FreeFlex®
Fabric Seat and
Back

Black
Pro
GRID®
Back

DC8309C

List \$200

stack it.

Plastic Seat
and Back



Overall Size
19.75"Wx22"D
x44"H

Chrome Sled
Base

NEW!

SI-1104-231

List \$200
Stacks 4-6 high

stack it.

Black Finish
Frame



(-231) Black
Icon Fabric
Back and Seat

All items on
this page
have achieved
GREENGUARD
Certification.



stack it.

8610-30

List \$185
Stacks 4-6 high

stack it.

Titanium
Finish
Frame

(-30) Coal
FreeFlex®
Fabric Seat and
Plastic Back



8455-30

List \$135
Stacks 4-6 high

stack it.

Chrome
Sled
Base

(-30) Coal
FreeFlex®
Fabric Seat and
Plastic Back



8620-30

List \$170
Stacks 4-6 high

stack it.

(-30) Coal
FreeFlex®
Fabric Seat and
Plastic Back

Titanium Finish
Frame



OFD-865-3

List \$132
Stacks 4-6 high

stack it.

Plastic Seat
and Back

Chrome Sled
Base



STC8302C4-3

List \$110
Stacks 4-6 high

stack it.

Plastic Seat
and Back

Chrome
Sled
Base



STC18A4-2

Gray

Seat Height:
17.5"H

STC18A4-3

Black

STC18A4-11

White
List \$115

Metal Seat
and Back

stack it.



NEW!

stack it.



DOL06

List \$140
Holds 30 chairs
for SI-1106-3

SI-1106-3

List \$125
Stacks 35 high

stack it.



Plastic Seat
and Back

Black Frame

OFD-3030-3

List \$132
Stacks 4-6 high

stack it.



Plastic Seat
and Back

Chrome Sled
Base

SI-1107-3

List \$105
Stacks 20 high

stack it.



Plastic Seat
and Back

Black Frame

STC866C4-7

Blue

STC866C4-4

Burgandy

STC866C4-3

Black
List \$132
Stacks 4-6 high

stack it.



Plastic Seat
and Back

Chrome Sled
Base

DOL865

List \$175
Holds 28 chairs for
OFD-865-3 &
OFD-3030-3

stack it.



(Dolly Only)

DOL8302

List \$175
Holds 28 chairs
for STC8302C4-3



Cannot be shipped FedEx/UPS.

(All Chairs and Stools Available with Wood or Vinyl Seat)

café it.



Black Powder Coat Frame

Seat Height: 19.75"H

(-B6) Black Vinyl Seat

CI-850-B6

List \$259

Choose -B6, or -MAH seat

-MAH
Mahogany Seat



CI-825-B6 (4) & CI-BAR30R-LCH shown

CI-800-MAH

List \$259

Choose -B6, or -MAH seat

-B6
Black Vinyl Seat

café it.



Black Powder Coat Frame

Seat Height: 19.5"H

(-MAH) Mahogany Seat

café it.



Black Powder Coat Frame

Seat Height: 31"H

(-B6) Black Vinyl Seat

CI-825-B6

List \$319

Choose -B6, or -MAH seat

-MAH
Mahogany Seat

café it.



Black Powder Coat Frame

Seat Height: 30.25"H

(-MAH) Mahogany Seat

CI-875-MAH

List \$319

Choose -B6, or -MAH seat

-B6
Black Vinyl Seat



CI-850-B6 (4)
CI-BREAK-X30SQ-WAL



All Tables are 29"H. All Bar Tables are 41.5"H.

Tables available with an X base or round base!



CI-BREAK30SQ

List \$500
30" x 30" Square Table

CI-BREAK36SQ

List \$639
36" x 36" Square Table

CI-BAR30SQ

List \$589
30" x 30" Square Table

CI-BAR36SQ

List \$679
36" x 36" Square Table



CI-BREAK30R

List \$500
30" Dia. Round Table

CI-BREAK36R

List \$639
36" Dia. Round Table

CI-BAR30R

List \$589
30" Dia. Round Table

CI-BAR36R

List \$679
36" Dia. Round Table

CI-BREAK-X30SQ

List \$500
30" x 30" Square Table

CI-BREAK-X36SQ

List \$639
36" x 36" Square Table

CI-BAR-X30SQ

List \$589
30" x 30" Square Table

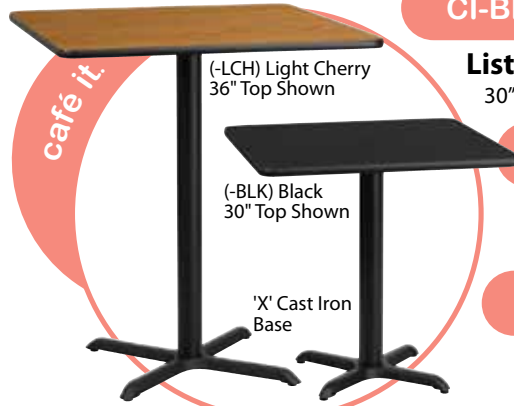

get it.



CI-BREAK-X30R

List \$500
30" Dia. Round Table

CI-BREAK-X36R

List \$639
36" Dia. Round Table

CI-BAR-X30R

List \$589
30" Dia. Round Table

CI-BAR-X36R

List \$679
36" Dia. Round Table

CI-BAR-X36SQ

List \$679
36" x 36" Square Table



BLK/MAH and LCH/WAL table tops are double-sided.

we stock it. 69



BRW29A4-

List \$195

Choose a color ^{OS}



Powder Coat Steel Frame

(-AW) Antique White



Powder Coat Steel Frame

(-ASB) Antique Sky Blue

Seat Height: 26"H

BRW3026A4-

List \$141

Choose a color ^{OS}



Powder Coat Steel Frame

(-AL) Antique Lime

Seat Height: 30"H

BRW3030A4-

List \$162

Choose a color ^{OS}



(-C216) Pastel Pink

Overall Size 30"Wx30"Dx29.75"H

ALB43211-

List \$390

Choose a color below ^{OS}

-C216 Pastel Pink

Flip Top!

-P702 Pastel Lemon

-P704 Pastel Quarry

-11 White

-P705 Pastel Teal



(-CP) Copper

Overall Size 26"Wx26"D x29"H



BRW432-

List \$390

Choose a color below ^{OS}



BRW432-ARD

(All items above are in stock in California. Please allow 7-10 business days.)

Cannot be shipped FedEx/UPS.

^{OS} Oversized Seating Item - Check Shipping Program

T-Rex Series

add it.



OFD-TREX2-GM

Dual Monitor Arm
Grommet Mount

OFD-TREX2-CM

Dual Monitor Arm
Clamp Mount

List \$399

- Effortlessly adjust the angle and focal depth of your flat-screen monitor for either seated or standing applications

- Impressive 4" - 21" horizontal travel range
- Accommodates all VESA-compliant monitors weighing up to 25 pounds
- Available in both clamp- and grommet-mount versions

- Unique pivot assembly fine tunes monitor angle and height
- Swivel assembly allows flexibility to adjust the monitor for portrait or landscape views

get it.

add it.



OFD-TREX1-GM

Single Monitor Arm
Grommet Mount

OFD-TREX1-CM

Single Monitor Arm
Clamp Mount

List \$269

add it.



OFD-200-DR

Plastic Center Drawer

List \$85

• 21"x18.125"x2"

add it.



OFD-800-CPU

Metal CPU Holder

List \$199

- Retractable
- Swivels 360°
- CPU case size: 3.75"-8.25"W x 12"-20.5"H

cube it.



Ultra2 Panel System - AO2™ Compatible

Ultra2 Systems. OEM Compatible. Ultra2 is a classic monolithic panel system designed to stand alone and work in tandem with Herman Miller® Action Office Series 2. Ultra2 Systems offers fabric and glass panels in varying heights with a 6" raceway to meet electrical and data needs. There are multiple work surfaces, components and accessories. Ultra2 is the ideal combination of value and performance. The possibilities are endless! Ultra2 provides you with the flexibility to design your space to meet your needs – from cluster-working environments, to private offices – you can design Ultra2 to work for you. Utilizing low panel height you can create a teaming environment, or integrate high panels to create a more private configuration. Ultra2 now has three distinctive, in-stock fabrics and four options for work surfaces. Let Ultra2 be your in-stock solution for your office space. Free space planning is available.

3 Fabric Choices!
4 Laminate Choices!
get it.

72 we stock it.

ULTRA2 | Typical Workstations



OFD-U2-2453
53" Tall - 4-Pod Workstation
 2'x4'
 Includes Base Power Feed, BBF
 Pedestal and 1 Receptacle per
 Station
List \$9,641



**Honey Wheat
 Fabric**



**Wild Cherry
 Laminate**

OFD-U2-66674
67" Tall - 4-Pod Workstation
 6'x6'
 Includes Base Power Feed,
 BBF Pedestal, Flipper Door Unit
 and 1 Receptacle
List \$23,976



**Whiteburst
 Fabric**



**Brushed Nickel
 Laminate**

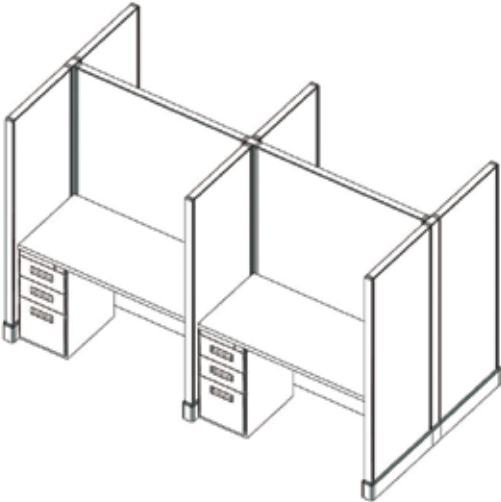

OFD-U2-24674
67" high 4-Pod Workstation
 2'x4'
 Includes Base Power Feed, BBF
 Pedestal, and 1 Receptacle per
 Station
List \$10,220

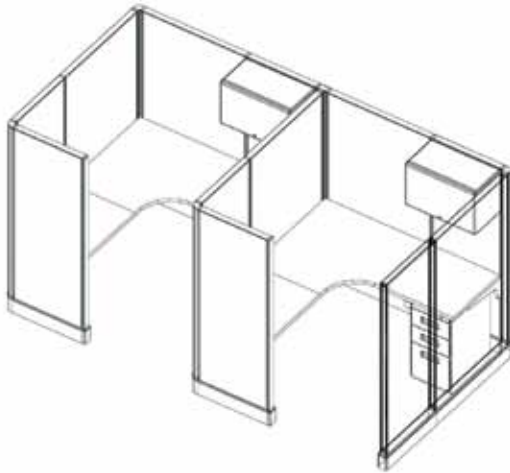

OFD-U2-55672
67" high 2-Pod Workstation
 5'x5'
 Includes Base Power Feed, BBF
 Pedestal, 2 Receptacles, and a
 Flipper Door per Station
List \$12,770

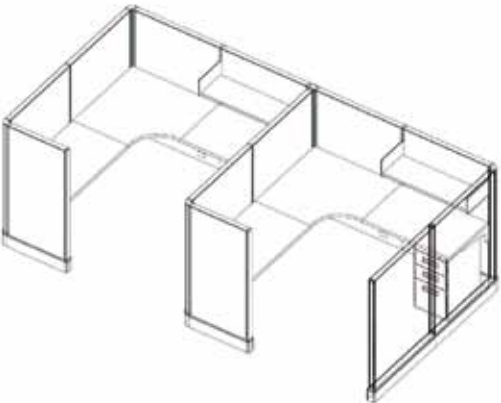

OFD-U2-66532
53" high 2-Pod Workstation
 6'x6'
 Includes Base Power Feed, BBF
 Pedestal, 2 Receptacles and a
 Half Shelf per Station
List \$12,055

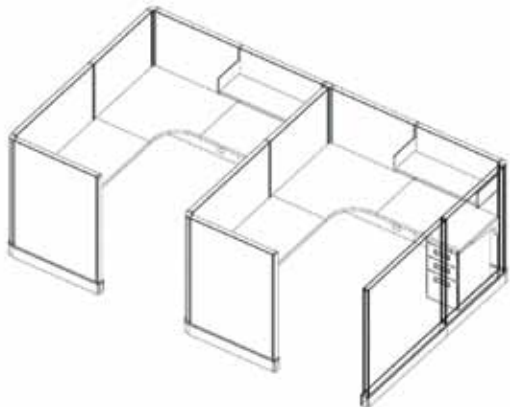

OFD-U2-67532
53" high 2-Pod Workstation
 6'x7'
 Includes Base Power Feed, BBF
 Pedestal, 2 Receptacles and a
 Half Shelf per Station
List \$12,772

Ultra2 Panel System - AO2™ Compatible

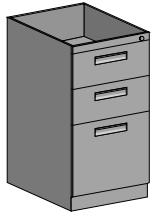

OFD-BBF
Pedestal Box/Box/File
27.5"Hx15"Wx20"D
List \$602

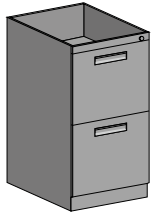

OFD-FF
Pedestal File/File
27.5"Hx15"Wx20"D
List \$602

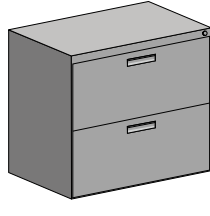

OFD-LAT30
Lateral File Pedestal
27.5"Hx30"Wx20"D
List \$1,346



OFD-PFDU-24
24"W Painted
Flipper Door Unit
List \$412



OFD-PFDU-30
30"W Painted
Flipper Door Unit
List \$441



OFD-PFDU-36
36"W Painted
Flipper Door Unit
List \$490



OFD-PFDU-48
48"W Painted
Flipper Door Unit
List \$547



OFD-PFDU-60
60"W Painted
Flipper Door Unit
List \$606

OFD-PEDFB
File Bar for Side to Side
Filing on Pedestal
List \$22

OFD-LATFB
File Bar for Front to Back
Filing on Lateral File
List \$24



OFD-HALFSHELF24 - 24" "B" Style Shelf, Half Height End Panels List \$163

OFD-HALFSHELF30 - 30" "B" Style Shelf, Half Height End Panels..... List \$177

OFD-HALFSHELF36 - 36" "B" Style Shelf, Half Height End Panels List \$193

OFD-HALFSHELF48 - 48" "B" Style Shelf, Half Height End Panels List \$216

OFD-HALFSHELF60 - 60" "B" Style Shelf, Half Height End Panels List \$239



OFD-SHELF24 - 24" "B" Style Shelf, Full Height End Panels..... List \$191

OFD-SHELF30 - 30" "B" Style Shelf, Full Height End Panels..... List \$205

OFD-SHELF36 - 36" "B" Style Shelf, Full Height End Panels List \$221

OFD-SHELF48 - 48" "B" Style Shelf, Full Height End Panels List \$244

OFD-SHELF60 - 60" "B" Style Shelf, Full Height End Panels List \$267



OFD-LED.20 - Task Light for Overhead/Shelf List \$240

OFD-LED.38 - Task Light for Overhead/Shelf List \$270

OFD-WM - Wire Manager for Task Lights List \$19

Tackboard available in all fabrics.



OFD-UTACK24 - Tackboard 24"x15.5" ... List \$165

OFD-UTACK30 - Tackboard 30"x15.5" ... List \$176

OFD-UTACK36 - Tackboard 36"x15.5" ... List \$183

OFD-UTACK48 - Tackboard 48"x15.5" ... List \$204

OFD-UTACK60 - Tackboard 60"x15.5" ... List \$227

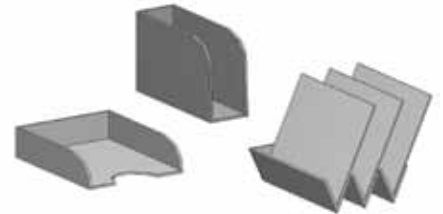

OFD-TRAY - Letter Size Tray 12"x10"x3" List \$84

OFD-VTRAY - Vertical Single Tray 12"x4"x8" List \$84

OFD-3VTRAY - Vertical Triple Tray 12"x4"x8" .. List \$107

OFD-START39 - Wall Start for 39" Panel... List \$59

OFD-START53 - Wall Start for 53" Panel... List \$59

OFD-START67 - Wall Start for 67" Panel... List \$61

OFD-STRIP60 - Wall Strip - 60" List \$77

OFD-STRIP72 - Wall Strip - 72" List \$83

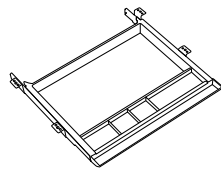

OFD300DR - Center Drawer
List \$130

OFD-Pole-39E - Power Pole to Connect to a 39" High Panel List \$671

OFD-Pole-53E - Power Pole to Connect to a 53" High Panel List \$671

OFD-Pole-67E - Power Pole to Connect to a 67" High Panel List \$671

OFD-Pole-39N - Data Pole to Connect to a 39" High Panel List \$303

OFD-Pole-53N - Data Pole to Connect to a 53" High Panel..... List \$303

OFD-Pole-67N - Data Pole to Connect to a 67" High Panel..... List \$303

OFD-BPF - Base Power Feed List \$341

Tool Bar for Trays and Sorter



OFD-TB24 - Tool Bar 24" List \$93

OFD-TB30 - Tool Bar 30" List \$100

OFD-TB36 - Tool Bar 36" List \$108

OFD-TB48 - Tool Bar 48" List \$125

OFD-TB60 - Tool Bar 60" List \$136



OFD-TRRS-24 - Transaction Top - Rectangle 14"x 24" List \$141

OFD-TRRS-30 - Transaction Top - Rectangle 14"x 30" List \$162

OFD-TRRS-36 - Transaction Top - Rectangle 14"x 36" List \$174

OFD-TRRS-48 - Transaction Top - Rectangle 14"x 48" List \$212



OFD-TRCS-24 - Transaction Top - Corner 14"x24" List \$267

OFD-TRCS-30 - Transaction Top - Corner 14"x30" List \$368

OFD-TRCS-36 - Transaction Top - Corner 14"x36" List \$393

OFD-TRCS-48 - Transaction Top - Corner 14"x48" List \$558

OFD-DCL
Dual Column Leg
Support
List \$184

Additional Work Surface
Support Leg, Black
27¾"Hx18"D

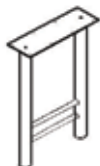

NEW!
30\" Top

OFD-TRES - Transaction Surface END Support..... List \$34

OFD-TRMES - Transaction Surface MID/END Support... List \$34

OFD-TRCS - Transaction Surface CENTER Support List \$35

Ultra2 Panel System - AO2™ Compatible



Non-Power Panels

- OFD-3924N - Fabric Panel - Empty Raceway List \$376
- OFD-3930N - Fabric Panel - Empty Raceway List \$411
- OFD-3936N - Fabric Panel - Empty Raceway List \$463
- OFD-3948N - Fabric Panel - Empty Raceway List \$513

- OFD-5324N - Fabric Panel - Empty Raceway List \$406
- OFD-5330N - Fabric Panel - Empty Raceway List \$460
- OFD-5336N - Fabric Panel - Empty Raceway List \$506
- OFD-5348N - Fabric Panel - Empty Raceway List \$617
- OFD-5360N - Fabric Panel - Empty Raceway List \$747

- OFD-6724N - Fabric Panel - Empty Raceway List \$471
- OFD-6730N - Fabric Panel - Empty Raceway List \$528
- OFD-6736N - Fabric Panel - Empty Raceway List \$610
- OFD-6748N - Fabric Panel - Empty Raceway List \$692
- OFD-6760N - Fabric Panel - Empty Raceway List \$831

- OFD-5324GPN - Partial Glazed Fabric Panel - Empty Raceway..... List \$616
- OFD-5330GPN - Partial Glazed Fabric Panel - Empty Raceway..... List \$671
- OFD-5336GPN - Partial Glazed Fabric Panel - Empty Raceway..... List \$808
- OFD-5348GPN - Partial Glazed Fabric Panel - Empty Raceway..... List \$930

- OFD-6724GPN - Partial Glazed Fabric Panel - Empty Raceway..... List \$681
- OFD-6730GPN - Partial Glazed Fabric Panel - Empty Raceway..... List \$738
- OFD-6736GPN - Partial Glazed Fabric Panel - Empty Raceway..... List \$879
- OFD-6748GPN - Partial Glazed Fabric Panel - Empty Raceway..... List \$1,078

Corner Work Surfaces



- OFD-2436WSCC - Curved Corner Work Surface 24"x36" List \$518
- OFD-2448WSCC - Curved Corner Work Surface 24"x48" List \$675

Rectangle Work Surfaces



- OFD-2424WS - Work Surface Rectangle 24"x24" List \$243
- OFD-2430WS - Work Surface Rectangle 24"x30" List \$285
- OFD-2436WS - Work Surface Rectangle 24"x36" List \$296
- OFD-2448WS - Work Surface Rectangle 24"x48" List \$385
- OFD-2460WS - Work Surface Rectangle 24"x60" List \$480
- OFD-2472WS - Work Surface Rectangle 24"x72" List \$554

Bullet Work Surface

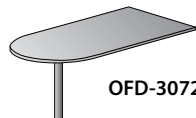

- OFD-3072BUL - Bullet Work Surface 30"x72" List \$684

ULTRA2



Power Panels

- OFD-3924E - Fabric Panel - Electric Raceway List \$527
- OFD-3930E - Fabric Panel - Electric Raceway List \$565
- OFD-3936E - Fabric Panel - Electric Raceway List \$616
- OFD-3948E - Fabric Panel - Electric Raceway List \$664

- OFD-5324E - Fabric Panel - Electric Raceway List \$556
- OFD-5330E - Fabric Panel - Electric Raceway List \$614
- OFD-5336E - Fabric Panel - Electric Raceway List \$691
- OFD-5348E - Fabric Panel - Electric Raceway List \$770
- OFD-5360E - Fabric Panel - Electric Raceway List \$871

- OFD-6724E - Fabric Panel - Electric Raceway List \$620
- OFD-6730E - Fabric Panel - Electric Raceway List \$680
- OFD-6736E - Fabric Panel - Electric Raceway List \$762
- OFD-6748E - Fabric Panel - Electric Raceway List \$844
- OFD-6760E - Fabric Panel - Electric Raceway List \$976

- OFD-5324GPE - Partial-Glazed Fabric Panel - Electric Raceway..... List \$767
- OFD-5330GPE - Partial-Glazed Fabric Panel - Electric Raceway..... List \$823
- OFD-5336GPE - Partial-Glazed Fabric Panel - Electric Raceway..... List \$961
- OFD-5348GPE - Partial-Glazed Fabric Panel - Electric Raceway..... List \$1,082

- OFD-6724GPE - Partial-Glazed Fabric Panel - Electric Raceway..... List \$831
- OFD-6730GPE - Partial-Glazed Fabric Panel - Electric Raceway..... List \$891
- OFD-6736GPE - Partial-Glazed Fabric Panel - Electric Raceway..... List \$1,033
- OFD-6748GPE - Partial-Glazed Fabric Panel - Electric Raceway..... List \$1,157

Draw Rods



- OFD-DR39 - Draw Rod for 39" 2 Way Connection 180° List \$24
- OFD-DR53 - Draw Rod for 53" 2 Way Connection 180° List \$25
- OFD-DR67 - Draw Rod for 67" 2 Way Connection 180° List \$25

Connectors



- OFD-2W39 - 2 Way 39" Connector 90° List \$137
- OFD-2W53 - 2 Way 53" Connector 90° List \$168
- OFD-2W67 - 2 Way 67" Connector 90° List \$184

- OFD-3W39 - 3 Way 39" Connector 90° List \$158
- OFD-3W53 - 3 Way 53" Connector 90° List \$200
- OFD-3W67 - 3 Way 67" Connector 90° List \$236

- OFD-4W39 - 4 Way 39" Connector 90° List \$163
- OFD-4W53 - 4 Way 53" Connector 90° List \$210
- OFD-4W67 - 4 Way 67" Connector 90° List \$278

Finished End Trim



- OFD-FE39 - Finished End Trim for 39" Panel List \$64
- OFD-FE53 - Finished End Trim for 53" Panel List \$80
- OFD-FE67 - Finished End Trim for 67" Panel List \$90
- OFD-FECHANGE - Finished End Trim Change of Height Panel . List \$25

Ultra2 | Specifications

Thermofused Laminate Tops

Ultra2 Laminates are selected from premium grade laminates. The Ultra2 Collection is offered in 4 Laminate Finishes. Light Gray is on one side, Brushed Nickel on the other and Cloud White is on one side, Wild Cherry on the other, all with Dark Tone 3mm edge band. Tops are 1-1/8" thick and feature a profiled 3mm edge on all four sides. Tops are installed with pins and buttons.

Fabric: WHB - Whiteburst, MNS - Midnight Stone, HW - Honey Wheat

Paint: DTE - Dark Tone

Trim: DTE - Dark Tone

(All prices in this price list for the work surfaces include the work surface top, 1 pair of mounting cantilevers, pins and buttons to secure work surfaces, and 1 mending bracket. Corner work surfaces include above plus additional corner bracket, grommet and cover. All items above will be listed on your acknowledgement, itemized under each part number.

Pedestals - 20" Deep, BBF and FF style, with locks - "B" Style Fronts

Locks

All pedestals, lateral pedestals, and overheads come standard with lock. All units are keyed random. Requests for different keying can be accommodated, and must be specified.



Optional **W001-W050**
Lock core and keys

List \$25

Panels (AO2™ Compatible Panel System)

Panels are 2" thick, fabric covered on both sides and feature a steel frame, with a painted aluminum top cap. Each panel comes standard with leveling glides and 2 raceway covers. Electric panels come standard with the wiring harness installed, 2 raceway covers with notched receptacle openings and covers, and a panel-to-panel electric connector. (Order receptacles separately) All items above will be listed on your acknowledgement itemized under each part number.

A pass through cable must be ordered separately when connecting power through a 3-way or 4-way connector.

All Power is UL Listed



In Stock Options



Cloud White
Laminate
Side 1



Wild Cherry
Laminate
Side 2

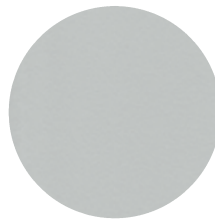

Light Gray
Laminate
Side 1

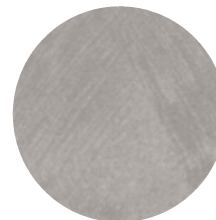

Brushed Nickel
Laminate
Side 2



Dark Tone - Paint, Trim,
and Edge Band



Honey Wheat Fabric

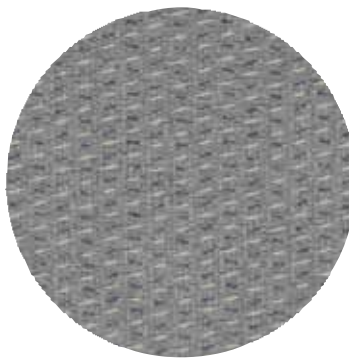

Midnight Stone Fabric



Whiteburst Fabric

Casegood Finishes



Kent - LCH
(pg. 2-4)



Kent - MAH
(pg. 2-4)



Kent - ESP
(pg. 2-4)



Studio - CHY
(pg. 5-7)



Madison - CHY
(pg. 8-10)

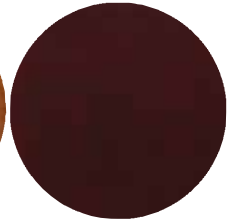

Madison - FMAH
(pg. 8-10)



Nexus - CHY
(pg. 11-13)



Nexus - MAH
(pg. 11-13)



Nexus - ESP
(pg. 11-13)

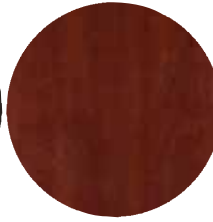

Ultra - CHY
(pg. 14-16)

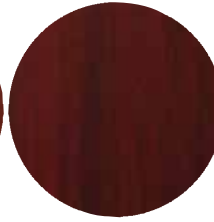

Ultra - MAH
(pg. 14-16)

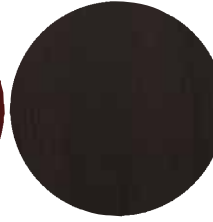

Ultra - ESP
(pg. 14-16)



Ultra - WAL
(pg. 14-16)

Seating Fabrics

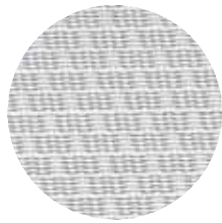

White Breathable Mesh
317W-W1C1F2W (pg. 29),
317W-W11C1F2W (pg. 29)

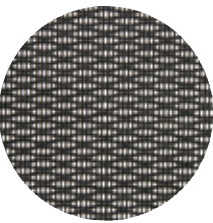

Black Breathable Mesh
2300 (pg. 33), 818-31G9C18P
(pg. 34), 839-11B35WA
(pg. 35), DC2990-231
(pg. 38), DC2990V (pg. 38),
MI-95893 (pg. 42), MI-4102-3
(pg. 44) MI-1800-3 (pg. 44),
69906-3 (pg. 44)

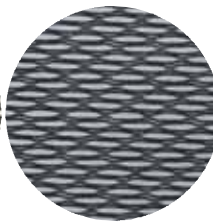

Light AirGrid®
317-6C61F6 (pg. 30),
317-ME36C61F6 (pg. 30),
317-66C61F6 (pg. 30)



Dark AirGrid®
5500 (pg. 32), 5700E (pg. 33),
5505 (pg. 33), 335-E37P918P
(pg. 34), 5540 (pg. 34), 55403
(pg. 34), 75-37A773 (pg. 35),
63-37A773HM (pg. 35),
75-47A773 (pg. 35),
13-37N20D (pg. 37),
15-37A720D (pg. 37),
213-37N2F3D (pg. 37)

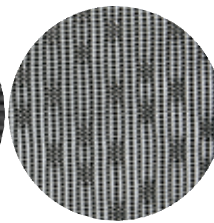

SpaceGrid®
529-R22N1F2 (pg. 31),
529-E3R2N1F2 (pg. 31),
529-3R2N1F2 (pg. 31)

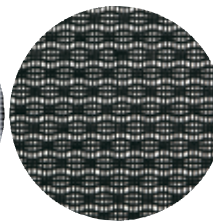

Black ProGrid®
NI-1200-30 (pg. 39),
NI-1000-30 (pg. 39),
MI-2102- (pg. 41),
MI-2502- (pg. 41),
MI-97728-EC3 (pg. 41),
MI-97720-30 (pg. 41),
MI-93720 (pg. 41),
MI-1122-30 (pg. 42),
MI-1522-30 (pg. 42),
MI-1500-30 (pg. 42),
85670-30 (pg. 42), 85640-30
(pg. 42), MI-2817 (pg. 44),
MI-28174 (pg. 44), 86724-30
(pg. 67), 86725-30 (pg. 67),
86710-30 (pg. 67)



White ProGrid®
MI-8810W (pg. 30, pg. 43),
MI-95672 (pg. 43), MI-95673
(pg. 43)

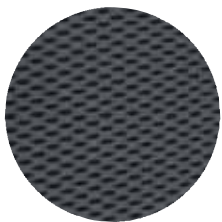

Black Mesh

529-3R2N1F2 (pg. 31), 5500
(pg. 32) 2300 (pg. 33), 5505
(pg. 33), 5540 (pg. 34), 55403
(pg. 34), 818-31G9C18P
(pg. 34), 75-37A773 (pg. 35),
63-37A773HM (pg. 35),
13-37N20D (pg. 37),
15-37A720D (pg. 37),
213-37N2F3D (pg. 37),
MI-95893 (pg. 42), 183305
(pg. 45), 519117HC-EC3
(pg. 47), 519117MC-EC3
(pg. 47)

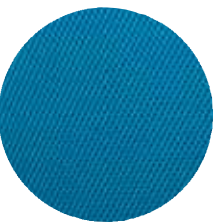

(-7) Blue Mesh

317W-W1C1F2W (pg. 29),
5200W (pg. 29),
317-6C61F6 (pg. 30),
MI-8810W (pg. 30, pg. 43),
5500 (pg. 32), 5505
(pg. 33), 848W (pg. 39),
MI-2102 (pg. 41), MI-2502
(pg. 41), MI-1122 (pg. 42),
MI-1522 (pg. 42), MI-95672
(pg. 43), MI-95673 (pg. 43)

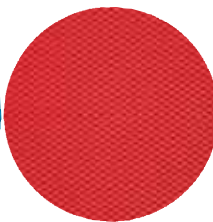

(-9) Red Mesh

317W-W1C1F2W (pg. 29),
5200W (pg. 29),
317-6C61F6 (pg. 30),
MI-8810W (pg. 30, pg. 43),
5500 (pg. 32), 5505
(pg. 33), 848W (pg. 39),
MI-2102 (pg. 41), MI-2502
(pg. 41), MI-1122 (pg. 42),
MI-1522 (pg. 42), MI-95672
(pg. 43), MI-95673 (pg. 43)

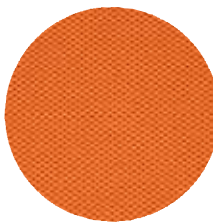

(-18) Orange Mesh

317W-W1C1F2W (pg. 29),
5200W (pg. 29),
317-6C61F6 (pg. 30),
MI-8810W (pg. 30, pg. 43),
5500 (pg. 32), 5505
(pg. 33), 848W (pg. 39),
MI-2102 (pg. 41), MI-2502
(pg. 41), MI-1122 (pg. 42),
MI-1522 (pg. 42), MI-95672
(pg. 43), MI-95673 (pg. 43)

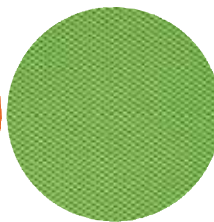

(-6) Green Mesh

317W-W1C1F2W (pg. 29),
5200W (pg. 29),
317-6C61F6 (pg. 30),
MI-8810W (pg. 30, pg. 43),
5500 (pg. 32), 5505
(pg. 33), 848W (pg. 39),
MI-2102 (pg. 41), MI-2502
(pg. 41), MI-1122 (pg. 42),
MI-1522 (pg. 42), MI-95672
(pg. 43), MI-95673 (pg. 43)

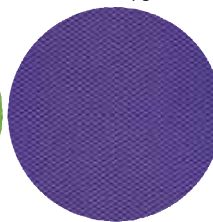

(-512) Purple Mesh

317W-W1C1F2W (pg. 29),
5200W (pg. 29),
317-6C61F6 (pg. 30),
MI-8810W (pg. 30, pg. 43),
5500 (pg. 32), 5505
(pg. 33), 848W (pg. 39),
MI-2102 (pg. 41), MI-2502
(pg. 41), MI-1122 (pg. 42),
MI-1522 (pg. 42), MI-95672
(pg. 43), MI-95673 (pg. 43)

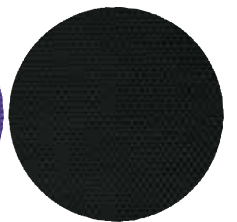

(-3) Black Mesh

317W-W1C1F2W (pg. 29),
5200W (pg. 29), 317-6C61F6
(pg. 30), MI-8810W (pg. 30,
pg. 43), 5500 (pg. 31), 5505
(pg. 33), 848W-3 (pg. 39),
MI-95672 (pg. 43), MI-95673
(pg. 43), MI-4102-3
(pg. 44), MI-1800-3 (pg. 44),
EM51022N-3 (pg. 45)

Seating Fabrics



Breathable Woven Mesh

DC51000NV (pg. 38),
DC51000N-231 (pg. 38)



Black Screen

FC8487-231 (pg. 39),
EM51022N-3 (pg. 45),
183305 (pg. 45)



White Screen

848W (pg. 39)



Black Leather

75-47A773 (pg. 35)

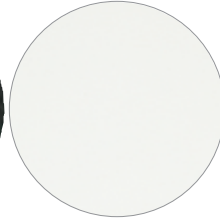

White Leather

7270 (pg. 46), 7271 (pg. 46),
7275 (pg. 46)

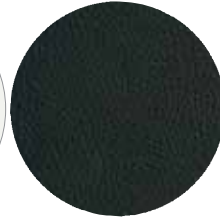

(-3) Black Leather

8200-3 (pg. 46), 8201-3
(pg. 46), 8205-3 (pg. 46)



(-G1) Espresso Glove Soft Leather

OFD-6640-G1 (pg. 46)



(-BLK) Black Faux Leather

OFD-605-BLK (pg. 51),
OFD-7000-BLK (pg. 52),
OFD-7100-BLK (pg. 52),
OFD-7200-BLK (pg. 52)



(-SAD) Saddle Faux Leather

OFD-7000-SAD (pg. 52),
OFD-7100-SAD (pg. 52),
OFD-7200-SAD (pg. 52)



(-W32) White Faux Leather

WST51A-W32 (pg. 58),
WST51RF-W32 (pg. 58),
WST51C-W32 (pg. 58),
WST51LF-W32 (pg. 58),
WST51N-W32 (pg. 58),
ATH51-W32 (pg. 61),
ATH52-W32 (pg. 61)



(V) Black Vinyl

DC51000NV (pg. 38)
DC2990V (pg. 38)

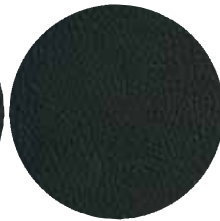

(-V18) Black Faux Leather

PAC51-V18 (pg. 57),
PAC52-V18 (pg. 57),
PAC53-V18 (pg. 57)



(-V34) Espresso Faux Leather

PAC51-V34 (pg. 57),
PAC52-V34 (pg. 57),
PAC53-V34 (pg. 57)



(-U2) Chocolate Faux Leather

FL4836C-U2 (pg. 49),
FL3835C-U2 (pg. 49),
FL3836C-U2 (pg. 49)



(-U6) Black Faux Leather

FL1327C-U6 (pg. 49),
FL4836C-U6 (pg. 49),
FL3836C-U6 (pg. 49),
FL3835C-U6 (pg. 49),
FL89675-U6 (pg. 50),
FL9097-U6 (pg. 50),
FL3422-U6 (pg. 52), FL7480-U6
(pg. 53), FL7481-U6 (pg. 53),
FL7485-U6 (pg. 53),
FL7484-U6 (pg. 53),
FL5380C-U6 (pg. 54),
FL5388C-U6 (pg. 54),
WD300 (pg. 66) GI-300C-U6
(pg. 66), GI-300M-U6 (pg. 66),
GI-300E-U6 (pg. 66),
GI-400C-U6 (pg. 66),
GI-400M-U6 (pg. 66),
GI-400E-U6 (pg. 66)

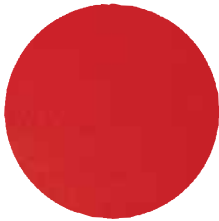

(-U9) Red Faux Leather

FL1327C-U9 (pg. 49)



(-U11) White Faux Leather

FL1327C-U11 (pg. 49),
FL4836C-U11 (pg. 49),
FL3835C-U11 (pg. 49),
FL3836C-U11 (pg. 49),
FL5380C-U11 (pg. 54),
FL5388C-U11 (pg. 54)

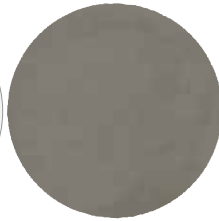

(-U22) Smoke Faux Leather

FL5380C-U22 (pg. 54),
FL5388C-U22 (pg. 54)



(-U28) Cream Faux Leather

FL1327C-U28 (pg. 49)



(-B13) Black Bonded Leather

OFD-6640-B13 (pg. 46)

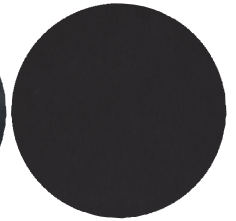

(-B18) Black Faux Leather

WST51A-B18 (pg. 58),
WST51RF-B18 (pg. 58),
WST51C-B18 (pg. 58),
WST51LF-B18 (pg. 58),
WST51N-B18 (pg. 58),
ATH51-B18 (pg. 61),
ATH52-B18 (pg. 61)

Seating Fabrics



(-B6) Black Vinyl

CI-850-B6 (pg. 70), CI-800-B6 (pg. 70), CI-825-B6 (pg. 70), CI-875-B6 (pg. 70)



Black Eco Leather

317-ME36C61F6 (pg. 30), 529-E3R2N1F2 (pg. 31), 335-E37P918P (pg. 34), 74603LT (pg. 48), 74613LT (pg. 48), 74653 (pg. 48), 73631 (pg. 48), OFD-SL8471 (pg. 57), OFD-SL8472 (pg. 57), OFD-SL8473 (pg. 57)

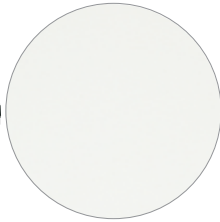

White Eco Leather

74023LT (pg. 48), 74123LT (pg. 48), 74523 (pg. 48), 73633 (pg. 48)



(-JTO) Oxblood Vinyl

TR-101-JTO (pg. 65), TR-102-JTO (pg. 65)



(-03) Black Vinyl

TR-101-03 (pg. 65), TR-102-03 (pg. 65)



(-E34) Espresso Faux Leather

WST51A-E34 (pg. 58), WST51RF-E34 (pg. 58), WST51C-E34 (pg. 58), WST51LF-E34 (pg. 58), WST51N-E34 (pg. 58)

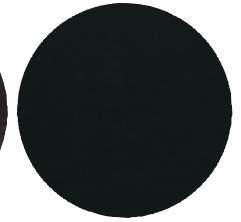

(-EC3) Black Eco Leather

EC1283C-EC3 (pg. 36), MI-97728-EC3 (pg. 41), 519117HC-EC3 (pg. 47), 519117MC-EC3 (pg. 47), 518317HA-EC3 (pg. 47), 51907VC-EC3 (pg. 47), ECH70537-EC3 (pg. 50), ECH83507-EC3 (pg. 50), ECH68807-EC3 (pg. 50), OFD-6583-EC3 (pg. 51), OPH61606-EC3 (pg. 51), EC39890C-EC3 (pg. 54), EC39891C-EC3 (pg. 54), EC39895C-EC3 (pg. 54), SL9801-EC3 (pg. 56), SL9802-EC3 (pg. 56), SL9803-EC3 (pg. 56)



(-EC9) Mocha Eco Leather

EC6582-EC9 (pg. 51)



(-EC10) Latte Eco Leather

OFD-6583-EC10 (pg. 51)

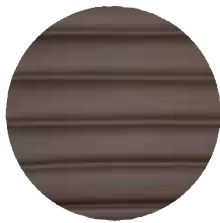

Chocolate Eco Leather

74608LT (pg. 48), 74618LT (pg. 48), 74658 (pg. 48), 73638 (pg. 48)



Gray Eco Leather

74602LT (pg. 48), 74612LT (pg. 48), 74652 (pg. 48), 73632 (pg. 48)

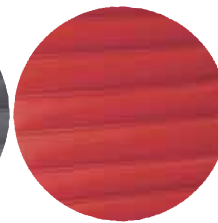

Red Eco Leather

73029LT (pg. 48), 73129LT (pg. 48), 73529 (pg. 48), 73639 (pg. 48)



Black Bonded Leather

39200 (pg. 36)



(-9) Black LeatherSoft

OFD-CUR-9 (pg. 62)



(-10) White LeatherSoft

OFD-CUR-10 (pg. 62)



(-11) Brown LeatherSoft

OFD-CUR-11 (pg. 62)



(-15) Red LeatherSoft

OFD-CUR-15 (pg. 62)

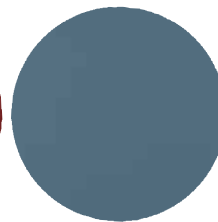

(-R105) Blue Antimicrobial Vinyl

BC9601 (pg. 55), BC9602 (pg. 55), BC9603 (pg. 55)

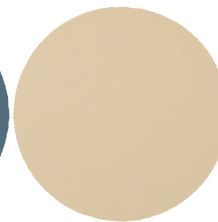

(-R104) Buff Antimicrobial Vinyl

BC9601 (pg. 55), BC9602 (pg. 55), BC9603 (pg. 55)

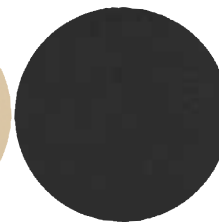

(-R107) Black Antimicrobial Vinyl

MUP51-R107 (pg. 59)



(-R101) White Antimicrobial Vinyl

MUP51-R101 (pg. 59)

Seating Fabrics

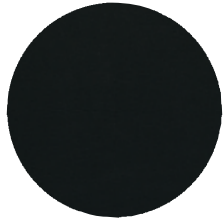

**(E) Black
Eco Leather**

5700E (pg. 33),
9333E (pg. 50)

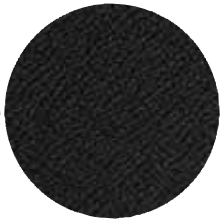

**(-231) Black
Icon Fabric**

DC51000N-231 (pg. 38),
DC2990-231 (pg. 38),
FC8487-231 (pg. 39),
TI-2402-231 (pg. 45),
SI-1104-231 (pg. 67)



**(-30) Coal
FreeFlex®**

NI-2000-30 (pg. 39),
NI-2200-30 (pg. 39),
NI-1200-30 (pg. 39),
NI-1000-30 (pg. 39),
MI-2102-30 (pg. 41),
MI-2502-30 (pg. 41),
MI-97720-30 (pg. 41),
MI-1122-30 (pg. 42),
MI-1522-30 (pg. 42),
MI-1500-30 (pg. 42),
85670-30 (pg. 42), 85640-30
(pg. 42), MI-2817-30 (pg. 44),
MI-28174 (pg. 44),
TI-1102-30 (pg. 45), 82740-30
(pg. 67), 86710-30 (pg. 67),
86724-30 (pg. 67), 86725-30
(pg. 67), 8610-30 (pg. 68),
8455-30 (pg. 68), 8620-30
(pg. 68)



**(-33) Guest Chair
Black Fabric**

K-99 (pg. 65), S-99 (pg. 65),
K-129 (pg. 65), S-129 (pg. 65),
M-94 (pg. 65)



**(-44) Guest Chair
Black Fabric**

GI-100 (pg. 65), GI-125
(pg. 65)



**(-363) Black
Triangle**

WD-300 (pg. 66),
GI-300C-363 (pg. 66),
GI-300M-363 (pg. 66),
GI-300E-363 (pg. 66),
GI-400C-363 (pg. 66),
GI-400M-363 (pg. 66),
GI-400E-363 (pg. 66)



**(-316) Taupe
Fabric**

WD-300 (pg. 66),
GI-300C-316 (pg. 66),
GI-300M-316 (pg. 66),
GI-300E-316 (pg. 66),
GI-400C-316 (pg. 66),
GI-400M-316 (pg. 66),
GI-400E-316 (pg. 66)

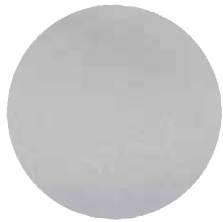

(-2) Gray Fabric

MI-95672-2 (pg. 43),
MI-95673-2 (pg. 43)



Black Fabric

39203 (pg. 36)



Charcoal Fabric

39202 (pg. 36)



**(-L32) Linen
Fabric**

DVS51-L32 (pg. 63)

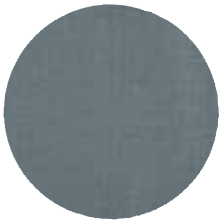

**(-K21) Klein
Sea Fabric**

DVS51-K21 (pg. 63)



**(-K12) Klein
Otter Fabric**

DVS51-K12 (pg. 63)



**(-K26) Klein
Charcoal Fabric**

ATH51-K26 (pg. 61),
ATH52-K26 (pg. 61)



**(-S22) Woven
Seaweed**

MST51-S22 (pg. 62),
MST52-S22 (pg. 62),
MST53-S22 (pg. 62),
MST55-S22 (pg. 63)



**(-W12) Woven
Charcoal**

MST51-W12 (pg. 62),
MST52-W12 (pg. 62),
MST53-W12 (pg. 62),
MST55-W12 (pg. 63)

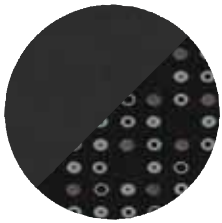

**(-K1R7) Black &
Onyx Fabric**

MST51-K1R7 (pg. 62),
MST52-K1R7 (pg. 62)



**(-K6R4) Buff &
Burch Fabric**

MST51-K6R4 (pg. 62),
MST52-K6R4 (pg. 62)

Item.....	Page	Item.....	Page	Item.....	Page	Item.....	Page
13-37N20D.....	37	848W.....	39	FL5380C-.....	54	OFD-7200-.....	52
15-37A720D.....	37	85640-30.....	42	FL5388C-.....	54	OFD-800-CPU.....	73
183305.....	45	85670-30.....	42	FL7480-U6.....	53	OFD-865-3.....	68
213-37N2F3D.....	37	8610-30.....	68	FL7481-U6.....	53	OFD-BC9601-.....	55
2300.....	33	8620-30.....	68	FL7484-U6.....	53	OFD-BC9602-.....	55
317-6C61F6-.....	30	86710-30.....	67	FL7485-U6.....	53	OFD-BC9603-.....	55
317-66C61F6-.....	30	86724-30.....	67	FL89675-U6.....	50	OFD-CUR-.....	62
317-ME36C61F6.....	30	86725-30.....	67	FL9097-U6.....	50	OFD-MIHR108M-.....	41
317W-W1C1F2W-.....	29	9333E.....	50	GI-100-.....	65	OFD-MIHR109F.....	41
317W-W11C1F2W.....	29	A15.....	37	GI-125-.....	65	OFD-SL8471.....	57
335-E37P918P.....	34	A27WA.....	37	GI-300C-.....	66	OFD-SL8472.....	57
39200.....	36	ALB43211-.....	72	GI-300E-.....	66	OFD-SL8473.....	57
39202.....	36	ATH51-.....	61	GI-300M-.....	66	OFD-TREX1-.....	73
39203.....	36	ATH52-.....	61	GI-400C-.....	66	OFD-TREX2-.....	73
518317HA-EC3.....	47	BRW29A4-.....	72	GI-400E-.....	66	OPH61606-EC3.....	51
51907VC-EC3.....	47	BRW3026A4-.....	72	GI-400M-.....	66	OXT43211-.....	72
519117HC-EC3.....	47	BRW3030A4-.....	72	K-129-.....	65	PAC51-.....	57
519117MC-EC3.....	47	BRW432-.....	72	K-99-.....	65	PAC52-.....	57
5200W.....	29	CI-800-.....	70	M-94-CHY.....	65	PAC53-.....	57
529-3R2N1F2.....	31	CI-825-.....	70	MI-1122-.....	42	PRD3060-.....	64
529-E3R2N1F2.....	31	CI-850-.....	70	MI-1500-30.....	42	PRD3060D-.....	64
529-R22N1F2.....	31	CI-875-.....	70	MI-1522-.....	42	PRD3085-.....	64
5500.....	32	CI-BAR30R-.....	71	MI-1800-3.....	44	PRD3230-.....	64
5505.....	33	CI-BAR30SQ-.....	71	MI-2102-.....	41	PRD3248-.....	64
5540.....	34	CI-BAR36R-.....	71	MI-2502-.....	41	PRD3260-.....	64
55403.....	34	CI-BAR36SQ-.....	71	MI-2817.....	44	PRD42RT-.....	64
5700E.....	33	CI-BAR-X30R-.....	71	MI-28174.....	44	S-129-.....	65
63-37A773HM.....	35	CI-BAR-X30SQ-.....	71	MI-4102-3.....	44	S-99-.....	65
69906-3.....	44	CI-BAR-X36R-.....	71	MI-8810W-.....	30, 43	SI-1104-231.....	67
7270.....	46	CI-BAR-X36SQ-.....	71	MI-93720.....	41	SI-1106-3.....	69
7271.....	46	CI-BREAK30R-.....	71	MI-95672-.....	43	SI-1107-3.....	69
7275.....	46	CI-BREAK30SQ-.....	71	MI-95673-.....	43	SL9801-EC3.....	56
73029LT.....	48	CI-BREAK36R-.....	71	MI-95893.....	42	SL9802-EC3.....	56
73129LT.....	48	CI-BREAK36SQ-.....	71	MI-97720-30.....	41	SL9803-EC3.....	56
73529.....	48	CI-BREAK-X30R-.....	71	MI-97728-EC3.....	41	STC18A4-.....	69
73631.....	48	CI-BREAK-X30SQ-.....	71	MRG07R1-.....	63	STC8302C4-3.....	68
73632.....	48	CI-BREAK-X36R-.....	71	MRG09-.....	63	STC866C4-.....	69
73633.....	48	CI-BREAK-X36SQ-.....	71	MRG09S-.....	63	TI-1102-30.....	45
73638.....	48	DC2990-231.....	38	MRG12-.....	63	TI-2402-231.....	45
73639.....	48	DC2990V.....	38	MRG12SR1-.....	63	TR-101-.....	65
74023LT.....	48	DC51000N-231.....	38	MST12.....	63	TR-102-.....	65
74123LT.....	48	DC51000NV.....	38	MST19.....	63	W001-W050.....	78
74523.....	48	DC8309C.....	38, 67	MST51-.....	62	WD300-.....	66
74602LT.....	48	DOL06.....	69	MST52-.....	62	WST07.....	60
74603LT.....	48	DOL8302.....	69	MST53-.....	62	WST09.....	60
74608LT.....	48	DOL865.....	69	MST55-.....	63	WST12.....	60
74612LT.....	48	DVS51-.....	63	MUP51-.....	59	WST16.....	61
74613LT.....	48	EC1283C-EC3.....	36	NI-1000-30.....	39	WST17.....	60
74618LT.....	48	EC39890C-EC3.....	54	NI-1200-30.....	39	WST51A-.....	58
74638.....	48	EC39891C-EC3.....	54	NI-2000-30.....	39	WST51C-.....	58
74652.....	48	EC39895C-EC3.....	54	NI-2200-30.....	39	WST51LF.....	58
74653.....	48	EC6582-EC9.....	51	NI-84224T.....	40	WST51N-.....	58
74658.....	48	ECH68807-EC3.....	50	NI-84225T.....	40	WST51RF.....	58
75-37A773.....	35	ECH70537-EC3.....	50	NI-84226T.....	40	YLD07.....	61
75-47A773.....	35	ECH83507-EC3.....	50	NI-842HR24T.....	40	YLD09.....	61
818-31G9C18P.....	34	EM51022N-3.....	45	OFD-200-DR.....	73	YLD12.....	61
8200-3.....	46	FC8487-231.....	39	OFD-3030-3.....	69	YLD14.....	61
8201-3.....	46	FL1327C-.....	49	OFD-605-BLK.....	51	YLD17.....	61
8205-3.....	46	FL3422-U6.....	50	OFD-6583-.....	51		
82740-30.....	67	FL3835C-.....	49	OFD-6640-.....	46		
839-11B35WA.....	35	FL3836C-.....	49	OFD-7000-.....	52		
8455-30.....	68	FL4836C-.....	49	OFD-7100-.....	52		

Limited Lifetime Warranty

Items are warranted from the original purchase date and to the original purchaser for normal commercial usage – defined as a standard 40-hour work week and by persons weighing 250 lbs. or less, unless otherwise stated – according to the below-listed schedule and limitations.

desk it. (Wood & Laminate) nest it. (tables) connect it.

- 10 years against failure due to materials and workmanship
- Laminate finishes are covered for a period of 5 years.
- Veneer finishes are covered for a period of 3 years.
- Connect It Electrical - One year Limited Warranty, Base in Connection made by Licensed Electrician.
- Task Lights – One Year Limited Warranty
- Height Adjustable Electric Motors are covered for a period of 2 years, the bases for 5 years.
- 1 year on fabric and foam.

space it. big & tall it. raise it. nest it. (chairs) mesh it. task it. guest it. stack it.

- Lifetime on component chair parts including pneumatic cylinder, control mechanism, base and casters.
 - 3 years on upholstery fabric and foam against wear and deterioration.
 - Leather is not warranted against routine scratching and scuffing, as leather is subject to minor blemishes in use.
- The 839-11B35WA, 63-37A773HM, 75-37A773, 75-47A773, 39200, 39202, and 39203 are for persons weighing 400 lbs. or less, the 818-31G9C18P and TI-2402-231 are 300 lbs. or less, the 15-37A720D is 325 lbs. or less and the EC1283C-EC3 are 350 lbs. or less. When usage is more than 40 hours per week, a five year warranty on all parts applies. Fabric is warranted for one year.

screen it.

- 5 year warranty
- 2 years on component parts including pneumatic cylinders, control mechanisms, wood, plastic parts, base and casters.
- 1 year on upholstery fabric and foam against wear and deterioration.
- The 183305 is warranted for 200 lbs. weight limit. Recommended for residential use.

leather it. manage it.

- 15 years on all non-moving metal parts.
- 5 years on component parts including pneumatic cylinders, control mechanisms, wood, plastic parts, base and casters.
- 3 years on upholstery fabric and foam against wear and deterioration.
- Leather is not warranted against routine scratching and scuffing, as leather is subject to minor blemishes in use.

healthcare it.

- 5 Year warranty
- The OFD-BC9601 are for persons weighing 300 lbs. or less, the OFD-BC9602 are 400 lbs. or less and the OFD-BC9603 are 500 lbs. or less.

guest it. lounge it. accent it.

- 5 years on structural integrity of frame.
- 3 years on seating wood finishes.
- 3 years on upholstery fabric and Foam against wear and deterioration (except leather).
- Leather is not warranted against routine scratching and scuffing, as leather is subject to minor blemishes in use. Minor variations in color, texture and grain are a natural part of leather hides, and therefore, are not covered by this warranty.
- C.O.M. Fabrics are not warranted.

café it.

- 2 year warranty for parts.

cube it.

- 3 year warranty for fabric on all panel products.
- Task Light Bulbs and Ballasts are normal wear and tear replaceable parts, and are warranted for 1 year.

Grain, Color and Finishes

Variation of grain and color are natural, inherent characteristics of wood, a living material. This variation is part of the beauty of real wood and anticipated in wood veneer furnishings. Therefore, the Seller is not warranted to match in grain or color or texture. It is a natural phenomenon for wood grain to change in color as it ages, and wood finishes are not warranted for color-fastness.

The Seller will, at their discretion, repair or replace, to the original purchaser, any product that is defective in materials or workmanship, given normal use and care of single shift service, standard commercial usage, defined as a standard 8 hour work day, 5 days a week. Variations occurring in wood, fabric and other natural materials are inherent to their character and are not considered defects. This warranty does not cover: damage caused by transportation, cost of transportation or labor, freight, misuse, abuse, negligence, alteration, accident, vandalism, rusting, cosmetic damage that may result from normal use, acts of nature or any other event beyond the control of the Seller.

Limitation of Liability

Under no circumstance, including but not limited to breach of contract, breach of warranty of negligence, shall the Seller be liable for lost profits, loss of goodwill, stored data, general, special, consequential or exemplary damages, even if the Seller had notice of these damages or they were foreseeable. The Seller shall not be responsible for verifying customer's description of needs, data, or the fitness for a particular purpose of goods. The Seller's liability in all cases shall be limited to repair or replacement of the defective parts, or the purchase price of the product.

EXCEPT AS OTHERWISE PROVIDED, SELLER MAKES NO OTHER WARRANTIES, EXPRESSED OR IMPLIED, INCLUDING BUT NOT LIMITED TO THE WARRANTIES OF MERCHANTABILITY AND FITNESS FOR A PARTICULAR PURPOSE. PRICES SUBJECT TO CHANGE WITHOUT NOTICE.