

we're

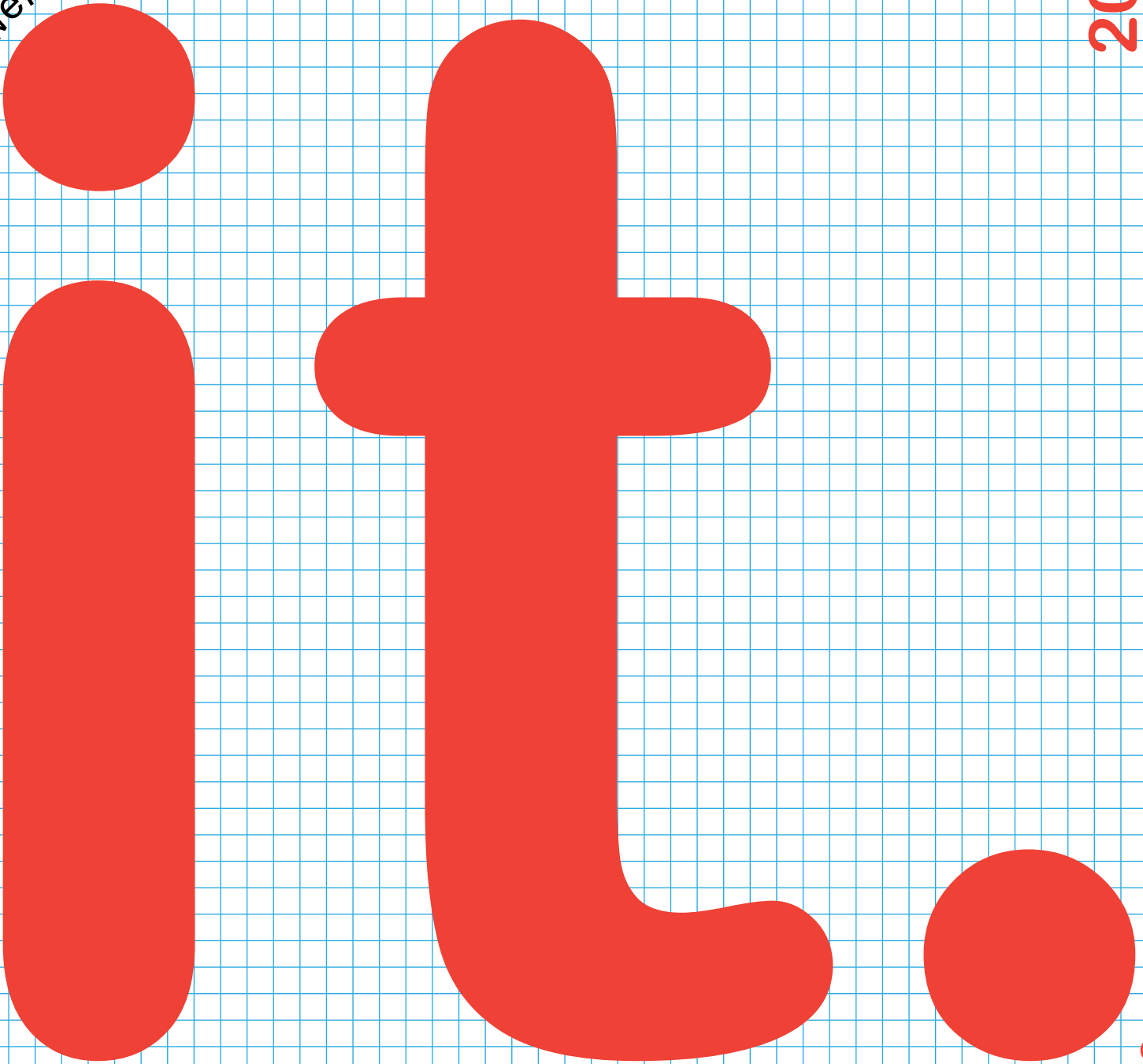

2017

office furnititure distributors

®

collaborate it.

Get connected with

connect **it.**

Perfect for our
Conference Room!

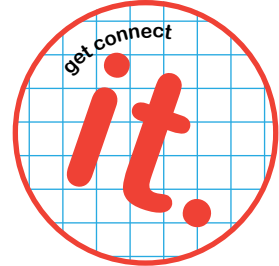

Great Colors!



we stock it.

desk it.	
Kent Series	2
Madison Series	5
Nexus Series	8
Ultra Series	11
collaborate it.	
connect it Series	14
bench it Series	19
lift it Series	23
space it.	28
big & tall it.	34
raise it.	36
train it.	38
nest it.	39
mesh it.	41
screen it.	45
task it.	45
leather it.	46
manage it.	47
healthcare it.	52
lounge it.	53
accent it.	59
guest it.	61
stack it.	63
café it.	66
add it.	69
cube it.	70
swatch it.	75
find it.	79
order it.	80

desk it.



Mahogany

- K-47GM Bullet Desk with Glass Modesty 72"x36"
- K-70 Bridge 48"x24"
- K-43 Credenza Shell 72"x20"
- K-44H Open Overhead Hutch 72"x14"
- K-4DG Glass Door Kit for Open Overhead Hutch
- K-75 File/File Ped for Credenza



LCH - Light Cherry



MAH - Mahogany



ESP - Espresso

Kent Series

Kent features genuine wood veneer surfaces, fluted edge styling and curved metal pulls for a beautiful compliment to any office environment. Choose from many contour shape surfaces for contemporary design solutions in offices, reception and conference areas. Tops feature common grain direction on all components of L- and U-shape workstations. All models feature select hardwood veneers crafted in traditional fashion and finished in Mahogany, Light Cherry, or Espresso multi-step finishes for subtle elegance.

Modular design allows for quick and easy changes and reconfigurations for long-term flexibility. Desk, return and credenza shells are non-handed for left or right use. Desk shells ship flat for easy handling and protection; simple assembly required. Pedestals are built fully assembled for immediate use – slide underneath shells or permanently mount.

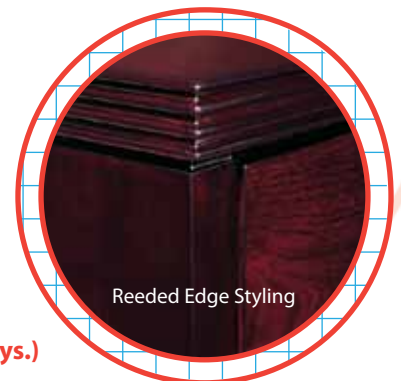

Reeded Edge Styling

2 we stock it.

(For all Kent Series Veneer, please allow 7-10 business days.)

LCH = Light Cherry MAH = Mahogany ESP = Espresso

Kent Series Typical



Light Cherry
 K-89 Bow Top Desk 72"x39"
 K-50 4-Door Credenza 72"x20"
 K-44H Open Overhead Hutch 72"x14"
 K-4DW Wood Door Kit for Open Overhead Hutch



Espresso
 K-89 Bow Top Desk Shell 72"x39"
 K-70 Bridge 48"x24"
 K-43 Credenza Shell 72"x20"
 K-44H Open Overhead Hutch 72"x14"
 K-4DG Glass Door Kit for Open Overhead Hutch
 K-75 File/File Ped for Credenza



Legal/letter filing with pre-installed hardware. Includes full-extension, steel ball-bearing drawer slide.



Single-key, full-locking pedestals are standard. Units keyed alike with multiple lock numbers available for an additional charge. Folding key design.



Elegant fluted edge design.



Desk pads or glass recommended for protection of wood veneer surfaces.



Bow Top Desk
 72"x39"
KTYP1
 27.3 cu.ft. - 295 lbs.
 Consists of: K-89, 65, 74
List \$3,250



Double Ped Desk
 72"x36"
KTYP2
 26.5 cu.ft. - 291 lbs.
 Consists of: K-01, 65, 74
List \$3,180



Double Lateral File Credenza
 72"x20"
KTYP7
 34.7 cu.ft. - 287 lbs.
 Consists of: K-43, 68, 68
List \$3,700



L-Shape
 66"x78"
KTYP9
 27.7 cu.ft. - 326 lbs.
 Consists of: K-02, 65, 45, 75
List \$3,720



Executive Office
 72"x107"
KTYP11
 57.5 cu.ft. - 642 lbs.
 Consists of: K-89, 65,
 74, 43, 66, 75, 44H, 4DW
List \$7,725



U-Shape w/Hutch
 72"x107"
KTYP12
 47.5 cu.ft. - 582 lbs.
 Consists of: K-89, 65,
 70, 43, 75, 44H, 4DW
List \$6,890



Reception Station
 72"x72"x43"
KTYP19
 37.2 cu.ft. - 472 lbs.
 Consists of: K-122, 65,
 125, 75, 124
List \$5,005



Bullet L-Shape
 72"x84"
KTYP30
 18 cu.ft. - 276 lbs.
 Consists of: K-47GM,
 45, 75
List \$3,060



Bullet U-Shape
 72"x104"
KTYP31
 22.3 cu.ft. - 382 lbs.
 Consists of: K-47GM,
 70, 43, 75
List \$4,070



8' Racetrack Table
K-60
 21.5 cu.ft. - 201 lbs.
List \$2,200



4' Round Table
K-59
 15.2 cu.ft. - 107 lbs.
List \$1,415

Great Buy!



(For all Kent Series Veneer, please allow 7-10 business days.)

*Measurements are rounded to the nearest inch. For exact dimensions, please call.

we stock it. 3

Kent Series

LCH = Light Cherry MAH = Mahogany ESP = Espresso

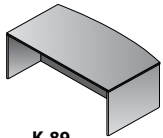

K-89
72"x39"x29"
Bow Top
Desk Shell
List \$1,635

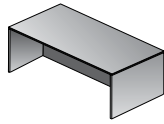

K-01
72"x36"x29"
Desk Shell
List \$1,565

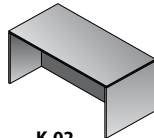

K-02
66"x30"x29"
Desk Shell
List \$1,335

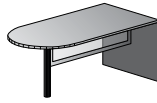

K-47GM
72"x36"x29"
Bullet
List \$1,555

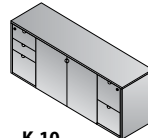

K-10
72"x20"x29"
Storage Credenza
Ships Assembled
List \$3,000

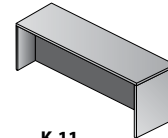

K-11
66"x20"x29"
Credenza Shell
List \$1,060

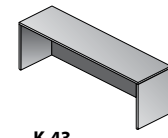

K-43
72"x20"x29"
Credenza Shell
List \$1,150

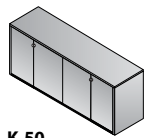

K-50
72"x20"x29"
4-Door Credenza
List \$2,295

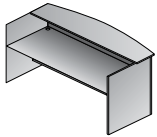

K-122
72"x30"/36"x43"
Reception Desk
List \$2,110

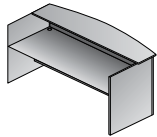

K-122GM
72"x30"/36"x43"
Reception Desk
(Glass Top)
List \$2,240

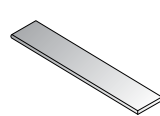

K-124
60"x12.5"x1"
Counter for Return
List \$400

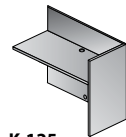

K-125
42"x20"x42"
Reception Return
List \$885

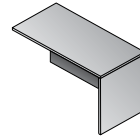

K-45
48"x24"x29"
Return Shell
List \$775

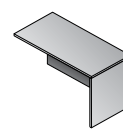

K-96
42"x24"x29"
Return Shell
List \$685

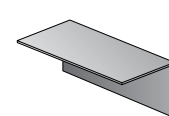

K-70
48"x24"x29"
Bridge
List \$635

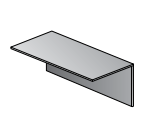

K-98
42"x24"x29"
Bridge
List \$575

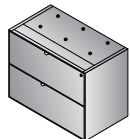

K-68
35"x18"x27"
Lateral File Ped
Ships Assembled
List \$1,275

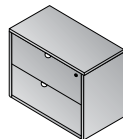

K-12
37"x20"x29"
Lateral File
Ships Assembled
List \$1,625

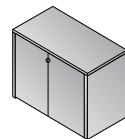

K-13
37"x20"x29"
Storage Cabinet
List \$1,470

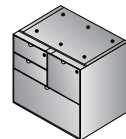

K-69
32"x18"x27"
Combo File Ped
Ships Assembled
List \$1,525

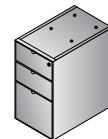

K-65
15.5"x24"x27"
BBF Ped - Desk
Ships Assembled
List \$880

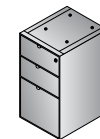

K-66
15.5"x18"x27"
BBF Ped - Credenza/Return
Ships Assembled
List \$735

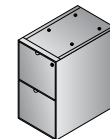

K-74
15.5"x24"x27"
FF Ped - Desk
Ships Assembled
List \$735

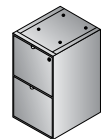

K-75
15.5"x18"x27"
FF Ped - Credenza/Return
Ships Assembled
List \$730

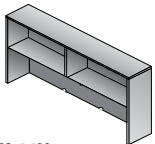

K-44H
72"x14"x42"
Open Overhead Hutch
List \$1,625

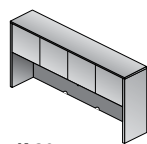

K-39
66"x14"x42"
Overhead Hutch
w/wood doors
List \$1,600

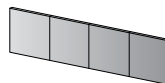

K-4DW
Wood Door Kit for
Open Overhead Hutch
List \$235

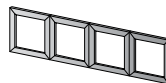

K-4DG
Glass Door Kit for
Open Overhead Hutch
List \$550

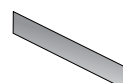

K-TACK67
Black Fabric
Tackboard
for K-44H Overhead
List \$240

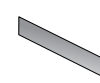

K-TACK63
Black Fabric
Tackboard
for K-39 Overhead
List \$235

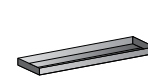

OFD-LED.20
Task Light
for Overhead/Shelf
List \$240

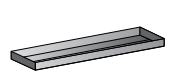

OFD-LED.38
Task Light
for Overhead/Shelf
List \$270

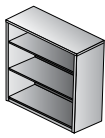

K-55
36"x14"x42"
Bookcase/
Open Hutch
List \$1,085

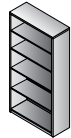

K-56
36"x14"x70"
5-Shelf Bookcase
List \$1,525

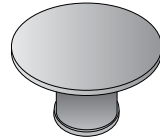

K-58
42" Dia. x29"H
Round Table
List \$1,275

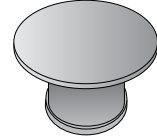

K-59
48" Dia. x29"H
Round Table
List \$1,415

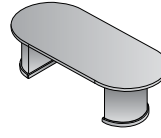

K-35
72"x36"x29"
6' Racetrack Table
List \$1,785

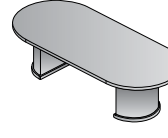

K-60
96"x42"x29"
8' Racetrack Table
List \$2,200

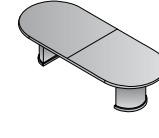

K-61
120"x48"x29"
10' Racetrack Table
List \$2,850

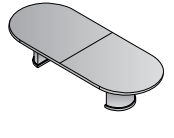

K-62
144"x48"x29"
12' Racetrack Table
List \$3,900

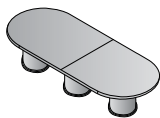

K-63
168"x48"x29"
14' Racetrack Table
List \$4,600

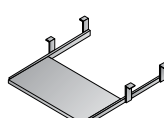

K-14
26"x12"
Keyboard Tray
List \$135

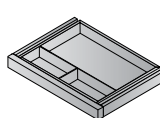

K-15
20"x14"
Center Drawer
List \$135

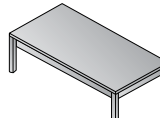

K-19
48"x24"x16"
Coffee Table
List \$665

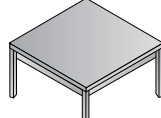

K-20
24"x24"x20"
End Table
List \$475

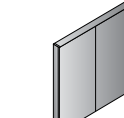

K-100
48"x4"x48"
Presentation Board
Ships Assembled
List \$1,525



OSP0001-OSP0050
Lock Core
and Keys
List \$25



- Cherry**
(MTYP13CHY)
M-89 Bow Desk Top/Mod Set 72"x42"
M-65 Box/Box/File Ped for 72"/84" Desk
M-71 False Ped for 72"/84" Desk
M-70 Bridge Top/Mod Set 49.5"x24"
M-43 Credenza Top/Mod Set 72"x24"
M-73 False Ped for Credenza
M-75 File/File Ped for Credenza/Return
M-84 Glass Door Hutch 72"x16"
M-12 Lateral File 36"x24"
M-55 Bookcase/Open Hutch 36"x16"

CHY - Satin Cherry FMAH - Figured Mahogany

Madison Series

A design for the connoisseur, Madison blends executive style, scale and characteristics with the beauty of wood craftsmanship. Hardwood veneers are carefully selected and book-matched for the natural beauty of wood. Contrasting inlay accents the design. Tops feature common grain direction on all components of L- and U-shape workstations. Returns and bridges feature reverse-cope, multistep edges for smooth work surface connections.

Executive details include 79" vertical storage heights, glass-door display hutch with light kit, and available legal-width pedestals. Conference tables feature contemporary round and racetrack tops paired with full and half-cylinder bases with veneer surfaces and solid hardwood floor-level trim.

Satin Cherry finish features subtle sheen and American cherry veneer work surfaces. Figured Mahogany finish features low sheen work surfaces.



(For all Madison Series Veneer, please allow 7-10 business days.)

we stock it. 5

Madison Series Typicals

CHY = Satin Cherry FMAH = Figured Mahogany



Cherry
M-04 Table Desk with Bow Front 72"x42"
M-10 Storage Credenza 72"x24"
M-84 Glass Door Hutch 72"x16"



Figured Mahogany Desk Top



Legal/letter filing with pre-installed hardware. Includes full-extension, steel ball-bearing drawer slide.



Single-key, full-locking pedestals are standard. Units keyed alike with multiple lock numbers available for an additional charge. Folding key design.



Contrasting inlay accents the design.



Desk pads or glass recommended for protection of wood veneer surfaces.



Bow Top Desk
72"x42"
MTYP1
37.8 cu.ft. - 372 lbs.
Consists of: M-89, 65, 74
List \$4,830



Double Ped Desk
72"x36"
MTYP2
36.8 cu.ft. - 352 lbs.
Consists of: M-01, 65, 74
List \$4,870



Double Ped Desk
66"x30"
MTYP3
27.6 cu.ft. - 272 lbs.
Consists of: M-02, 63, 63
List \$3,985



Kneespace Credenza
72"x24"
MTYP5
23.1 cu.ft. - 254 lbs.
Consists of: M-43, 66, 75
List \$3,400



L-Shape w/Bow Desk
72"x90"
MTYP8
51.7 cu.ft. - 463 lbs.
Consists of: M-89, 65, 71, 45, 75
List \$6,175



L-Shape
72"x84"
MTYP9
50.7 cu.ft. - 441 lbs.
Consists of: M-01, 65, 71, 45, 75
List \$6,215



Executive Office
MTYP11
100.1 cu.ft. - 864 lbs.
Consists of: M-89, 65, 74, 43, 66, 75, 84
List \$11,430



U-Shape w/Hutch
72"x115"
MTYP12
105.8 cu.ft. - 818 lbs.
Consists of: M-89, 65, 71, 70, 43, 73, 75, 44
List \$10,865



U-Shape w/Hutch + Storage
108"x115"
MTYP13
130.3 cu.ft. - 1,108 lbs.
Consists of: M-89, 65, 71, 70, 43, 73, 75, 84, 12, 55
List \$14,940



Reception Station
72"x90"
MTYP19
56.5 cu.ft. - 565 lbs.
Consists of: M-01, 65, 71, 45, 75, 127, 128
List \$8,580



4' Round Table
M-59
13 cu.ft. - 99 lbs.
List \$2,075



8' Conference Table
M-60
21 cu.ft. - 190 lbs.
List \$3,495

CHY = Satin Cherry FMAH = Figured Mahogany

Madison Series

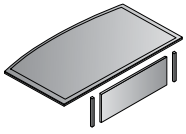

M-89
72"x42"x30"
72" Bow Desk Top/
Mod Set
List \$1,920



M-01
72"x36"x30"
Desk Top/Mod Set
List \$1,960



M-02
66"x30"x30"
Desk Top/Mod Set
List \$1,415

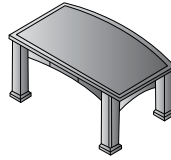

M-04
72"x42"x30"
Table Desk
List \$3,675

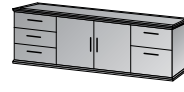

M-10
72"x24"x30"
Storage Credenza
Ships Assembled
List \$4,255

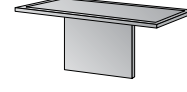

M-43
72"x24"x30"
Credenza Top/Mod Set
List \$1,300

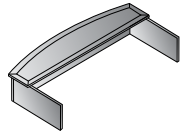

M-127
72"x35"x13"
Reception Unit Main
List \$1,445

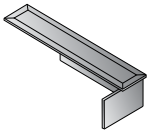

M-128
71.5"x24"x13"
Reception Unit Return
List \$920

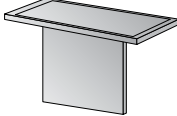

M-45
48.5"x24"x30"
Return Top/Mod Set
List \$950

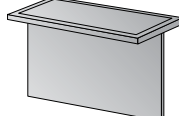

M-70
49.5"x24"x30"
Bridge Top/Mod Set
List \$1,045



M-65
20"x35.5"x28"
BBF Ped-72"/84" Desk
Ships Assembled
List \$1,465



M-63
17"x29.5"x28"
BBF Ped-66" Desk
Ships Assembled
List \$1,285

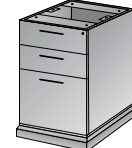

M-66
17"x23.5"x28"
BBF Ped-Credenza/Return
Ships Assembled
List \$1,075

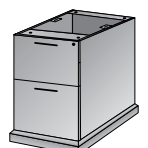

M-74
20"x35.5"x28"
FF Ped-72"/84" Desk
Ships Assembled
List \$1,445

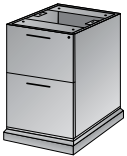

M-75
17"x23.5"x28"
FF Ped-Credenza/Return
Ships Assembled
List \$1,025

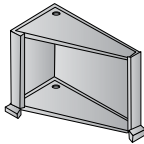

M-71
20"x35.5"x28"
False Ped-72"/84" Desk
Ships Assembled
List \$815

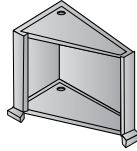

M-67
17"x29.5"x28"
False Ped-66" Desk
Ships Assembled
List \$655

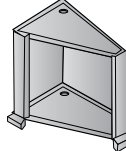

M-73
17"x23.5"x28"
False Ped-Credenza
Ships Assembled
List \$565

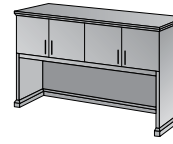

M-44
72"x16"x49"
Overhead-Wood Doors
List \$2,730



M-84
72"x16"x49"
Overhead-Glass Doors
List \$3,200



OFD-LED.20
Task Light
for 36" Overhead/Shelf
List \$240

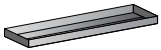

OFD-LED.38
Task Light
for 48" Overhead/Shelf
List \$270

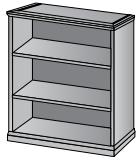

M-55
36"x16"x49"
Bookcase/Open Hutch
List \$1,470



M-56
36"x16"x79"
5-Shelf Bookcase
List \$1,735

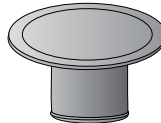

M-59
48" Dia. x29"H
Round Table
List \$2,075

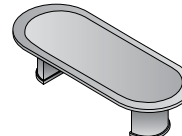

M-60
96"x42"x30"
Conference Table
List \$3,495

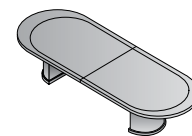

M-61
120"x48"x30"
Conference Table
List \$4,300

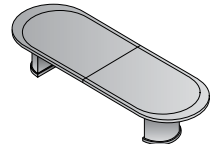

M-62
144"x48"x30"
Conference Table
List \$5,065

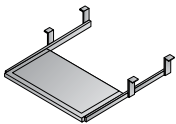

M-14
26"x12"
Keyboard Tray
List \$420

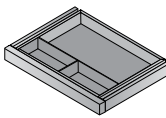

M-15
20"x16"
Center Drawer
List \$265

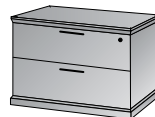

M-12
36"x24"x30"
Lateral File
Ships Assembled
List \$2,135

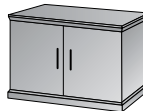

M-13
36"x24"x30"
Storage Cabinet
List \$1,855

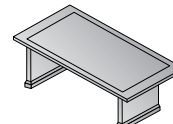

M-19
48"x24"x16"
Coffee Table
List \$905

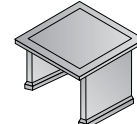

M-20
24"x24"x20"
End Table
List \$840

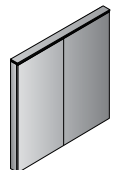

M-100
48"x6"x48"
Presentation Board
Ships Assembled
List \$2,310

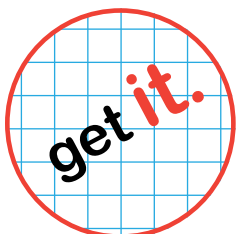

CHY - Satin Cherry



FMAH - Figured Mahogany

(For all Madison Series Veneer, please allow 7-10 business days.)

we stock it. 7

*Measurements are rounded to the nearest inch. For exact dimensions, please call.



Great Style and Value!

- Espresso
- N-89 Bow Top Desk Shell 72"x41"
- N-70 Bridge 48"x24"
- N-43 Credenza Shell 71"x24"
- N-65 Box/Box/File Ped
- N-44H Open Overhead Hutch 71"x15"
- N-4DG Glass Door Kit for Open Overhead Hutch
- N-12 Lateral File
- N-53 Open Hutch

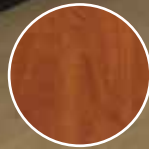

CHY - Cherry



MAH - Mahogany



ESP - Espresso

Nexus Reeded Edge Laminate Series

Nexus Series

Nexus is built to support today's businesses with solutions for offices, conference and reception areas that provide long-lasting furnishing value. From the executive and managers offices, to multi-person configurations, Nexus offers multiple solutions in popular Cherry, Mahogany, and Espresso colors with reeded edges.



Reeded Edge Styling

CHY = Cherry MAH = Mahogany ESP = Espresso

Nexus Series Typical



Bow Top Desk
71"x41"
NTYP1
21.3 cu.ft. - 325 lbs.
Consists of: N-89, 65, 74
List \$1,625



Double Ped Desk
71"x35"
NTYP2
20.4 cu.ft. - 314 lbs.
Consists of: N-01, 65, 74
List \$1,585



L-Shape w/Bow
71"x89"
NTYP8
25.1 cu.ft. - 416 lbs.
Consists of: N-89, 65, 45, 74
List \$1,970



L-Shape
66"x78"
NTYP9
22.9 cu.ft. - 379 lbs.
Consists of: N-02, 65, 45, 74
List \$1,810



Executive Office
NTYP11
47.3 cu.ft. - 740 lbs.
Consists of: N-89, 65, 74, 43, 65, 74, 44H, 4DW
List \$3,615



U-Shape w/Hutch
71"x113"
NTYP12
36.2 cu.ft. - 658 lbs.
Consists of: N-89, 65, 70, 43, 74, 44H, 4DW
List \$2,870



U-Shape w/Bullet
107"x72"
NTYP14
28.4 cu.ft. - 525 lbs.
Consists of: N-47, 70, 43, 65, 44H, 4DW
List \$2,330



Corner Workstation
90"x90"x65"
NTYP17
41.1 cu.ft. - 801 lbs.
Consists of: N-45, 74, 83, 45, 65, 34, 84, 34
List \$3,595



Reception Station
71"x71"x42"H
NTYP19
22.2 cu.ft. - 419 lbs.
Consists of: N-122, 80, 125, 80
List \$1,925



U-Shape
71"x113"
NTYP46
28.5 cu.ft. - 502 lbs.
Consists of: N-01, 65, 70, 43, 74
List \$2,255



L-Shape w/Bullet
71"x84"
NTYP30
15.7 cu.ft. - 279 lbs.
Consists of: N-47, 45, 74
List \$1,380



4' Round Table
N-23
4.7 cu.ft. - 94 lbs.
List \$595



8' Racetrack Table
N-36
11.04 cu.ft. - 155 lbs.
List \$765

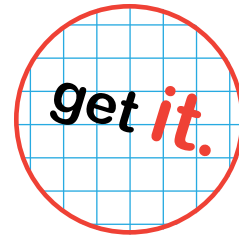

NTYP19

List \$1,925

Mahogany
N-122 Reception Desk 71"x42"
N-125 Reception Return 42"x41"
N-80 Hanging Ped (2)



Cherry
N-02 Straight Front Desk 66"x30"
N-45 Return 48"x24"
N-80 Hanging Ped (2)



Nexus Series

CHY = Cherry

MAH = Mahogany

ESP = Espresso

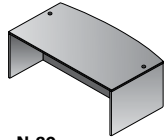

N-89
71"x41"x29"
Bow Top Desk Shell
List \$605

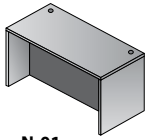

N-01
71"x36"x29"
Desk Shell
List \$565

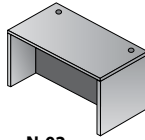

N-02
66"x30"x29"
Desk Shell
List \$445

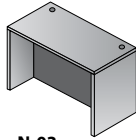

N-03
60"x30"x29"
Desk Shell
List \$425

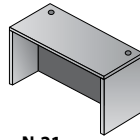

N-21
48"x30"x29"
Desk Shell
List \$405

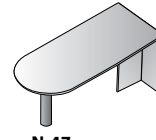

N-47
71"x36"x29"
Bullet
List \$550

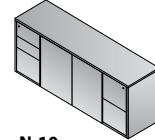

N-10
72"x22"x29"
Storage Credenza
List \$1,550

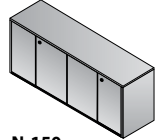

N-150
71"x24"x29"
Storage Credenza
List \$1,550

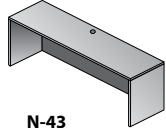

N-43
71"x24"x29"
Credenza Shell
List \$395

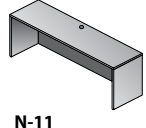

N-11
66"x24"x29"
Credenza Shell
List \$350

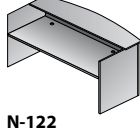

N-122
71"x30"/36"x42"
Reception Desk
List \$730

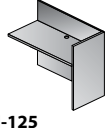

N-125
42"x24"x41"
Reception Return
List \$395

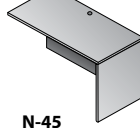

N-45
48"x24"x29"
Return Shell
List \$345

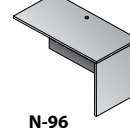

N-96
42"x24"x29"
Return Shell
List \$315

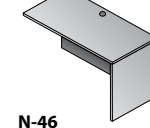

N-46
42"x20"x29"
Return Shell
(Use N-76 Pedestal)
List \$285

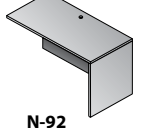

N-92
35"x24"x29"
Return Shell
List \$280

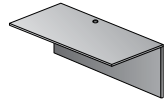

N-70
48"x24"x29"
Bridge
List \$275

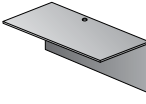

N-98
42"x24"x29"
Bridge
List \$245

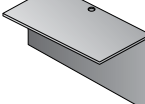

N-93
35"x24"x29"
Bridge
List \$220

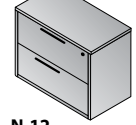

N-12
36"x22"x29"
Lateral File
Ships Assembled
List \$1,035

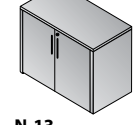

N-13
36"x22"x29"
Storage Cabinet
List \$475



N-69
31"x23"x29"
Combo File
Ships Assembled
List \$955



N-80
15.5"x22"x21"
Hanging Ped - Desk
Ships Assembled
List \$400

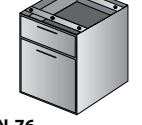

N-76
15.5"x18.5"x21"
Hanging Ped (for N-46)
Ships Assembled
List \$375

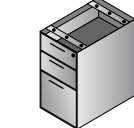

N-65
15.5"x22"x28"
BBF Ped
Ships Assembled
List \$535

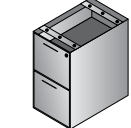

N-74
15.5"x20"x28"
FF Ped
Ships Assembled
List \$485

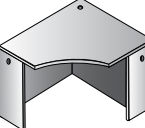

N-83
42"x42"x29"
Corner Unit
List \$430

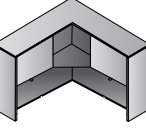

N-84
42"x42"x36"
Corner Hutch
List \$625

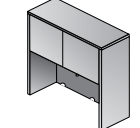

N-34
48"x15"x36"
Hutch w/Doors
List \$415

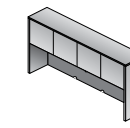

N-39
66"x15"x36"
Overhead Storage
w/Laminate Doors
List \$510

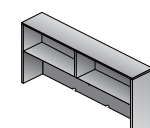

N-44H
71"x15"x36"
Open Overhead Hutch
List \$445

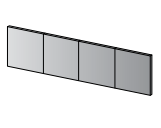

N-4DW
4-Door Laminate Kit
for Open Overhead
List \$130

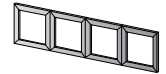

N-4DG
4-Door Glass Kit
for Open Overhead
Aluminum Frame
List \$420

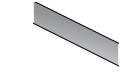

N-TACK44
Black Fabric
Tackboard for N-34
Overhead
List \$210

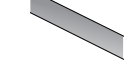

N-TACK63
Black Fabric
Tackboard for N-39
Overhead
List \$235



N-TACK67
Black Fabric
Tackboard for N-44H
Overhead
List \$240

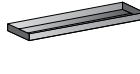

OFD-LED.20
Task Light
for Overhead/Shelf
List \$240



OFD-LED.38
Task Light
for Overhead/Shelf
List \$270



N-53
36"x14"x36"
Open Hutch
List \$325



N-55
36"x14"x42"
3-Shelf Bookcase
List \$395

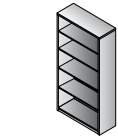

N-56
36"x14"x65"
5-Shelf Bookcase
List \$535

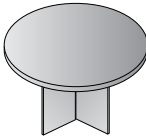

N-23
47" Dia. x29"H
Round Table
List \$595

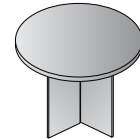

N-27
42" Dia. x29"H
Round Table
List \$565

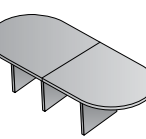

N-38N
144"x48"x29"
12' Racetrack Table
List \$1,525

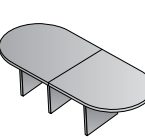

N-37N
120"x48"x29"
10' Racetrack Table
List \$1,045

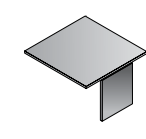

N-3738EXT
48"x48"x29"
Conference Table
Extension (for N-37N
and N-38N)
List \$550

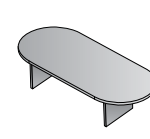

N-36
95"x44"x29"
8' Racetrack Table
List \$765

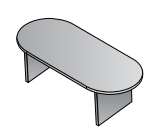

N-35
71"x35"x29"
6' Racetrack Table
List \$585

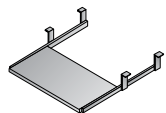

N-14
28"x14"
Keyboard Tray
List \$100

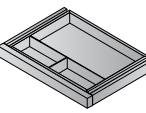

N-15
20"x15"
Center Drawer
List \$100



N-152
22.5"x24"x65"
Wardrobe Cabinet
Ships Assembled
List \$1,425

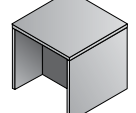

N-20
24"x24"x20"
End Table
List \$195

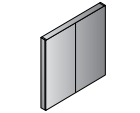

N-100
48"x4"x48"
Presentation Board
Ships Assembled
List \$625

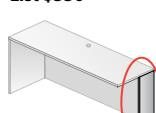

N-243LEG
28"x11"
Half Leg for Credenza/
Return Shell (LEG ONLY)
List \$85



UN401C-450C
Lock Core
and Keys
List \$25



Walnut Strand
 OFD-189 Bow Front Shell 36"/41" x 71"
 OFD-175 File/File Ped
 OFD-170 Bridge 48"x24"
 OFD-166 Box/Box/File Ped
 OFD-143 Credenza Shell 24 "x 71"
 OFD-144 Overhead Hutch 71"x36"
 OFD-4DG 4-Door Glass Kit



CHE - Cherry



MAH - Mahogany



ESP - Espresso



WAL - Walnut Strand

Contemporary Laminate Series

Ultra Laminate Series

Distinguish your office with the sophisticated look of the Ultra Laminate Series. They are thermally fused laminates with 3mm PVC, dura-edge detailing on all exposed edges. All peds are fully assembled, reversible and lockable. Ultra offers full modesty panels and full ball-bearing suspension. Colors of the Ultra Laminate include Cherry, Mahogany, Espresso and Walnut Strand.

Great Value!
get it.

desk it.

Ultra Laminate Series Typicals

CHE = Cherry MAH = Mahogany ESP = Espresso WAL = Walnut Strand



Bow Top Desk
71"x41"
UTYP1
21.3 cu.ft. - 347 lbs.
Consists of: OFD-189,
166, 175
List \$1,305



Double Ped Desk
71"x36"
UTYP2
20.4 cu.ft. - 336 lbs.
Consists of: OFD-101,
166, 175
List \$1,270



L-Shape w/Hanging Peds
71"x77"
UTYP8
20.4 cu.ft. - 361 lbs.
Consists of: OFD-101, 146,
107, 107
List \$1,275



L-Shape
66"x78"
UTYP9
22.9 cu.ft. - 379 lbs.
Consists of: OFD-102, 166,
145, 175
List \$1,505



Bullet U-Shape
71"x108"
UTYP10
22.9 cu.ft. - 418 lbs.
Consists of: OFD-147, 170,
143, 166
List \$1,365



Executive Office
UTYP11
52.3 cu.ft. - 761 lbs.
Consists of: OFD-189,
166, 175, 143, 166, 175,
144, 4DW
List \$3,055



U-Shape w/Hutch
71"x113"
UTYP12
36.2 cu.ft. - 658 lbs.
Consists of: OFD-189, 166,
175, 143, 170, 144, 4DW
List \$2,425



Reception Station
71"x71"x42"H
UTYP19
22.2 cu.ft. - 419 lbs.
Consists of: OFD-169, 180,
107, 107
List \$1,600



Straight Front U-Shape set
71"x108"
UTYP21
35.2 cu.ft. - 620 lbs.
Consists of: OFD-101, 170,
143, 144, 4DW, 175, 166
List \$2,390



Bullet L-Shape
84"x71"
UTYP27
17.7 cu.ft. - 307 lbs.
Consists of: OFD-147, 145,
166
List \$1,085



8' Conference Table
OFD-136
12.06 cu.ft. - 206 lbs.
List \$635



12' Conference Table
OFD-138T
12.19 cu.ft. - 269 lbs.
List \$1,450



4' Round Table
OFD-123
6.79 cu.ft. - 93 lbs.
List \$405

Just what we are looking for!

UTYP10

List \$1,365

Espresso
OFD-147 Bullet Desk 71"x36"
OFD-170 Bridge 48"x24"
OFD-143 Credenza Shell 71"x24"
OFD-166 Box/Box/File Ped



UTYP19

List \$1,600

Cherry
OFD-169 Reception Desk Shell 71"x30"
OFD-180 Reception Return Shell 42"x24"
OFD-107 Hanging Ped (2 qty.)



(All Ultra hutches do not include tackboard.)

12 we stock it.

*Measurements are rounded to the nearest inch. For exact dimensions, please call.

CHE = Cherry MAH = Mahogany ESP = Espresso WAL = Walnut Strand

Ultra Laminate Series

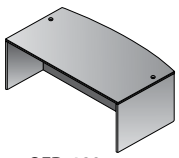

OFD-189
71"x41"x29"
Bow Desk Shell
List \$465

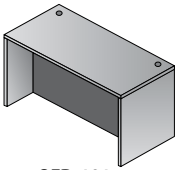

OFD-101
71"x36"x29"
Desk Shell
List \$430

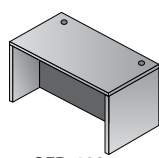

OFD-102
66"x30"x29"
Desk Shell
List \$400

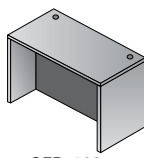

OFD-103
60"x30"x29"
Desk Shell
List \$305

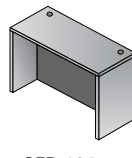

OFD-104
48"x24"x29"
Desk Shell
List \$265

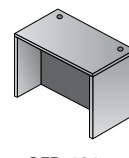

OFD-121
48"x30"x29"
Desk Shell
List \$285

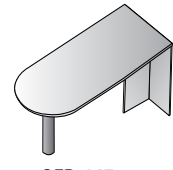

OFD-147
71"x36"x29"
Bullet
List \$400



OFD-131
66"x30"x29"
Bullet
List \$350

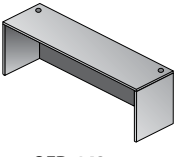

OFD-143
71"x24"x29"
Credenza Shell
List \$335

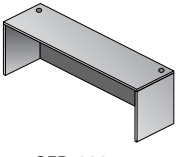

OFD-111
66"x24"x29"
Credenza Shell
List \$300

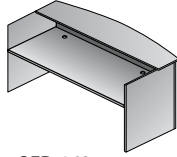

OFD-169
71"x30"/36"x42"
Reception Desk Shell
List \$680

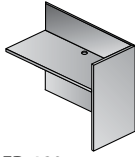

OFD-180
42"x24"x41"
Reception Return Shell
List \$310

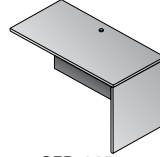

OFD-145
48"x24"x29"
Return Shell
List \$265

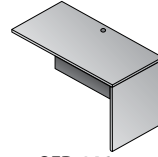

OFD-146
41"x24"x29"
Return Shell
List \$235

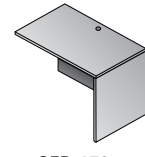

OFD-179
30"x24"x29"
Return Shell
List \$195

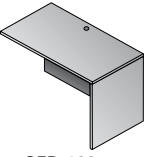

OFD-192
36"x24"x29"
Return Shell
List \$210

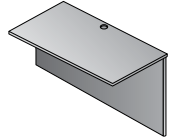

OFD-170
48"x24"x29"
Bridge
List \$210

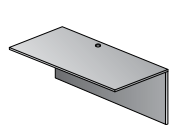

OFD-172
41"x24"x29"
Bridge
List \$195

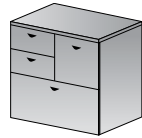

OFD-114
31"x22"x29"
Combo File
(has 3 locks)
Ships Assembled
List \$695



OFD-166
15"x22"x28"
BBF Ped-Desk
Ships Assembled
List \$420

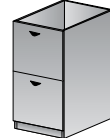

OFD-175
15"x22"x28"
FF Ped-Desk
Ships Assembled
List \$420

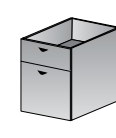

OFD-107
15"x18.5"x21"
Hanging Ped
Ships Assembled
List \$305

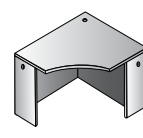

OFD-184
36"x36"x29"
Corner Unit
List \$390

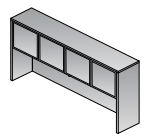

OFD-140
66"x15"x36"
Overhead Storage
w/Laminate Doors
List \$510

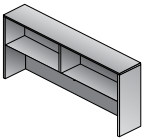

OFD-144
71"x15"x36"
Open Overhead
Hutch
List \$445

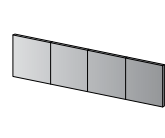

OFD-4DW
4-Door Laminate Kit
for Open Overhead
List \$130

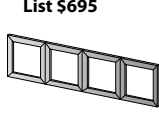

OFD-4DG
4-Door Glass Kit
for Open Overhead
List \$420



OFD-TACK63
Black Fabric Tackboard
for OFD-144 Overhead
List \$235

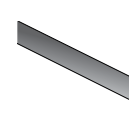

OFD-TACK67
Black Fabric Tackboard
for OFD-144 Overhead
List \$240

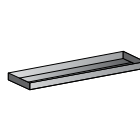

OFD-LED.20
Task Light
for Overhead/Shelf
List \$240

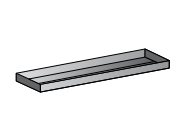

OFD-LED.38
Task Light
for Overhead/Shelf
List \$270

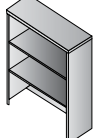

OFD-163
36"x14"x35"
Open Hutch
List \$275

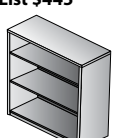

OFD-155
35.4"x14"x42"
3-Shelf Bookcase
List \$290



OFD-156
35.4"x14"x65"
5-Shelf Bookcase
List \$400

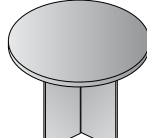

OFD-123
47" Dia. x29"H
Round Table
List \$405



OFD-127
42" Dia. x29"H
Round Table
List \$380

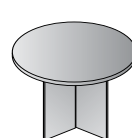

OFD-128
36" Dia. x29"H
Round Table
List \$345

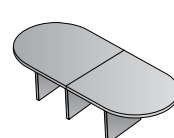

OFD-138T
144"x48"x29"
Conference Table
List \$1,450

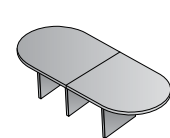

OFD-137T
120"x48"x29"
Conference Table
List \$995

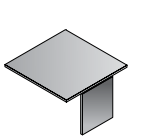

OFD-13738EXT
48"x48"x29"
Conference Table
Extension (for OFD-137
and OFD-138)
List \$500

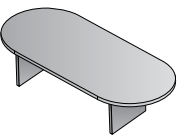

OFD-136
95"x44"x29"
Conference Table
List \$635

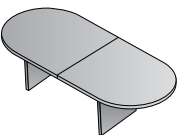

OFD-136-2
95"x44"x29"
2 Piece Conference Table
List \$635

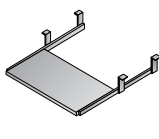

OFD-14
27"x12.75"
Keyboard Tray
List \$100

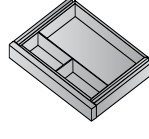

OFD-185
20"x15"
Center Drawer
List \$100

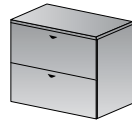

OFD-112
36"x22"x29"
Lateral File
List \$685

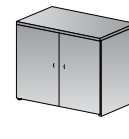

OFD-113
35.5"x22"x29"
2-Door Cabinet
List \$390



OFD-187
36"x22"x57"
4-Drawer Lateral
List \$1,200

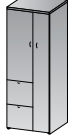

OFD-207
24"x24"x65"
Wardrobe Cabinet
(has 3 locks)
List \$1,075

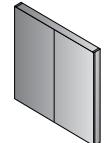

OFD-100
47.5" x 47.5"
Visual Board
List \$610

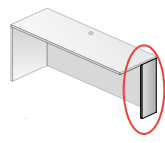

OFD-243LEG
28"x11"
Half Leg for Credenza/
Return Shell (LEG ONLY)
List \$85



UN401L-450C
Lock Core
and Keys
List \$25



Connect it Series

Connect it is a new look for the workplace that combines functionality with a contemporary style. This is a desking/benching system that can be used free standing or combined with our new segmented panel system. Free design and space planning available.

The typical shown above provides a functional work area complete with segmented panels and power capability, drop down lateral files as well as mobile pedestals with cushions to compliment the overall design. Glass and acrylic screens, high pressure laminate work surfaces and fabric cushions are available with several choices. Metal tiles for panels, lateral files and pedestals are all metal and available in white or brushed silver.

Get connected with



Connect it Series | Typical Workstations

OFD-CITYP13
4-Pod Benching Workstation
24"x48" Work Surface each Station
Includes Acrylic Screens
List \$3,076



Perfect Telemarketing plan!!

OFD-CITYP14
2-Pod Workstation
6'x6' each Station: 24"x72" Main, 18"x72" Dropdown Work Surface
Includes Lateral Files with Cushions, Mobile Peds with Cushions, Acrylic Screens and Panels
List \$8,914
Optional Power Available.



OFD-CITYP1
Level Station 24"x60" Main, 24"x48" Return
5'x6'
Includes BBF Ped
List \$1,230

OFD-CITYP2
Level Station 24"x66" Main, 24"x48" Return
5.5'x6'
Includes BBF Ped
List \$1,325

OFD-CITYP3
Level Station 24"x72" Main, 24"x48" Return
6'x6'
Includes BBF Ped
List \$1,335



Great value!

OFD-CITYP24
Level Station 30"x60" Main, 24"x42" Return
5'x6'
Includes BBF Ped and FF Ped
List \$1,688

OFD-CITYP25
Level Station 30"x66" Main, 24"x42" Return
5.5'x6'
Includes BBF Ped and FF Ped
List \$1,738

OFD-CITYP26
Level Station 30"x72" Main, 24"x42" Return
6'x6'
Includes BBF Ped and FF Ped
List \$1,748



OFD-CITYP7
Level Station 24"x72" Main with Screen, 24"x48" Return
6'x6'
Includes BBF Ped and Acrylic Screen
List \$1,800



OFD-CITYP30
2-Pod Workstation
6'x6' each Station
Includes Lateral Files with Cushions, Frosted Glass and Panels
List \$5,961
Optional Power Available.



OFD-CITYP11
4-Pod Benching Workstation
24"x72" Work Surface each Station
Includes Mobile Peds with Cushions, and Acrylic Screens
List \$6,562



OFD-CITYP31
4-Pod Workstation
6'x6' each Station
Includes Lateral Files with Cushions, Screens, Frosted Glass and Panels
List \$14,617
Optional Power Available.



All screens, glass or acrylic, are optional. Wire management troughs included with work surfaces.
All electric options available, please call for specification and pricing.

Connect it Series | Typical Workstations

OFD-CITYP18
4-Pod Workstation
 6'x6' each Station
 Includes Lateral Files with Cushions and Acrylic Screens
List \$9,830



OFD-CITYP19
3-Pod Workstation
 120 Degree each Station
 Includes Mobile Peds with Cushions and Acrylic Screens
List \$6,555



OFD-CITYP17
Cube Workstation
 6'x6' Station
 Includes Panels, Frosted Glass and BBF Ped.
 Free-standing Work Surfaces
List \$6,537



OFD-CITYP15
Executive U-Set
 36"x72" Main
 Includes BBF and FF Ped
List \$2,555



OFD-CITYP16
6-Pod Workstation
 120 Degree each Station
 Includes Mobile Peds with Cushions and Acrylic Screens
List \$13,110



This is a favorite!

Connect it Series

Rectangle Work Surfaces - Laminate

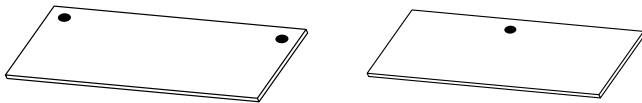

- OFD-CI7236WS - 72"x36" with Wire Mgt Trough, (2) Grommet Holes List \$464
- OFD-CI7224WS - 72"x24" with Wire Mgt Trough, (2) Grommet Holes List \$445
- OFD-CI7230WS - 72"x30" with Wire Mgt Trough, (2) Grommet Holes List \$450
- OFD-CI6624WS - 66"x24" with Wire Mgt Trough, (2) Grommet Holes List \$435
- OFD-CI6630WS - 66"x30" with Wire Mgt Trough, (2) Grommet Holes List \$440
- OFD-CI6024WS - 60"x24" with Wire Mgt Trough, (2) Grommet Holes List \$340
- OFD-CI6030WS - 60"x30" with Wire Mgt Trough, (2) Grommet Holes List \$390

NEW!

- OFD-CI4830WS - 48"x30" with Wire Mgt Trough, (1) Grommet Hole List \$350
- OFD-CI4824TWS - 48"x24" with Wire Mgt Trough, (1) Grommet Hole..... List \$279

120° Work Surface - Laminate

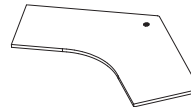

- OFD-CI1202448WS - 120° 24"x48"x48"x24" with (2) Wire Mgt Troughs..... List \$730

Rectangle Work Surfaces-Drop Down Storage - Laminate

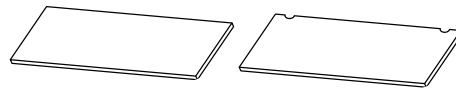

- OFD-CI7218WS - Work Surface for Drop Down 72"x18" List \$269
- OFD-CI7219WS - Work Surface, (2) Half Grommets for Drop Down 72"x19" ... List \$280

Rectangle Return Work Surfaces - Laminate

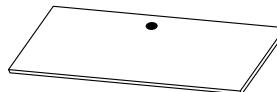

- OFD-CI4824WS - Return Work Surface 48"x24" with 2 1/4 Grommet Hole..... List \$225
- OFD-CI4224WS - Return Work Surface 42"x24" with 2 1/4 Grommet Hole..... List \$220

Connect it Series

Front Mount Screens - Sea Board

NEW!

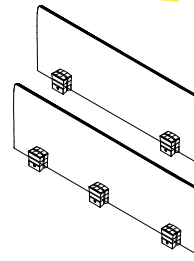

- OFD-CI1222SB**
Sea Board Privacy Screen for 24" Work Surface, 12"Hx22"W
List \$85
- OFD-CI1246SB**
Sea Board Privacy Screen for 48" Work Surface, 12"Hx46"W
List \$145
- OFD-CI1270SB**
Sea Board Privacy Screen for 72" Work Surface, 12"Hx70"W
List \$175
- OFD-CI1228SB**
Sea Board Privacy Screen for 30" Work Surface, 12"Hx28"W
List \$115
- OFD-CI1258SB**
Sea Board Privacy Screen for 60" Work Surface, 12"Hx58"W
List \$155
- OFD-CI1264SB**
Sea Board Privacy Screen for 66" Work Surface, 12"Hx64"W
List \$165

(Includes Top Mounting Brackets, (2) for 24" & 30", and (3) for all others) See Finish Page for 5 Color Options. (Pg. 22)

Panel Frames

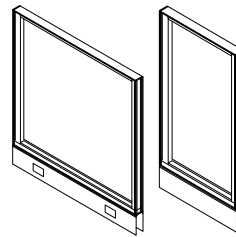

- OFD-CI3936N**
Panel Frame 36"x39", Black Raceway Covers
List \$268
- OFD-CI3918N**
Panel Frame 18"x39", Black Raceway Covers
List \$227
- OFD-CI3936E**
Panel Frame with Power 36"x39", Black Raceway Covers
List \$379

Panel Tiles

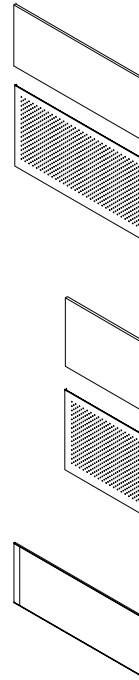

- OFD-CIMT3614-BS**
Metal Tile 36"x14", Brushed Silver
List \$59
- OFD-CIMP3618-BS**
Metal Perforated Tile for Lower 36"x18", Brushed Silver
List \$82
- OFD-CIMT1814-BS**
Metal Tile 18"x14", Brushed Silver
List \$39
- OFD-CIMP1818-BS**
Metal Perforated Tile for Lower 18"x18", Brushed Silver
List \$47
- OFD-CIMGB3614-FG**
Marker/Magnetic Glass Tile 36"x14", (Fits Top Tile on 36" Panel)
White
List \$280
- OFD-CIMT3614-WH**
Metal Tile 36"x14", White
List \$59
- OFD-CIMP3618-WH**
Metal Perforated Tile for Lower 36"x18", White
List \$82
- OFD-CIMT1814-WH**
Metal Tile 18"x14", White
List \$39
- OFD-CIMP1818-WH**
Metal Perforated Tile for Lower 18"x18", White
List \$47

Support Leg

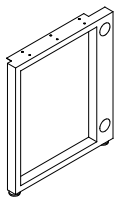

- OFD-CIOLEG24L** - Support Leg 24" Left, Brushed Silver List \$140
- OFD-CIOLEG24R** - Support Leg 24" Right, Brushed Silver List \$140
- OFD-CIOLEG30L** - Support Leg 30" Left, Brushed Silver List \$154
- OFD-CIOLEG30R** - Support Leg 30" Right, Brushed Silver List \$154
- OFD-CIOLEG36L** - Support Leg 36" Left, Brushed Silver List \$180
- OFD-CIOLEG36R** - Support Leg 36" Right, Brushed Silver List \$180

Drop Down Work Surface Support

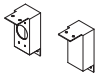

- OFD-CILWS** - Drop Down Work Surface Support, Brushed Silver List \$57

Triangle Leg Support



- OFD-CITL120** - Triangle Leg for 120° Top, Brushed Silver List \$72

Frosted Glass Privacy Screens



- OFD-CISGFG**
Frosted Glass Privacy Screen for 34"x10" Panel with Brackets
List \$129
 - OFD-DM1242**
Frosted Glass Privacy Screen for 48" Work Surface, 12"H
List \$275
 - OFD-DM1260**
Frosted Glass Privacy Screen for 66" Work Surface, 12"H
List \$365
 - OFD-DM1254**
Frosted Glass Privacy Screen for 60" Work Surface, 12"H
List \$325
 - OFD-DM1266**
Frosted Glass Privacy Screen for 72" Work Surface, 12"H
List \$400
- (Includes Top Mounting Brackets, (2) for 34" & 48", and (3) for all others)

NEW!

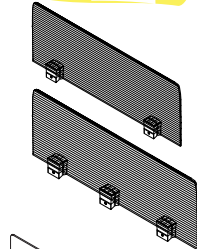

Acrylic Privacy/Modesty Screens

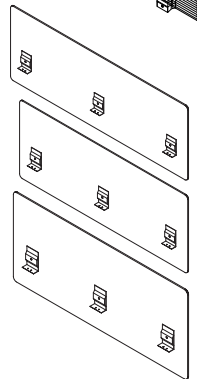

- OFD-CISCREEN72**
Acrylic Privacy/Modesty Screen for 72" Work Surface, 24"H
List \$465
- OFD-CISCREEN66**
Acrylic Privacy/Modesty Screen for 66" Work Surface, 24"H
List \$450
- OFD-CISCREEN48**
Acrylic Privacy/Modesty Screen for 48" Work Surface, 24"H
List \$420
- OFD-CISCREEN60**
Acrylic Privacy/Modesty Screen for 60" Work Surface, 24"H
List \$433

(Includes Mounting Brackets (3)) See Finish Page for 5 Color Options. (Pg. 22)

Top Mount Screens

NEW!

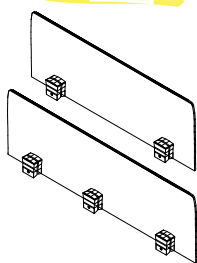

- OFD-CI1222A**
Acrylic Privacy Screen for 24" Work Surface, 12"Hx22"W
List \$125
- OFD-CI1246A**
Acrylic Privacy Screen for 48" Work Surface, 12"Hx46"W
List \$219
- OFD-CI1264A**
Acrylic Privacy Screen for 66" Work Surface, 12"Hx64"W
List \$275
- OFD-CI1228A**
Acrylic Privacy Screen for 30" Work Surface, 12"Hx28"W
List \$140
- OFD-CI1258A**
Acrylic Privacy Screen for 60" Work Surface, 12"Hx58"W
List \$260
- OFD-CI1270A**
Acrylic Privacy Screen for 72" Work Surface, 12"Hx70"W
List \$290

(Includes Top Mounting Brackets, (2) for 24" & 30", and (3) for all others) See Finish Page for 5 Color Options (Pg. 22)

Cord Managers

NEW!

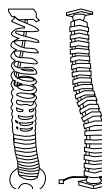

- OFD-COIL-BS** - For Floor to Work Surface, Coil Style, Brushed Silver List \$130
- OFD-COIL-B** - For Floor to Work Surface, Coil Style, Black List \$130
- OFD-SPINE-BS** - For Floor to Work Surface, Spine Style, Brushed Silver List \$135
- OFD-SPINE-B** - For Floor to Work Surface, Spine Style, Black List \$135

Connect it Series



Half Leg

- OFD-CIHALFLEG18-BS - 18" Half Leg, Brushed Silver List \$95
- OFD-CIHALFLEG18-WH - 18" Half Leg, White List \$95

Pedestals

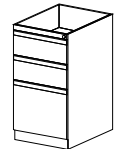

- OFD-BBF-BS
Box/Box/File
Pedestal 27.5"H,
Brushed Silver
List \$385

- OFD-BBF-WH
Box/Box/File
Pedestal 27.5"H,
White
List \$385

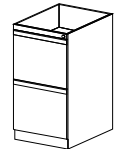

- OFD-FF-BS
File/File Pedestal
27.5"H, Brushed Silver
List \$385

- OFD-FF-WH
File/File Pedestal
27.5"H, White
List \$385

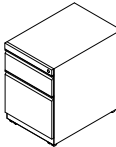

- OFD-CIBF-BS
Mobile Pedestal 22"H
Box/File, Brushed
Silver
List \$385

- OFD-CIBF-WH
Mobile Pedestal 22"H
Box/File, White
List \$385

Laterals

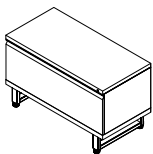

- OFD-CILF36-BS
36" Single Drawer
Lateral File, Brushed
Silver
List \$800

- OFD-CILF36-WH
36" Single Drawer
Lateral File, White
List \$800



- OFD-CIPMSB-BS
Panel Mount Support
Bracket, Brushed
Silver
List \$23

- OFD-CIPMSB-WH
Panel Mount Support
Bracket, White
List \$23

Cushions



- OFD-CICUSHBF - Cushion Top for Mobile B/F Pedestal List \$298
- OFD-CICUSHLAT36 - Cushion Top for Lateral List \$419

Conference O-Leg

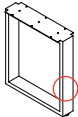

- OFD-CICONFOLEG24 - Conf O-Leg 24", Brushed Silver List \$225ea
4"W Frame

Conference Tables - 1½" Laminate

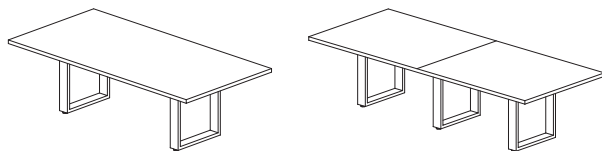

- OFD-CI44192CONF - 44"x192" Conf Table Top, Includes (5) 24" Legs List \$3,145
- OFD-CI44168CONF - 44"x168" Conf Table Top, Includes (5) 24" Legs List \$2,945
- OFD-CI44144CONF - 44"x144" Conf Table Top, Includes (3) 24" Legs List \$2,295
- OFD-CI44120CONF - 44"x120" Conf Table Top, Includes (3) 24" Legs List \$1,895
- OFD-CI4496CONF - 44"x96" Conf Table Top, Includes (2) 24" Legs List \$1,350

Receptacles



- OFD-CIRECP1 - Receptacle #1 List \$25
- OFD-CIRECP2 - Receptacle #2 List \$25
- OFD-CIRECP3 - Receptacle #3 List \$25
- OFD-CIRECP4 - Receptacle #4 List \$25

Draw Rods



- OFD-CIDR34-BU - Draw Rod for Panels, Black List \$21

Connectors



- OFD-CI2W39-BS - 2 Way 39" Connector 90°, Brushed Silver List \$100
- OFD-CI3W39-BS - 3 Way 39" Connector 90°, Brushed Silver List \$120
- OFD-CI4W39-BS - 4 Way 39" Connector 90°, Brushed Silver List \$136

Pass Through Cable



- OFD-CIPTP-2 - Panel to Panel Long Electric Festoon (Jumper) List \$73

Base Power Feed



- OFD-CIBASEIN-L - Base Power Feed from Left List \$278
- OFD-CIBASEIN-R - Base Power Feed from Right List \$278

Finished End Trim



- OFD-CIFE34-BS - Finished End Trim for 39" Panel, Brushed Silver.. List \$43



Power Block



- OFD-CIDBLBLOCK4-BLK - Double Sided Pwr Block with (4) Receptacles.. List \$121
- OFD-CIDBLBLOCK8-BLK - Double Sided Pwr Block with 8 Receptacles ...List \$179

Flat Mounting Bracket



- OFD-CI78MB - Used for 8-Wire Double Sided Blocks List \$8

Single Circuit Power Feed



- OFD-CI8420AP1-72-24 - 20-Amp Standard Plug w/15 Amp Adapter.. List \$227

Jumper Cable For Power Block



- OFD-CI84FF-48 - Desking Pwr Jumper Cable, 48" List \$133
- OFD-CI84FF-60 - Desking Pwr Jumper Cable, 60" List \$147
- OFD-CI84FF-66 - Desking Pwr Jumper Cable, 66" List \$154
- OFD-CI84FF-72 - Desking Pwr Jumper Cable, 72" List \$161
- OFD-CI84FF-90 - Desking Pwr Jumper Cable, 90" List \$183

Base in Feed Starter Cable for Power Block



- OFD-CI84SB2-108 - Base in Feed Starter Cable, 108" List \$189
- OFD-CI84SB2-144 - Base in Feed Starter Cable, 144" List \$232
- OFD-CI84SB2-72 - Base in Feed Starter Cable, 72" List \$146

Duplex Removal Tool for Power Block



- OFD-CI8SR - Duplex Removal Tool List \$6

Desk Mount Power Block



- OFD-CI3USB-WH - Pwr Block w/3 Pwr and 2 USB, Gloss White List \$393
- OFD-CI3USB-BS - Pwr Block w/3 Pwr and 2 USB, Silver Pearl List \$393

Bench It Series



Bench It Series Typical Workstations



NEW!

OFD-BITYP19 - with Laminate Tops
List \$3,390 (Tops and Legs)
Add Frosted Glass Screens \$1,131
Add Box/File Mobile Peds \$1,155
Add Cushion for Peds \$894



NEW!

OFD-BITYP16 - with Laminate Tops
List \$6,780 (Tops and Legs)
Add Frosted Glass Screens \$2,262
Add Box/File Mobile Peds \$2,310
Add Cushion for Peds \$1,788



NEW!

OFD-BITYP40 - 6-Pod,
72"x24" Work Surfaces with Laminate Tops
List \$3,680 (Tops and Legs)
Add Frosted Glass Screens - Front \$1,551
Add Frosted Glass Screens - Sides \$742
Add Box/File Mobile Peds \$2,310
Add Cushion for Peds \$1,788



NEW!

OFD-BI48120CONF
10' Conference Table
List \$2,400

Bench it Series **NEW!**



End Leg

- OFD-BI24EL-BS - 24" End Leg, Brushed Silver..... List \$120
- OFD-BI24EL-WH - 24" End Leg, White.....List \$120
- OFD-BI30EL-BS - 30" End Leg, Brushed Silver.....List \$130
- OFD-BI30EL-WH - 30" End Leg, White.....List \$130



Fixed Shared Leg

- OFD-BI24SL-BS - 24" Shared Leg, Brushed Silver.....List \$150
- OFD-BI24SL-WH - 24" Shared Leg, White.....List \$150
- OFD-BI30SL-BS - 30" Shared Leg, Brushed Silver.....List \$160
- OFD-BI30SL-WH - 30" Shared Leg, White.....List \$160



Expandable End Leg

- OFD-BI4860EL-BS - 48"-60" Exp End Leg, Brushed Silver.....List \$225
- OFD-BI4860EL-WH - 48"-60" Exp End Leg, White.....List \$225



Expandable Shared Leg

- OFD-BI4860SL-BS - 48"-60" Exp Shared Leg, Brushed Silver..List \$250
- OFD-BI4860SL-WH - 48"-60" Exp Shared Leg, White.....List \$250



Expandable Standing Height Leg

- OFD-BI374860EL-BS - 48"-60" Standing Ht Leg, Brushed Silver..List \$275
- OFD-BI374860EL-WH - 48"-60" Standing Ht Exp Leg, White.....List \$275

For standing height meeting table!



Triangle Leg Support

- OFD-BI120LEG-BS - For 120° Top, 24", Brushed Silver.....List \$115
- OFD-BI120LEG-WH - For 120° Top, 24", White.....List \$115

Expandable Work Surface Trough



- OFD-BI4872WST-BS - 48"-72" Exp Work Surface Trough, Brushed Silver..... List \$95
- OFD-BI4872WST-WH - 48"-72" Exp Work Surface Trough, White.....List \$95

Expandable Shared Trough



- OFD-BI4872ST-BS - 48"-72" Exp Shared Trough, Brushed Silver.....List \$90
- OFD-BI4872ST-WH - 48"-72" Exp Shared Trough, White.....List \$90

Screen Bracket



- OFD-BICLIP60-BS - Bracket for Screen-Front of Desk, Brushed Silver... List \$26
- OFD-BICLIP60-WH - Bracket for Screen-Front of Desk, White..... List \$26
- OFD-BICLIP30-BS - Bracket for Screen-Side of Desk, Brushed Silver List \$23
- OFD-BICLIP30-WH - Bracket for Screen-Side of Desk, White..... List \$23

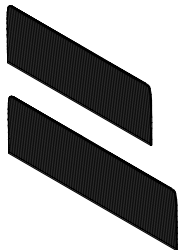

Front Mount Screens - Frosted Glass

- | | |
|--|--|
| OFD-BI1946FG
Frosted Glass Privacy
Screen for 48" Work
Surface, 19"Hx46"W
List \$325 | OFD-BI1958FG
Frosted Glass Privacy
Screen for 60" Work
Surface, 19"Hx58"W
List \$385 |
| OFD-BI1964FG
Frosted Glass Privacy
Screen for 66" Work
Surface, 19"Hx64"W
List \$425 | OFD-BI1970FG
Frosted Glass Privacy
Screen for 72" Work
Surface, 19"Hx70"W
List \$465 |

(Please order OFD-BICLIP60 Brackets Above, 2 per Screen)

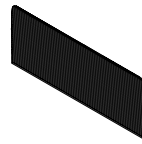

Side Mount - Frosted Glass

- | | |
|--|--|
| OFD-BI1922FG
Frosted Glass Privacy
Screen for 24" Work
Surface, 19"Hx22"W
List \$185 | OFD-BI1928FG
Frosted Glass Privacy
Screen for 30" Work
Surface, 19"Hx28"W
List \$215 |
|--|--|

(Please order OFD-BICLIP30 Brackets, 2 per Screen)

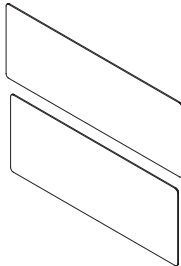

Front Mount Screens - Acrylic

- | | |
|---|---|
| OFD-BI1846A
Acrylic Privacy Screen
for 48" Work Surface,
18"Hx46"W
List \$198 | OFD-BI1858A
Acrylic Privacy Screen
for 60" Work Surface,
18"Hx58"W
List \$240 |
|---|---|

- | | |
|---|---|
| OFD-BI1864A
Acrylic Privacy Screen
for 66" Work Surface,
18"Hx64"W
List \$269 | OFD-BI1870A
Acrylic Privacy Screen
for 72" Work Surface,
18"Hx70"W
List \$289 |
|---|---|

(Please order Brackets, 2 per Screen for 48" Work Surface, and 3 per screen for all Others)

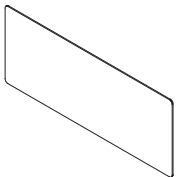

Side Mount - Acrylic

- | | |
|---|---|
| OFD-BI1822A
Frosted Glass Privacy
Screen for 24" Work
Surface, 18"Hx22"W
List \$115 | OFD-BI1828A
Frosted Glass Privacy
Screen for 30" Work
Surface, 18"Hx28"W
List \$125 |
|---|---|

(Please order OFD-BICLIP30 Brackets, 2 per Screen)

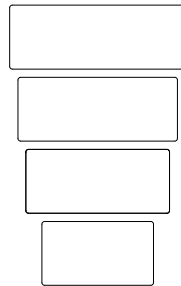

Front Mount Screens - Sea Board

- | | |
|---|---|
| OFD-BI1846SB
Privacy Screen, for
48" Work Surface,
18"Hx46"W
List \$105 | OFD-BI1858SB
Privacy Screen, for
60" Work Surface,
18"Hx58"W
List \$125 |
|---|---|

- | | |
|---|---|
| OFD-BI1864SB
Privacy Screen, for
66" Work Surface,
18"Hx64"W
List \$155 | OFD-BI1870SB
Privacy Screen, for
72" Work Surface,
18"Hx70"W
List \$165 |
|---|---|

(Please order Brackets, 2 per Screen for 48" Work Surface, and 3 per screen for all Others)

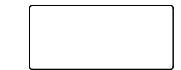

Side Mount - Sea Board

- | | |
|---|---|
| OFD-BI1822SB
Privacy Screen for
24" Work Surface,
18"Hx22"W
List \$55 | OFD-BI1828SB
Privacy Screen for
30" Work Surface,
18"Hx28"W
List \$65 |
|---|---|

(Please order OFD-BICLIP30 Brackets, 2 per Screen)

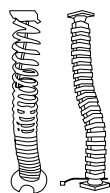

Cord Managers

- OFD-COIL-BS - For Floor to Work Surface, Coil Style, Brushed Silver.....List \$130
- OFD-COIL-B - For Floor to Work Surface, Coil Style, Black.....List \$130
- OFD-SPINE-BS - For Floor to Work Surface, Spine Style, Brushed Silver List \$135
- OFD-SPINE-B - For Floor to Work Surface, Spine Style, Black.....List \$135

NEW! Bench it Series

Rectangle Work Surfaces - Laminate

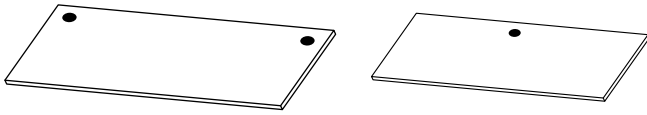

- OFD-BI7230WS - 72"x30" with Wire Mgt Trough, with (2) Grommets List \$460
- OFD-BI7224WS - 72"x24" with Wire Mgt Trough, with (2) Grommets List \$455
- OFD-BI6630WS - 66"x30" with Wire Mgt Trough, with (2) Grommets List \$455
- OFD-BI6624WS - 66"x24" with Wire Mgt Trough, with (2) Grommets List \$450
- OFD-BI6030WS - 60"x30" with Wire Mgt Trough, with (2) Grommets List \$410
- OFD-BI6024WS - 60"x24" with Wire Mgt Trough, with (2) Grommets List \$360
- OFD-BI4830WS - 48"x30" with Wire Mgt Trough, with (1) Grommet List \$350
- OFD-BI4824WS - 48"x24" with Wire Mgt Trough, with (1) Grommet List \$309

120° Work Surface - Laminate

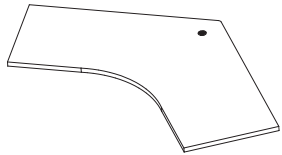

- OFD-BI1202448WS - 120° 24"x48"x48"x24" with (2) Wire Mgt Trough and (1) Grommet... List \$790

Rectangular Return Work Surfaces - Laminate

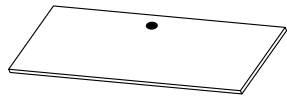

- OFD-BI4824WS - Top, 48" x 24", with Single Center Grommet List \$225
- OFD-BI4224WS - Top, 42" x 24", with Single Center Grommet List \$220

Conference Tables - 1 1/2" Laminate



- OFD-BI4848CONF - 48"x48" Conf Table Top, Includes (2) 48" Legs List \$1,200
- OFD-BI4896CONF - 48"x96" Conf Table Top, Includes (3) 48" Legs List \$2,000
- OFD-BI48120CONF - 48"x120" Conf Table Top, Includes (3) 48" Legs List \$2,400
- OFD-BI48144CONF - 48"x144" Conf Table Top, Includes (3) 48" Legs List \$2,700
- OFD-BI48168CONF - 48"x168" Conf Table Top, Includes (4) 48" Legs List \$3,400
- OFD-BI48192CONF - 48"x192" Conf Table Top, Includes (4) 48" Legs List \$3,600



Pedestals

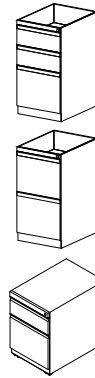

- OFD-BBF-BS Box/Box/File Pedestal 27.5"H, Brushed Silver List \$385
- OFD-BBF-WH Box/Box/File Pedestal 27.5"H, White List \$385
- OFD-FF-BS File/File Pedestal 27.5"H, Brushed Silver List \$385
- OFD-FF-WH File/File Pedestal 27.5"H, White List \$385
- OFD-CIBF-BS Mobile Pedestal 22"H Box/File, Brushed Silver List \$385
- OFD-CIBF-WH Mobile Pedestal 22"H Box/File, White List \$385

Laterals

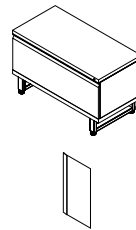

- OFD-CILF36-BS 36" Single Drawer Lateral File, Brushed Silver List \$800
- OFD-CILF36-WH 36" Single Drawer Lateral File, White List \$800
- OFD-CIPMSB-BS Panel Mount Support Bracket, Brushed Silver List \$23
- OFD-CIPMSB-WH Panel Mount Support Bracket, White List \$23

Cushions



- OFD-CICUSHBF - Cushion Top for Mobile B/F Pedestal List \$298
- OFD-CICUSHLAT36 - Cushion Top for Lateral List \$419

power it.
Daisy Chain Power

Power Block

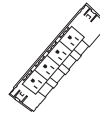

- OFD-CIDBLBLOCK4-BLK - Double Sided Pwr Block with (4) Receptacles.. List \$121
- OFD-CIDBLBLOCK8-BLK - Double Sided Pwr Block with 8 Receptcales ..List \$179

Flat Mounting Bracket



- OFD-CI78MB - Used for 8-Wire Double Sided Blocks List \$8

Single Circuit Power Feed



- OFD-CI8420AP1-72-24 -20-Amp Standard Plug w/15 Amp Adapter.. List \$227

Jumper Cable For Power Block



- OFD-CI84FF-48 - Desking Pwr Jumper Cable, 48" List \$133
- OFD-CI84FF-60 - Desking Pwr Jumper Cable, 60" List \$147
- OFD-CI84FF-66 - Desking Pwr Jumper Cable, 66" List \$154
- OFD-CI84FF-72 - Desking Pwr Jumper Cable, 72" List \$161
- OFD-CI84FF-90 - Desking Pwr Jumper Cable, 90" List \$183

Base in Feed Starter Cable for Power Block



- OFD-CI84SB2-108 - Base in Feed Starter Cable, 108" List \$189
- OFD-CI84SB2-144 - Base in Feed Starter Cable, 144" List \$232
- OFD-CI84SB2-72 - Base in Feed Starter Cable, 72" List \$146

Duplex Removal Tool for Power Block



- OFD-CI8SR - Duplex Removal Tool List \$6

Desk Mount Power Block



- OFD-CI3USB-WH - Pwr Block w/3 Pwr and 2 USB, Gloss White List \$393
- OFD-CI3USB-BS - Pwr Block w/3 Pwr and 2 USB, Silver Pearl List \$393

Connect it and Bench it - In Stock Options

Work Surface Laminate Choices

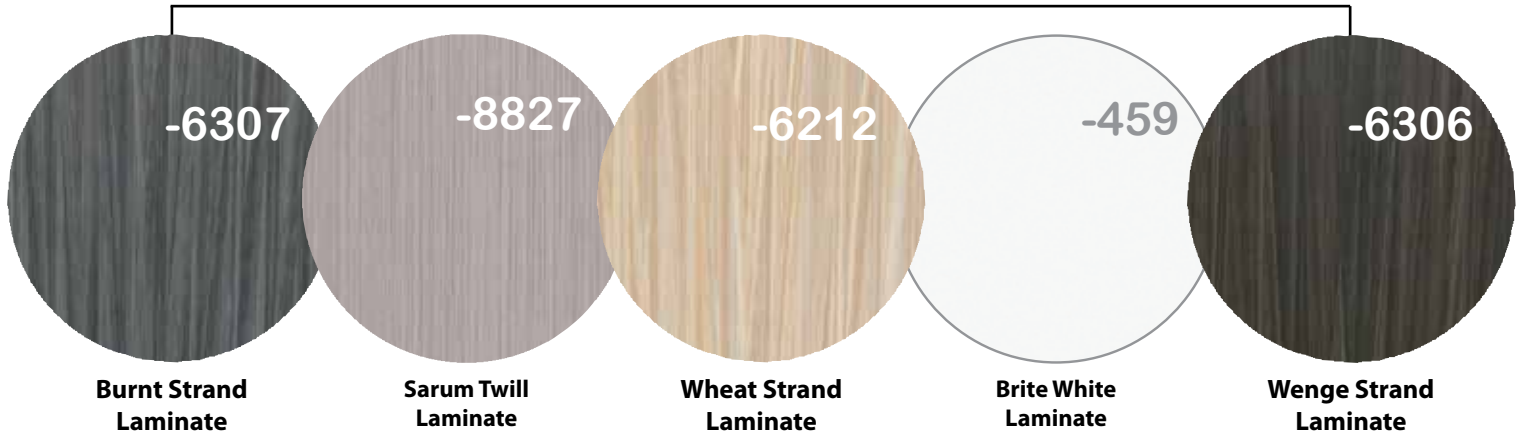

Acrylic Screens

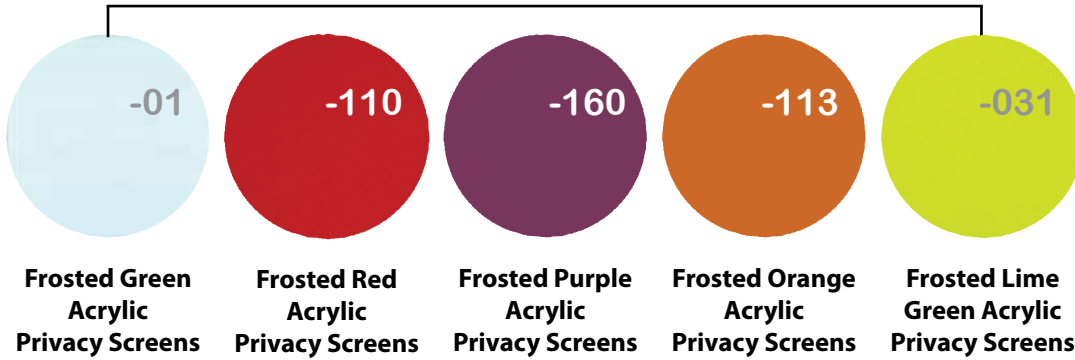

Privacy Screens

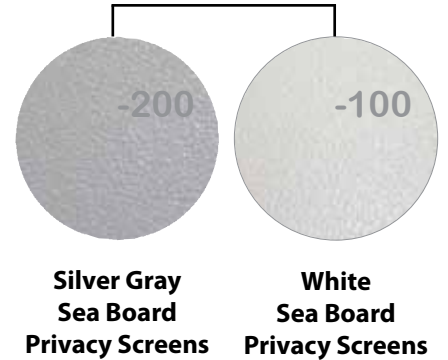

Cushions/Fabric

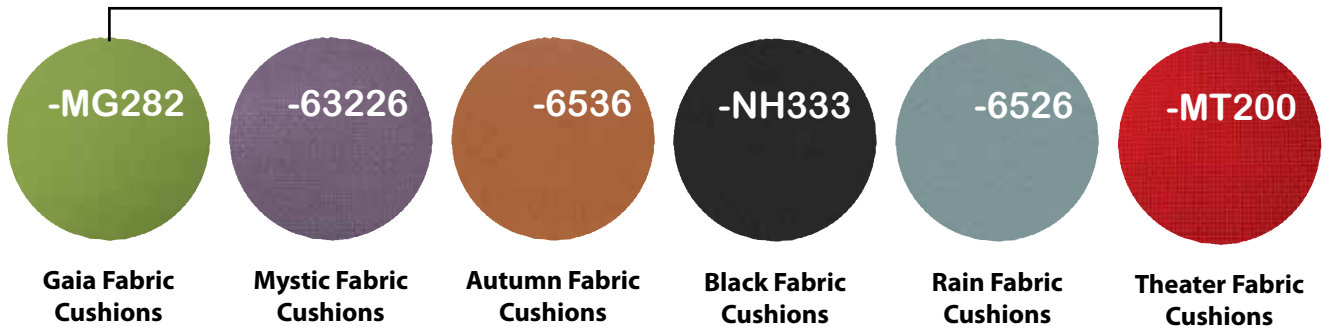

Paint

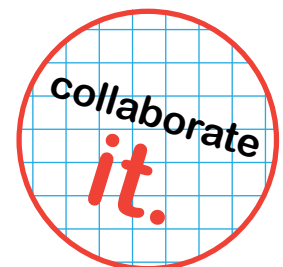
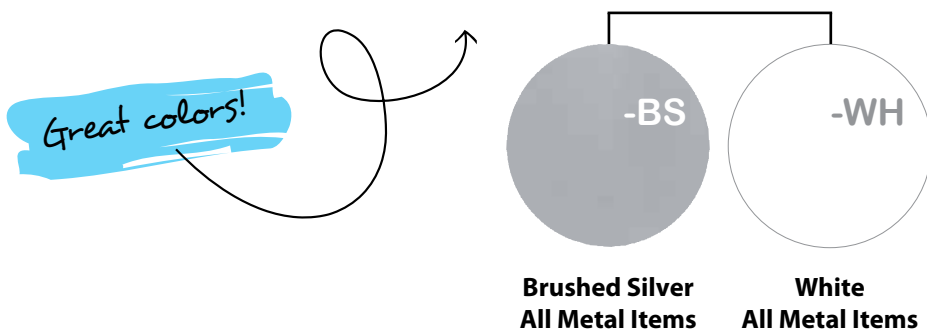

Lift it Series

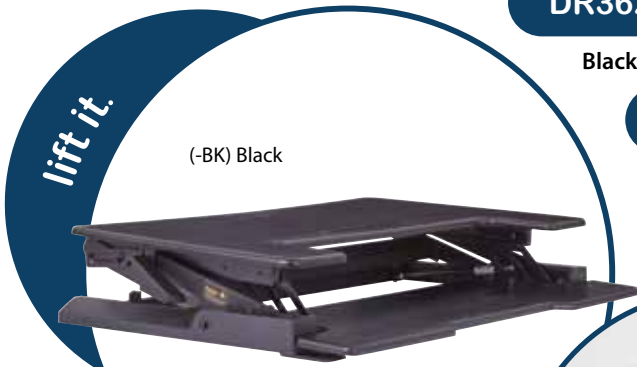

DR3622-BK

Black

NEW!

DR3622-WH

White

List \$895

Multiposition Desk Riser

- Tension adjustment
- Locks in 8 positions
- Dual pneumatic
- Dual handles
- Tablet holder
- Grommet / cord manager
- Keyboard surface 28"x10"

(-BK) Black

Overall Size
36"Wx24"Dx6.5"-16.25"H



DR3622-BK
shown fully
lifted



(-WH) White

Collaborate with lift it!

Electric Height Adjustable Bases

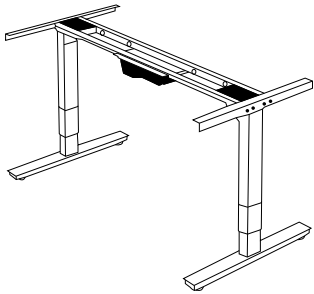

OFD-CIEL3BASE-BS
Electric Base
27.5"H, Brushed Silver
List \$1,400

OFD-CIEL3BASE-WH
Electric Base
27.5"H, White
List \$1,400

OFD-CIEL120BASE-BS
Electric Base
22"H, Brushed Silver
List \$2,200

OFD-CIEL120BASE-WH
Electric Base
22"H, White
List \$2,200



Height Range:
With OFD 1.1" Top:
25 $\frac{1}{8}$ " to 49 $\frac{1}{8}$ "
(with glides installed
on base, all the way in)

OFD-CIEL120BASE-WH

Connect It Work Surfaces - Laminate, Top Only

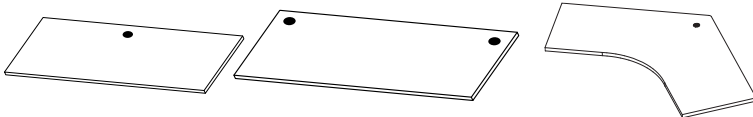

- OFD-CI4824TOP - Connect It Work Surface 48"x24" with a 2 $\frac{1}{4}$ " Center Grommet Hole... List \$214
- OFD-CI6024TOP - Connect It Work Surface 60"x24" with two 2 $\frac{1}{4}$ " Grommet Holes List \$265
- OFD-CI6624TOP - Connect It Work Surface 66"x24" with two 2 $\frac{1}{4}$ " Grommet Holes List \$355
- OFD-CI7224TOP - Connect It Work Surface 72"x24" with two 2 $\frac{1}{4}$ " Grommet Holes List \$360
- OFD-CI4830TOP - Connect It Work Surface 48"x30" with a 2 $\frac{1}{4}$ " Center Grommet Hole .. List \$285
- OFD-CI6030TOP - Connect It Work Surface 60"x30" with two 2 $\frac{1}{4}$ " Grommet Holes List \$315
- OFD-CI6630TOP - Connect It Work Surface 66"x30" with two 2 $\frac{1}{4}$ " Grommet Holes List \$360
- OFD-CI7230TOP - Connect It Work Surface 72"x30" with two 2 $\frac{1}{4}$ " Grommet Holes List \$365
- OFD-CI7236TOP - Connect It Work Surface 72"x36" with two 2 $\frac{1}{4}$ " Grommet Holes List \$385
- OFD-CI1202448TOP - 120° 24"x48"x48"x24" with a 2 $\frac{1}{4}$ " Center Grommet Hole List \$600

NEW!

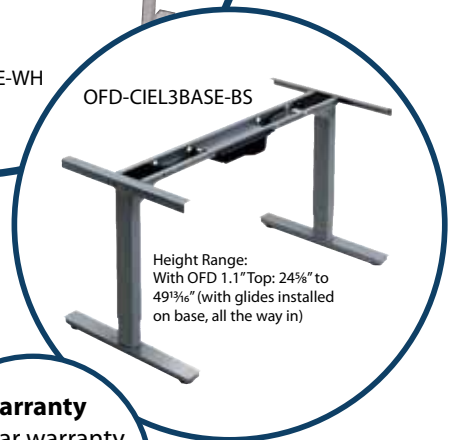

OFD-CIEL3BASE-BS

Height Range:
With OFD 1.1" Top: 24 $\frac{1}{8}$ " to
49 $\frac{1}{8}$ " (with glides installed
on base, all the way in)

Warranty

- 2-year warranty on the motors
- 5-year warranty on the base



-6307

Burnt Strand
Laminate



-8827

Sarum Twill
Laminate

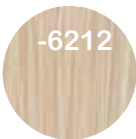

-6212

Wheat Strand
Laminate



-459

Brite White
Laminate



-6306

Wenge Strand
Laminate

Lift it Series

Lift It Table Rectangle Work Surfaces - Laminate

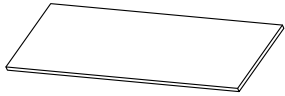

- OFD-LI4824 - Lift It Table Top 48"x24" 3MM Edge Band..... List \$150
- OFD-LI6024 - Lift It Table Top 60"x24" 3MM Edge Band..... List \$185
- OFD-LI7224 - Lift It Table Top 72"x24" 3MM Edge Band..... List \$220



Gray Laminate



Cherry Laminate



Mahogany Laminate



Espresso Laminate

Manual Height Adjustable Bases with White Tops



OFD-HAT60261-1

OFD-HAT60241-1
Max. Overall Size: 47.25Wx23.5D
Adjusts to 30.25 - 43.25H, White Frame, White Laminate Top
List \$900

OFD-HAT60251-1
Max. Overall Size: 59Wx23.5D
Adjusts to 30.25 - 43.25H, White Frame, White Laminate Top
List \$950

OFD-HAT60261-1
Max. Overall Size: 70.75Wx23.5D
Adjusts to 30.25 - 43.25H, White Frame, White Laminate Top
List \$1,000



White Laminate

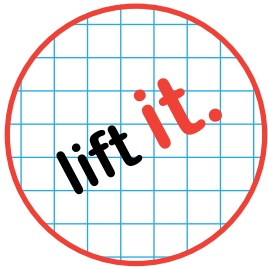

OFD-HAT60241-1



Height Control



OFD-CIEL120BASE-WH

Gotta have it!

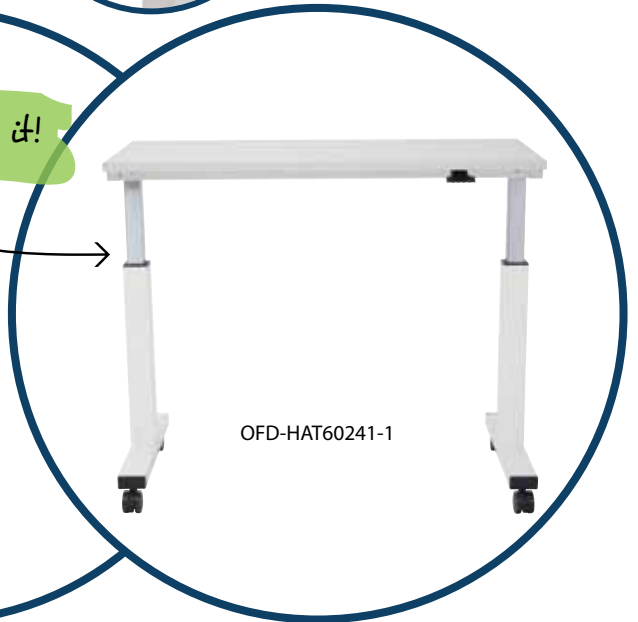

OFD-HAT60241-1

Connect it | Specifications

Work Surfaces

- Laminate tops for all work surfaces.
- 1.1" thick work surfaces.
- 3mm coordinating or matching edge banding.
- Grommets included on work surfaces.
- Power/data wire management troughs included.
- In stock colors are Brite White, Burnt Strand, Sarum Twill, Wenge Strand, and Wheat Strand.

Lateral Files and Pedestals

- Lateral drawer unit is 36"W.
- Mobile pedestals are 22"H Box/File.
- Free standing full peds are available as Box/Box/File or File/File 27.5"H.
- Lateral files and pedestals are all metal providing stability and durability.
- All lateral files and pedestals are available in White or Brushed Silver with locking capabilities
- Drop down lateral files require a laminate top of your choice.

Cushions

- Cushions are available for mobile pedestals as well as drop down lateral files.
- Pedestal cushion size is 22"x15".
- Drop down lateral file cushion size is 36"x18".
- In stock colors are Gaia, Mystic, Autumn, Black, Rain and Theater.

Panels

- All connect it panels are 36"Wx39"H, available with or without power.
- Frames and top caps are all brushed silver with all metal tiles available in White and Brushed Silver.
- Tiles are perforated on the bottom tile 18"H with a solid metal tile on top 14"H, White or Brushed Silver.
- Raceways are black and are flush with the panel.
- 18"W x 39"H wing panels – non-powered only.

Privacy/Modesty Screens

- Privacy/Modesty screens can be added in ¼" acrylic.
- Privacy/Modesty screens are 24"H overall.
- Privacy screens from Connect it that are 12" H are desk top mounted, and the bracket adds ½".
- In stock colors are Frosted Green Acrylic, Frosted Red Acrylic, Frosted Purple Acrylic, Frosted Orange Acrylic, and Frosted Lime Green Acrylic.
- In stock options include Sea Board in Silver Gray and White.
- Glass privacy screens are available in ¼" Frosted glass. These can easily be added to 36" panels.
- Glass privacy screens are 34"Wx10"H.
- Brushed silver brackets included with glass screens.

Electrical

- All electric options available, please call our design department for specification and pricing.

Bench it | Specifications

Work Surfaces

- Laminate tops for all work surfaces.
- 1.1" thick work surfaces.
- 3mm coordinating edge banding.
- Grommets included on work surfaces.
- Power/data wire management troughs included.
- In stock colors are Brite White, Burnt Strand, Sarum Twill, Wenge Strand, and Wheat Strand.

Table Frame

- Metal legs with leveling glides.
- Paint available in Brushed Silver or White.
- 24" and 30" end and shared legs are fixed.
- 48-60" end and shared leg are adjustable.
- Support brace/trough is metal and adjustable.
- Brace/Trough are attached to legs to complete desk frame.
- Optional shared trough.

Lateral Files and Pedestals

- Lateral drawer unit is 36"W.
- Mobile pedestals are 22"H Box/File.
- Free standing full peds are available as Box/Box/File or File/File.
- Lateral files and pedestals are all metal providing stability and durability.
- All lateral files and pedestals are available in White or Brushed Silver with locking capabilities
- Lateral files require a laminate top of your choice.

Cushions

- Cushions are available for mobile pedestals and lateral files.
- Pedestal cushion size is 22"x15".
- Lateral file cushion size is 36"x18".
- In stock colors are Gaia, Mystic, Autumn, Black, Rain and Theater.

Privacy Screens

- Privacy Screens can be added in ¼" Frosted Glass and are 17" above work surface.
- Privacy Screens can be added in Acrylic and are 16" H above work surface.
- Privacy screens from Connect it that are 12" H are desk top mounted, and the bracket adds ½".
- In stock colors are Frosted Green Acrylic, Frosted Red Acrylic, Frosted Purple Acrylic, Frosted Orange Acrylic, and Frosted Lime Green Acrylic.
- In stock options include Sea Board in Silver Gray and White.

Electrical

- All electric options available, please call our design department for specification and pricing.

collaborate **it.**



get **it.**

26 we stock **it.**

This would look great in our office!



Get connected with



connect it.



space it.



5200W-
List \$525
 Choose a fabric

space it.

Mesh Fabric Seat and Back
 (-7) Blue
 White Coated Nylon Base

317W-W11C1F2W
List \$795

space it.

White Breathable Mesh Seat and Back
 White Coated Nylon Base

Side View Arms Down

317W-W1C1F2W-
List \$750
 Choose a fabric

space it.

White Breathable Mesh Back
 (-512) Purple Mesh Fabric Seat
 White Coated Nylon Base

- One touch pneumatic seat height adjustment
- 2-to-1 synchro tilt control
- Height adjustable flip arms
- Tilt tension
- Tilt Lock

All items on this page have achieved GREENGUARD Certification.

SPACE[®]
 SEATING

28 we stock it.

317-6C61F6-

List \$695

Choose a fabric below

Height Adjustable
Flip Arm!

flip it.



(-18) Orange Mesh Fabric Seat

Platinum Coated Nylon Base

Light AIR GRID Back

FUN COLORS FABRIC PROGRAM

space it.

317-ME36C61F6

List \$675



Black Eco Leather Seat

Platinum Coated Nylon Base

Light AIR GRID Back

space it.

- One touch pneumatic seat height adjustment
- 2-to-1 synchro tilt control
- 4-Way adjustable flip arms

- Adjustable lumbar support
- Adjustable tilt tension
- Tilt tension
- Tilt lock

MI-8810W-

White Frame
List \$290

Choose a fabric below

In Stock!



(-7) Blue Mesh Fabric Seat

White Finished Metal Frame

White Pro GRID Back

FUN COLORS FABRIC PROGRAM

space it.

MI-8810S-

Silver Frame
List \$290

Choose a fabric below

NEW!

Silver Frame Available May 1st



(-512) Purple Mesh Fabric Seat

Silver Finished Metal Frame

White Pro GRID Back

FUN COLORS FABRIC PROGRAM

space it.

All items on this page have achieved GREENGUARD Certification.



- 7 Blue
- 9 Red
- 18 Orange
- 512 Purple
- 6 Green
- 3 Black

SPACE SEATING

we stock it. 29



529-M3R2N6F2

List \$625

- Three position tilt lock
- Seat slider

NEW!

Height Adjustable Flip Arm!



529-R22N1F2

List \$595



Great Lumbar Support!

- Height adjustable flip arms
- 2-to-1 synchro tilt control with tilt lock, and tilt tension control

529-3R2N1F2

List \$550



529-E3R2N1F2

List \$550



- One touch pneumatic seat height adjustment
- Adjustable lumbar support



All items on this page have achieved GREENGUARD Certification.

SPACE SEATING



5500

List \$375

5500-

List \$395

Choose a fabric

- 6 Green
- 9 Red
- 18 Orange
- 512 Purple
- 7 Blue

space it.

Mesh Fabric Seat (-9) Red

Black Nylon Base

FUN COLORS
FABRIC PROGRAM

Dark AIR GRID Back

space it.

Black Mesh Fabric Seat

Black Nylon Base

Dark AIR GRID Back

Back Detail

- One touch pneumatic seat height adjustment
- Adjustable arms

5500SL

List \$495

- Three position tilt lock
- Seat slider

NEW!
with new features!

space it.

Black Mesh Fabric Seat

Black Nylon Base

Dark AIR GRID Back

- 2-to-1 synchro tilt control
- Tilt tension
- Tilt lock

All items on this page have achieved GREENGUARD Certification.



SPACE SEATING

we stock it. 31

5700E
List \$385



Dark AIR GRID Back

(E) Black Eco Leather Seat Black Nylon Base

5700SL
List \$465



Dark AIR GRID Back

Black Bonded Leather Seat Black Nylon Base

- Three position tilt lock
- Seat slider

NEW!
with new features!

5505
List \$340
Black Mesh Fabric Seat



Dark AIR GRID Back

Fixed Angled Arms

Black Mesh Fabric Seat

Sled Base

5505-
List \$360
Choose a fabric below
(7-10 day lead time)

- 3 Black
- 6 Green
- 512 Purple
- 18 Orange
- 7 Blue
- 9 Red

*Great Colors!
Great Comfort!*

- One touch pneumatic seat height adjustment
- Adjustable arms
- 2-to-1 synchro tilt control
- Tilt tension
- Tilt lock

(-18) Orange Mesh Fabric Seat



get it.

 All items on this page have achieved GREENGUARD Certification.

SPACE
SEATING

2300
List \$615



Black Breathable Mesh Back

Gunmetal Base Black Mesh Fabric Seat

- Adjustable lumbar support



Back Detail

335-E37P918P

List \$695

Great for the Conference Room!

- Adjustable arms
- Adjustable lumbar support
- Tilt tension
- Tilt lock
- One touch pneumatic seat height adjustment
- 2-to-1 synchro tilt control



55403

List \$595

- Adjustable headrest OS



57906E

List \$670

- Adjustable leather headrest OS

NEW!



5540

List \$500



All items on this page have achieved GREENGUARD Certification.



The Boss will love it!

SPACE SEATING

we stock it. 33

big & tall it.



839-11B35WA

List \$975

- Auto adjusting synchro tilt
- Deluxe 2-to-1 synchro tilt
- Anti-kick back

big & tall it.

Breathable Mesh Seat and Back

400 lb. weight limit

Gunmetal Base



75-37A773

List \$850

- Tilt tension
- Mid pivot knee tilt

big & tall it.

Black Mesh Fabric Seat

Dark Double AIR GRID Back

400 lb. weight limit

Gunmetal Base



63-37A773HM

List \$895

- Tilt tension
- Mid pivot knee tilt
- Adjustable headrest

big & tall it.

Black Mesh Fabric Seat, Trim, and Headrest

Dark AIR GRID Back

400 lb. weight limit

Gunmetal Base



Looks so Comfortable!

- One touch pneumatic seat height adjustment
- Tilt lock
- 2-way adjustable arms
- Adjustable lumbar support

75-47A773

List \$925

- Tilt tension
- Mid pivot knee tilt

big & tall it.

Black Leather Seat

Dark Double AIR GRID Back

400 lb. weight limit

Gunmetal Base



All items on this page have achieved GREENGUARD Certification.

SPACE SEATING

34 we stock it.

OS Oversized Seating Item - Check Shipping Program

30180

List \$695

- Flip arms

CS

NEW!

- One touch pneumatic seat height adjustment
- Tilt tension
- Tilt lock

big & tall it.

Vertical Mesh Back

Black Bonded Leather Seat

400 lb. weight limit



Coated Metal Base

Arms Flipped Back



69220C-EC3

List \$720

- 2-way flip arms
- 3-Position adjustable height

CS

NEW!

big & tall it.

Mesh Back

Chrome Base

400 lb. weight limit

(-EC3) Black Eco Leather Seat



39200

List \$650

- Flip arms

CS

big & tall it.

Black Bonded Leather

Coated Metal Base

400 lb. weight limit



What a value!
Looks Comfortable too!

EC1283C-EC3

List \$550

CS

big & tall it.

(-EC3) Black Eco Leather

Chrome Base

350 lb. weight limit

Reverse Stitching



get it.



A15

List \$85
Opt. Height Adjustable Arms
Only for: 13-37N20D



Would work great with sit-stand desks.

Big & Tall

15-37A720D

List \$595
• Adjustable footring



Black Mesh Fabric Seat
Height Adjustment 28" to 33"
Dark Double AIR GRID Back
325 lb. weight limit
Overall Size 21.5"Wx25.5"Dx54.5"H
Gunmetal Base



raise it.



13-37N20D

List \$495
• Adjustable footring

Black Mesh Fabric Seat
Black Nylon Base
Dark AIR GRID Back
Overall Size 21.25"Wx25.5"Dx51"H
Height Adjustment 27.5" to 32.5"



• One touch pneumatic seat height adjustment



A27WA

List \$98
Opt. Height and Width Adjustable Arms
Only for: 15-37A720D

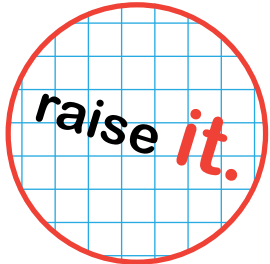

raise it.



213-37N2F3D

List \$600
• 4-way adjustable flip arms

Black Mesh Fabric Seat
Overall Size 27.5"Wx23.75"Dx48.25"H
Height Adjustment 20" to 27.5"
Black Nylon Base

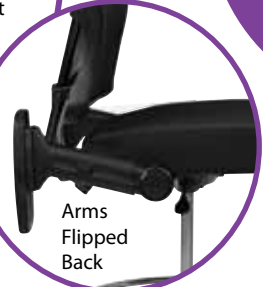

Arms Flipped Back

raise it.



DC51000NV

List \$335
• Adjustable footring

Breathable Woven Mesh Back
(-V) Black Vinyl Seat
Overall Size 19.5"Wx22"Dx40.5-47.5"H
Height Adjustment 21" to 28.25"
Black Nylon Base

raise it.



92583-30

List \$425

- Adjustable footring

NEW!

Black **ProGRID** Back

(-30) Coal FreeFlex® Fabric Seat

Overall Size 27"Wx24.75"Dx41-50"H

Height Adjustment 24.25" to 33.5"

Black Nylon Base

Unique design!

raise it.



DCY69006-3M

List \$375

- Padded flip arms

NEW!

Screen Back

(-3M) Black Mesh Seat

Overall Size 24.5"Wx24.25"D x43.25-50.25"H

Height Adjustment 22.5" to 29.5"

Black Nylon Base with Silver Accents

raise it.

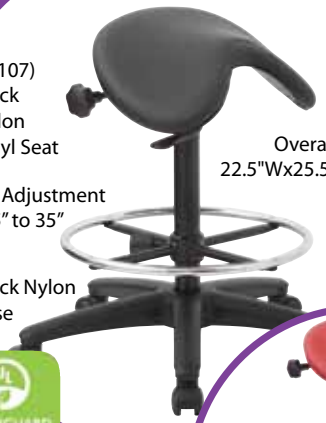

ST205-R107

Black Antimicrobial Vinyl (in stock)

ST205-

Choose an antimicrobial vinyl below (7-10 day lead time)

List \$315

- Adjustable seat angle

NEW!
ergonomic sit-stand stool

• One touch pneumatic seat height adjustment

(-R107) Black Dillon Vinyl Seat

Overall Size 22.5"Wx25.5"Dx35.25"H

Height Adjustment 25" to 35"

Black Nylon Base

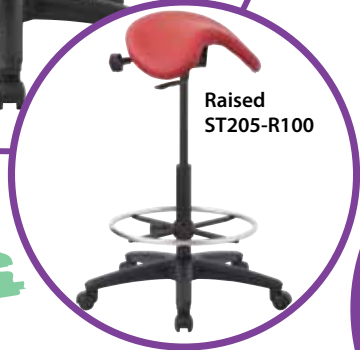

Raised ST205-R100



saddle up!

raise it.



DC2990-231

Black Fabric Seat

DC2990V

Black Vinyl Seat

List \$310

- Seat depth adjustment
- Adjustable footring

Black Breathable Mesh Back

(-231) Black Icon Fabric Seat

Overall Size 26"Wx23"Dx50.25"H

Height Adjustment 24.25" to 33.75"

Black Nylon Base



-R100 Lipstick	-R101 Snow	-R102 Java	-R105 Blue
-R103 Stratus	-R106 Sage	-R104 Buff	-R107 Black

Train it Training Tables



Training Table Rectangle Work Surfaces - Laminate

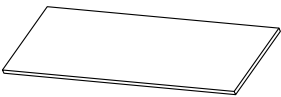

- OFD-TT4824 - Training Table Top 47 $\frac{7}{8}$ "x23 $\frac{3}{8}$ " 3MM Edge Band List \$180
- OFD-TT6024 - Training Table Top 59 $\frac{7}{8}$ "x23 $\frac{3}{8}$ " 3MM Edge Band List \$225
- OFD-TT7224 - Training Table Top 71 $\frac{7}{8}$ "x23 $\frac{3}{8}$ " 3MM Edge Band List \$270

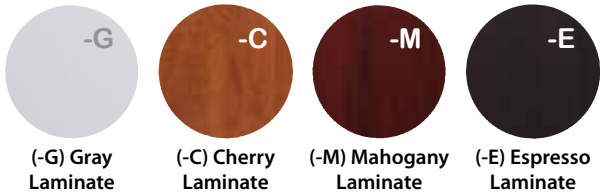

(-G) Gray Laminate (-C) Cherry Laminate (-M) Mahogany Laminate (-E) Espresso Laminate

Got Legs!

- Leg/Post Colors:
- (-BK) Black
 - (-S) Silver
 - (-W) White

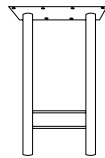

"H" Style Training Table Leg

- OFD-HLEG24 - "H" Style Leg for 24"D Work Surface \$135
- OFD-HLEG30 - "H" Style Leg for 30"D Work Surface \$170

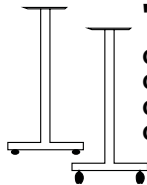

"T" Style Training Table Leg

- OFD-TLEG24 - "T" Style Leg for 24"D Work Surface \$115
- OFD-TLEG30 - "T" Style Leg for 30"D Work Surface \$125
- OFD-TLEG24CAS - "T" Style Leg w/Casters for 24"D Work Surface \$130
- OFD-TLEG30CAS - "T" Style Leg w/Casters for 30"D Work Surface \$140

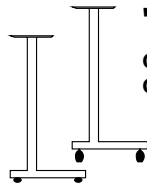

"C" Style Training Table Leg

- OFD-CLEG24 - "C" Style Leg for 24"D Work Surface \$115
- OFD-CLEG24CAS - "C" Style Leg w/Casters for 24"D Work Surface \$130



Training Table Post with Casters/Glides

- OFD-POSTC - 2" Post Leg with Casters\$69
- OFD-POSTG - 2" Post Leg with Glides.....\$79



Training Table Peninsula Post

- OFD-PENINLEG - 4" Peninsula Post Leg..... \$115

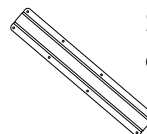

Stretcher Bar

- OFD-TOPBAR-BK - Stretcher Bar for Table Work Surfaces, 48.75", Black Only\$29

Ganging and Nesting Capabilities!

nest it.



Titanium Arms and Legs

Black Screen Flex Back

(-231) Black Icon Fabric Seat

FC8487-231

List \$275

nest it.



Black Finish Frame

Black Screen Flex Back

(-231) Black Icon Fabric Seat

FC8433-231

List \$250

NEW!

• Dual wheel carpet casters

nest it.



Ventilated Black Plastic Back

(-30) Coal FreeFlex® Fabric Seat

Titanium Arms and Legs

NI-2000-30

List \$245

nest it.



Ventilated Black Plastic Back

(-30) Coal FreeFlex® Fabric Seat

Titanium Legs

NI-2200-30

List \$225

• Seat folds for horizontal nesting



nest it.



Built-in Lumbar Support

(-30) Coal FreeFlex® Fabric Seat

Titanium Arms and Legs

Black Pro GRID® Back

NI-1000-30

List \$335

nest it.



Built-in Lumbar Support

(-30) Coal FreeFlex® Fabric Seat

Titanium Legs

Black Pro GRID® Back

NI-1200-30

List \$315

Need it!

All items on this page have achieved GREENGUARD Certification.



Ganging and Nesting Capabilities!

nest it.

Espresso Top



Titanium Base

Overall Size 72"x24"

- NI-84226TG
- Gray
- NI-84226TC
- Cherry
- NI-84226TM
- Mahogany
- NI-84226TE
- Espresso
- List \$910



- 1" Laminate top with impact-resistant PVC Edges
- Single-lever folding



nest it.

Cherry Top



Titanium Base

Overall Size 60"x24"

- NI-84225TG
- Gray
- NI-84225TC
- Cherry
- NI-84225TM
- Mahogany
- NI-84225TE
- Espresso
- List \$820

- NI-84224TG
- Gray
- NI-84224TC
- Cherry
- NI-84224TM
- Mahogany
- NI-84224TE
- Espresso
- List \$730

nest it.

Mahogany Top



Titanium Base

Overall Size 48"x24"



- Space-saver nesting capability
- Easy-roll, locking carpet casters

nest it.

Gray Top



Titanium Base

Overall Size 48"x24"

- NI-842HR24TG
- Gray
- NI-842HR24TC
- Cherry
- NI-842HR24TM
- Mahogany
- NI-842HR24TE
- Espresso
- List \$650



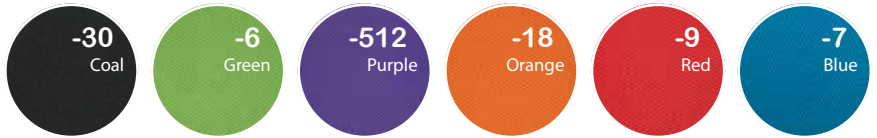

MI-2102-30

List \$425
Coal FreeFlex® Fabric

MI-2102-

List \$464

Choose a fabric

- 3-position locking 2-to-1 Synchro tilt
- Tilt tension
- Tilt lock
- Fixed back



MI-2502-30

List \$460
Coal FreeFlex® Fabric

MI-2502-

List \$499

Choose a fabric

- Multi-function control
- Fixed back

Voted best series in 2016!



MI-97728-EC3

List \$595

- Synchro tilt control with infinite lock
- Tilt tension
- Tilt lock
- 2-way adjustable arms



MI-97720-30

List \$575

- Synchro tilt control with infinite lock
- Tilt tension
- Tilt lock
- 2-way adjustable arms

- One touch pneumatic seat height adjustment
- 3-Way adjustable arms
- Seat depth adjustment
- Seat slider



MI-97720-30 Back Detail



MI-93720

List \$650

- Synchro tilt control with infinite lock
- Tilt tension
- Tilt lock



OFD-MIHR108M

List \$65

Opt. Headrest Only for:
MI-2102,
MI-2502,
MI-97728-EC3,
MI-97720-30,
MI-93720



OFD-MIHR109F

List \$85

Opt. Headrest Only for:
MI-2102,
MI-2502,
MI-97728-EC3,
MI-97720-30,
MI-93720

All items on this page have achieved GREENGUARD Certification.



mesh it.

mesh it.



Black Nylon Base

Black Pro GRID[®] Back

FUN COLORS FABRIC PROGRAM

(-7) Blue Mesh Fabric Seat

MI-1122-30

List \$379
Coal FreeFlex[®] Fabric

MI-1122-

List \$418
Choose a fabric
• 2-to-1 Synchro tilt
• 2-way adjustable arms

• One touch pneumatic seat height adjustment

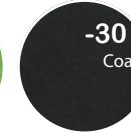

Love the blue on this chair!

mesh it.



Black Nylon Base

Black Pro GRID[®] Back

FUN COLORS FABRIC PROGRAM

(-18) Orange Mesh Fabric Seat

MI-1522-30

List \$450
Coal FreeFlex[®] Fabric

MI-1522-

List \$489
Choose a fabric
• Multi-function control
• 3-way adjustable arms

• Seat slider
• Ratchet back

mesh it.



(-30) Coal FreeFlex[®] Fabric Seat

Titanium Frame

MI-1500-30

List \$290

Black Pro GRID[®] Back



Stacking Detail



mesh it.



Black Mesh Fabric Seat

Breathable Mesh Back

Black Nylon Base

MI-95893

List \$475
• Multi Function Control
• 4-way adjustable arms

mesh it.



Titanium Frame

(-30) Coal FreeFlex[®] Fabric Seat

85670-30

List \$250

Black Pro GRID[®] Back



Back Detail

Great Value!!



mesh it.



Titanium Frame

Black Pro GRID[®] Back

(-30) Coal FreeFlex[®] Fabric Seat

85640-30

List \$260



get it.

42 we stock it.



When style meets comfort!



MI-95672-2

List \$525
Gray Fabric (in stock)

MI-95672-

List \$545
Choose a fabric (7-10 day lead time)

- Deluxe 2-to-1 Synchro tilt
- 2-Way adjustable arms
- Seat depth adjustment
- Tilt tension
- Tilt lock
- Seat slider

- One touch pneumatic seat height adjustment
- Back height adjustment
- Ratchet back



MI-95673-2

List \$500
Gray Fabric (in stock)

MI-95673-

List \$520
Choose a fabric (7-10 day lead time)

- Deluxe 2-to-1 Synchro tilt
- 2-Way adjustable arms
- Seat depth adjustment
- Tilt tension
- Tilt lock
- Seat slider

MI-8810W-

White Frame
List \$290

Choose a fabric below

In Stock!



MI-8810S-

Silver Frame
List \$290

Choose a fabric below

NEW!

Silver Frame Available May 1st

Great color options for guest chairs!

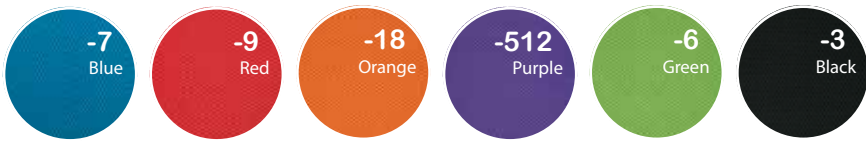



MI-4102-3

List \$390

- 2-to-1 Synchro tilt
- Adjustable tilt tension

Well priced and Cool style!

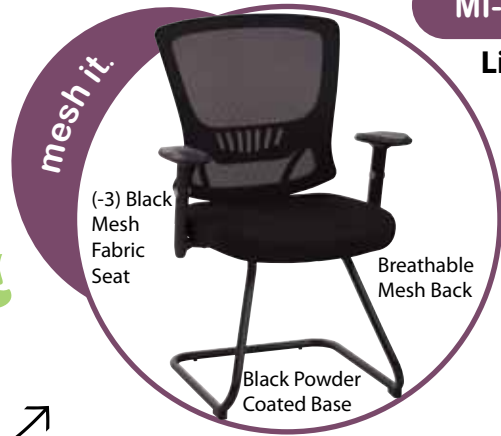

MI-1800-3

List \$275



69906-3

List \$370

- 2-to-1 Synchro tilt
- Adjustable tilt tension
- Padded flip arms with silver accents

- One touch pneumatic seat height adjustment
- Tilt lock
- Adjustable arms



MI-2817

List \$275

- Ratchet back
- Back height adjustment



MI-28174

List \$340

- Ratchet back
- Back height adjustment

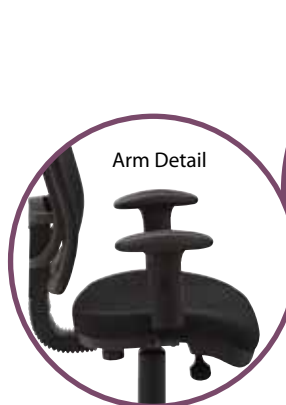



EM51022N-3

- List \$250**
250 lbs. weight limit
- One touch pneumatic seat height adjustment
 - Locking tilt control with tilt lock, and tilt tension control



183305

- List \$169**
200 lbs. weight limit
- 5 Year warranty
 - 2 Years on component parts including pneumatic cylinders, control mechanisms, wood, plastic parts, base and casters.
 - 1 Year on upholstery fabric and foam against wear and deterioration.
 - Leather is not warranted against routine scratching and scuffing, as leather is subject to minor blemishes in use.
 - 200 lbs. weight limit.
- Recommended for residential use.**

Great value and comfort!

Back by popular demand!



TI-1522-30

- List \$475**
- Multi-function control
 - Forward pitch
 - Seat angle
 - Seat slider
 - Back angle
 - Ratchet back



TI-2402-231

- List \$475**
- Seat slider
 - Seat depth adjustment
 - 3-position, 2-to-1 synchro tilt control with tilt lock, and tilt tension control

Working long hours? Try it!

get it.



TI-1102-30

- List \$370**
- 2-to-1 synchro tilt control with tilt lock, and tilt tension control

- One touch pneumatic seat height adjustment
- 2-way adjustable arms

leather it.



Black
Nylon Base

(-G1) Espresso
Glove Soft
Leather

Glove Soft
Leather

OFD-6640-B13

Black

OFD-6640-G1

Espresso
List \$640

- Executive High Back
- Locking tilt control
 - Padded arms

- One touch pneumatic seat height adjustment
- Tilt lock
- Tilt tension

Need it!

leather it.



(-3) Black Leather

Chrome Base

8200-3

Black

7270

White
List \$695
High Back

- Mid-pivot knee tilt control

OS

Great Style!

leather it.



White Leather

Chrome Base

7271

White

8201-3

Black
List \$650

- Mid Back
- Mid-pivot knee tilt control

OS

Back Detail

This series looks amazing!

leather it.



(-3) Black Leather

Chrome Base

8205-3

Black

7275

White
List \$595
Sled Base

OS



All items on this page have achieved GREENGUARD Certification.



FL92017C-U6

Black Faux Leather (in stock)

FL92017C-U11

White Faux Leather
(7-10 day lead time)

FL92017C-U42

Charcoal Gray Faux Leather
(7-10 day lead time)

List \$312

NEW!

- U11 White Faux Leather
- U42 Charcoal Gray Faux Leather

• One touch pneumatic seat height adjustment

get it.



FL5380C-U6

Black

FL5380C-U11

White

FL5380C-U22

Smoke

List \$475

Executive High Back

Voted most popular conference chair!

Gotta have this at my desk!



FL5388C-U11

White

FL5388C-U6

Black

FL5388C-U22

Smoke

List \$425

Executive Mid Back

• Locking tilt control with tilt tension control

manage it.



FL89675-U6

List \$265

Flip Arms



Flip Arm!

(-U6) Black Faux Leather

Black Nylon Base

Great price!

manage it.



FL9097-U6

List \$375

Padded Arms with Polished Aluminum Accents

(-U6) Black Faux Leather

Black Nylon Base with Polished Aluminum Accents

manage it.



ECH68807-EC3

Black/Titanium List \$460

Padded Arms

Coated Base with Black End Caps

(-EC3) Black Eco Leather

Looks so comfortable!

- One touch pneumatic seat height adjustment
- Locking tilt control with tilt lock, and tilt tension control

manage it.



ECH83507-EC3

Black/Titanium List \$450

Coated Base with Black End Caps

(-EC3) Black Eco Leather

manage it.



9333E

List \$685

- 2-to-1 Synchro tilt
- Fixed cantilever arms

Gunmetal Base and Arms

(-E) Black Eco Leather



Arm Detail



Best Selling Conference Chairs

OFD-605-BLK

List \$249

Most Popular of 2016!

manage it.



• One touch pneumatic seat height adjustment

OFD-6583-EC3

Black

OFD-6583-EC10

Latte

EC6582-EC9

Mocha

List \$325



-EC10
Latte
Eco Leather

-EC9
Mocha
Eco Leather

manage it.



Most Popular of 2016!

FL3422-U6

List \$350

manage it.



Reverse Stitching

• Locking tilt control with tilt lock, and tilt tension control

OPH61606-EC3

List \$625

• Knee tilt control
• Height adjustable arms

manage it.



get it.

manage it.

manage it.



Black Faux Leather

Black Nylon Base

OFD-7000-BLK

Black

OFD-7000-SAD

Saddle

List \$325

Executive High Back

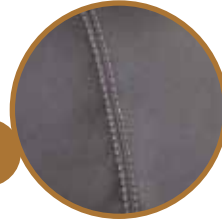

Black has Reverse Stitching

This price is perfect!

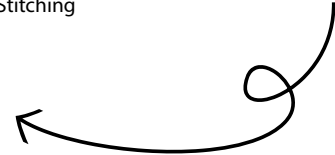

manage it.



Saddle Faux Leather

Black Nylon Base

OFD-7100-BLK

Black

OFD-7100-SAD

Saddle

List \$299

Executive Mid Back

Great comfort!

manage it.



Black Faux Leather

OFD-7200-BLK

Black

OFD-7200-SAD

Saddle

List \$265

Guest Chair



Black has Reverse Stitching

- One touch pneumatic seat height adjustment
- Mid-pivot knee tilt control with tilt lock, and tilt tension control

get it.

50 we stock it.

FL7480-U6

List \$270
Executive/Conference
High Back

(-U6) Black
Faux Leather
Black
Nylon Base



manage it.

FL7481-U6

List \$250
Executive Mid Back

(-U6) Black
Faux Leather
Black
Nylon Base



manage it.

- Thick padded seat and back with built-in lumbar support
- Locking tilt control with adjustable tilt tension

- Padded arm
- Dual wheel carpet casters

I picture these in our conference room!

FL7485-U6

List \$230
Guest Chair

(-U6) Black
Faux Leather



manage it.

FL7484-U6

List \$230
Guest Chair

(-U6) Black
Faux Leather



Black
Nylon Base

manage it.

Great Value!



OFD-ST203-

List \$270

Choose an antimicrobial vinyl

- Height adjustable 19" to 24"

-R105
Blue

-R104
Buff

Great for all healthcare facilities!

- One touch pneumatic seat height adjustment
- Adjustable seat angle

Height Adjustment
19"-24"



healthcare it.

(-R107)
Black
Dillon
Vinyl Seat

Height Adjustment
25" to 35"

Black Nylon
Base

Overall Size
22.5"Wx25.5"Dx35.25"H

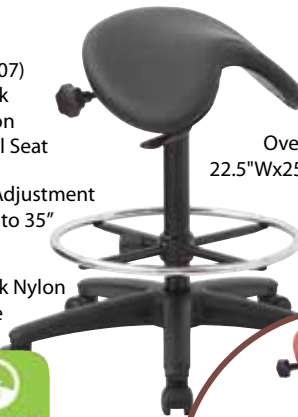

ST205-R107

Black Antimicrobial Vinyl
(in stock)

*NEW!
ergonomic
sit-stand stool*

ST205-

Choose an antimicrobial vinyl below (7-10 day lead time)

List \$315

- Adjustable seat angle
- Height adjustable 25" to 35"



Raised
ST205-R100

- Antimicrobial Vinyl
- Soft PU arm pads
- Sturdy metal frame with metal back bar re-enforcement
- Matching frame - allows for gangability from the bottom of the legs.

OFD-BC9601-

21" Wide

List \$475

300 lb.
weight limit

OFD-BC9602-

26" Wide

List \$525

400 lb.
weight limit

OFD-BC9603-

30" Wide

List \$575

500 lb.
weight limit

Choose an antimicrobial vinyl OS

-R105
Blue

-R104
Buff

*Mix
and
Match!*



OFD-BC9603-R103



OFD-BC9602-R106



OFD-BC9601-R102

These antimicrobial vinyl also available.
Please allow 7-14 business days.

-R100
Lipstick

-R101
Snow

-R102
Java

-R103
Stratus

-R106
Sage

-R107
Black

• Replacement seats and backs are available. Please call customer service for details.

healthcare it.



All items on this page have achieved GREENGUARD Certification.

Get a Charge!
Lounge Seating with
Charging Station!



ATL51-R107

Black Dillon
Antimicrobial Vinyl
List \$600
Club Chair

NEW!

Overall Size
32"Wx31"Dx29.5"H

People will
LOVE this!



• Single AC
and USB 3.0
charging
station



UL Certified
Charging
Station



ATL52-R107

Black Dillon
Antimicrobial Vinyl
List \$850
Loveseat

NEW!

Overall Size
51.5"Wx31"Dx29.5"H



ATL53-R107

Black Dillon
Antimicrobial Vinyl
(7-10 lead time)
List \$1,195
Sofa

NEW!

Overall Size
72.75"Wx31.5"Dx29.75"H

• Silver
finish legs

charge
it.

#1 Best Sellers!

PAC51-V18

Black

PAC51-V34

Espresso
List \$435
Club Chair

• (-V34)
Espresso
Vinyl

lounge it.



Overall Size
32"Wx31"Dx29.5"H

• (-V18)
Black
Vinyl

• Silver
finish legs

lounge it.



Overall Size
51.5"Wx31"Dx29.5"H

PAC52-V34

Espresso

PAC52-V18

Black
List \$580
Loveseat



Overall Size
72.75"Wx31.5"Dx29.5"H

PAC53-V18

Black

PAC53-V34

Espresso
List \$795
Sofa

lounge it.



Overall Size
32"Wx33.5"Dx30.75"H

OFD-SL8471

List \$750
Club Chair

OFD-SL8472

List \$1,125
Loveseat

lounge it.



Overall Size
58"Wx33.5"Dx30.75"H

OFD-SL8473

List \$1,425
Sofa



Overall Size
74.5"Wx33.5"Dx30.75"H

• Black
leather

• Cherry
finish legs



PAC51-V18
PAC52-V18
YLD09 (2)

lounge it.



Overall Size
28.5"Wx6.25"Dx20"H



WST51P-B18

Black

WST51P-E34

Espresso
List \$295
Charging Center
Console ●

NEW!

Use this
to make
this!



WST51OP-B18

Black

WST51OP-E34

Espresso
List \$495
Charging Center
Ottoman ●

NEW!

lounge it.

Overall Size
29.25"Wx29.25"Dx17.5"H



WST51A-B18

Black

WST51A-E34

Espresso
List \$540
Arm Chair ●

• Chrome
frame

lounge it.



Overall Size
30.5"Wx28"Dx31"H

WST51RF-B18

Black

WST51RF-E34

Espresso
List \$485
Right Arm Facing
Modular
Component ●

lounge it.



Overall Size
27"Wx28"Dx31"H

WST51C-B18

Black

WST51C-E34

Espresso
List \$540
Corner Modular
Component ●

lounge it.



Overall Size
28"Wx28"Dx31"H

WST51LF-B18

Black

WST51LF-E34

Espresso
List \$485
Left Arm Facing
Modular Component ●

lounge it.



Overall Size
27"Wx28"Dx31"H

WST51N-B18

Black

WST51N-E34

Espresso
List \$405
Armless Facing
Modular
Component ●

lounge it.



Overall Size
23"Wx28"Dx31"H

• (-B18)
Black, or (-E34)
Espresso

**(-W32 White Faux
Leather is available for
all pieces. Please allow
7-10 business days.)**

All items on
this page
have achieved
GREENGUARD
Certification.





MUP51-R107 (3)

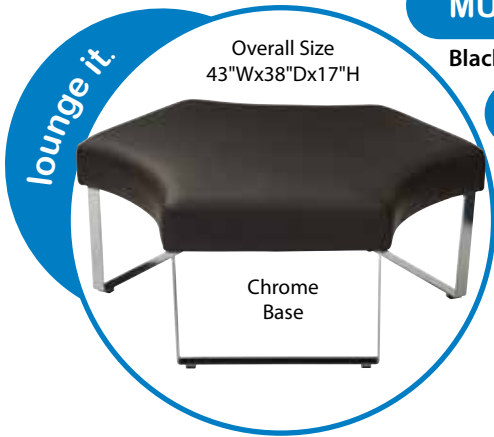

Overall Size
43"Wx38"Dx17"H

Chrome
Base

MUP51-R107

Black Antimicrobial Vinyl

MUP51-R101

Snow Antimicrobial Vinyl
List \$495



MUP51-R101

This is a great look!

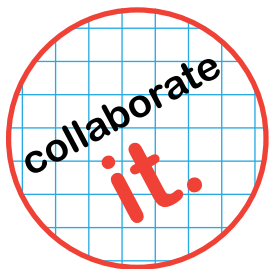

MUP51-R107 (2)



WST51LF-W32
WST51N-W32 (2)
WST51RF-W32
WST51A-W32
WST12-WH
WST17-WH (2)
WST07-WH

(-W32 White Faux Leather is available for all pieces. Please allow 7-10 business days.)

lounge it.

Espresso Finish Top

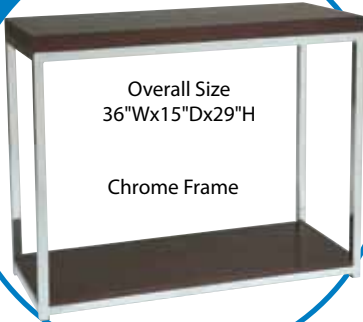

Overall Size
36"Wx15"Dx29"H

Chrome Frame

WST07-ESP

Espresso

WST07-BK

Black

WST07-WH

White

List \$450
Sofa Table

lounge it.

Black Wood Veneer Top

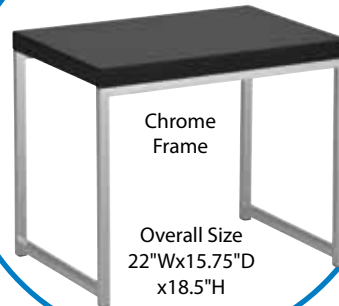

Chrome
Frame

Overall Size
22"Wx15.75"D
x18.5"H

WST09-ESP

Espresso

WST09-BK

Black

WST09-WH

White

List \$185
End Table

Great Contemporary Design!

lounge it.

White Wood Veneer Top



Chrome Frame

Overall Size
28"Wx28"Dx17"H

WST17-ESP

Espresso

WST17-BK

Black

WST17-WH

White

List \$330
Corner Table

lounge it.

Black Wood Veneer Top

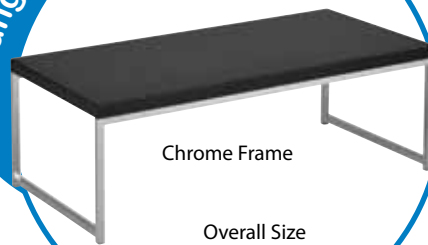

Chrome Frame

Overall Size
44"Wx22"Dx15"H

WST12-ESP

Espresso

WST12-BK

Black

WST12-WH

White

List \$290
Coffee Table

All items on
this page
have achieved
GREENGUARD
Certification.



ATH51-B18

Black Faux Leather

ATH51-W32

White Faux Leather

ATH51-K26

Charcoal Klein Fabric
List \$500

ATH52-B18

Black Faux Leather

ATH52-W32

White Faux Leather

ATH52-K26

Charcoal Klein Fabric
List \$850

YLD14

List \$115

WST16-ESP

Espresso

WST16-BK

Black

WST16-WH

White
List \$250
Side Table

YLD12

List \$235
Coffee Table

YLD09

List \$160
End Table

YLD07

List \$330
Sofa Table

YLD17

List \$235
Corner Table

- Black glass top
- Chrome frame

Nice Detail!

Such a sleek Design!

DVS51-K21

Klein Sea
List \$425
Club Chair



Espresso arms and legs

Overall Size
28.5"Wx26.75"D
x31.75"H

-K21
Klein Sea

-K12
Klein Otter

-L32
Linen

DVS52-K12

Klein Otter
List \$695
Loveseat



Espresso arms and legs

Overall Size
51.75"Wx29.25"D
x31.75"H

-K21
Klein Sea

-K12
Klein Otter

-L32
Linen

NEW!

Gotta have this!

MST55-W12

Woven Charcoal
List \$275
Club Chair



Espresso legs

Overall Size
24.25"Wx26.5"D
x34.5"H

-W12
Woven Charcoal

-S22
Woven Seaweed

MST51-S22

Woven Seaweed
List \$525
Club Chair



Espresso legs

Overall Size
30"Wx29.5"D
x32"H

-W12
Woven Charcoal

-S22
Woven Seaweed

get it.

MST51-K1R7

Black/Onyx
List \$725
Club Chair



Overall Size
30"Wx29.5"D
x32"H

MST52-K6R4

Buff/Birch
List \$1,025
Loveseat



Espresso arms and legs

Overall Size
49.25"Wx29.5"D
x32"H

-K6R4
Buff/Birch

-K1R7
Black/Onyx

MST52-W12

Woven Charcoal
List \$725
Loveseat



Espresso arms and legs

Overall Size
49.25"Wx29.5"Dx32"H

MST53-S22

Woven Seaweed
List \$995
Sofa



Overall Size
75"Wx30.5"Dx32.5"H

-W12
Woven Charcoal

-S22
Woven Seaweed

(All accent seating is in stock in California. Please allow 7-10 business days.)

Cannot be shipped FedEx/UPS.

The Look



OFD-LOOK-

White LeatherSoft
List \$695
Club Chair

NEW!

-9
Black
LeatherSoft

-RED
Bright Red
LeatherSoft

-10
White
LeatherSoft

-11
Brown
LeatherSoft

The Curve



OFD-CUR-

Black LeatherSoft
List \$995
Club Chair

-9
Black
LeatherSoft

-11
Brown
LeatherSoft

-10
White
LeatherSoft

-15
Red
LeatherSoft

Cool base!

Finish Options for
MRG12SR1, MRG09S, MRG12, MRG09, MRG07R1

-BK
Black

-CHE
Cherry

-MAH
Mahogany

-ESP
Espresso



MRG12SR1-

Choose a finish
List \$450
Square Coffee Table

MRG09S-

Choose a finish
List \$349
Square End Table



MRG12-

Choose a finish
List \$595
Round Coffee Table

MRG09-

Choose a finish
List \$315
Round End Table



MRG07R1-

Choose a finish
List \$469
Foyer Table



MST12

Espresso
List \$275
Coffee Table



MST19

Espresso
List \$275
Nesting Table

So many options!!

(All accent seating is in stock in California. Please allow 7-10 business days.)

Cannot be shipped FedEx/UPS.

(Use Seating Discount on Chairs Below)

Great Value and Style!

guest it.



(-44) Black Fabric

GI-100-CHE

Cherry

GI-100-MAH

Mahogany

GI-100-ESP

Espresso

GI-100-WAL

Walnut Strand List \$295

Matches laminate series

guest it.



(-44) Black Fabric

GI-125-CHE

Cherry

GI-125-MAH

Mahogany

GI-125-ESP

Espresso

GI-125-WAL

Walnut Strand List \$315

Matches laminate series

guest it.



(-33) Black Fabric

K-129-LCH

Light Cherry

K-129-MAH

Mahogany

K-129-ESP

Espresso

List \$400

Matches reeded edge wood series

guest it.



(-33) Black Fabric

K-99-LCH

Light Cherry

K-99-MAH

Mahogany

K-99-ESP

Espresso

List \$380

Matches reeded edge wood series

K - Kent
M - Madison

guest it.



(-33) Black Fabric

M-94-CHY

Satin Cherry

List \$510

Matches inlay wood series

guest it.



Wrap Around Back

(-03) Black Vinyl

Padded Arms

(-JTO) Oxblood Vinyl

TR-102-JTO

Oxblood

TR-102-03

Black Vinyl List \$225

No Casters

TR-101-03

Black Vinyl

TR-101-JTO

Oxblood

List \$235

With Casters

• Mahogany finish wood frame

Cannot be shipped FedEx/UPS.

guest it.



(-316) Taupe Fabric

GI-300C-

Cherry

List \$280

Choose -316, -363 or -U6 fabric

-363
Black Triangle

-U6
Black Faux Leather

guest it.



(-363) Black Triangle Fabric

GI-300M-

Mahogany

List \$280

Choose -316, -363 or -U6 fabric

-U6
Black Faux Leather

-316
Taupe

Love it!

guest it.



(-U6) Black Faux Leather

GI-300E-

Espresso

List \$280

Choose -316, -363 or -U6 fabric

-363
Black Triangle

-316
Taupe

guest it.



(-363) Black Triangle Fabric

GI-400C-

Cherry

List \$400

Choose -316, -363 or -U6 fabric

-U6
Black Faux Leather

-316
Taupe

guest it.



(-316) Taupe Fabric

GI-400M-

Mahogany

List \$400

Choose -316, -363 or -U6 fabric

-363
Black Triangle

-U6
Black Faux Leather

guest it.



(-U6) Black Faux Leather

GI-400E-

Espresso

List \$400

Choose -316, -363 or -U6 fabric

-363
Black Triangle

-316
Taupe

guest it.



(-MAH) Mahogany (-363) Black Triangle Fabric

WD300-

Add on Kit

Choose a finish and a fabric

List \$215

Kit includes: 1 middle arm, 1 seat and 1 back ONLY
GI-300 is needed to complete

-CHE
Cherry

-MAH
Mahogany

-ESP
Espresso

-363
Black Triangle

-U6
Black Faux Leather

-316
Taupe

Wow!



82740-30

List \$205
Stacks 4-6 high

stack it.

Titanium
Finish
Frame



(-30) Coal
FreeFlex®
Fabric Seat and
Back

Love it!?

86710-30

List \$205
Stacks 4-6 high

stack it.

Titanium
Finish
Frame



(-30) Coal
FreeFlex®
Fabric Seat and
Back

86724-30

List \$205
Stacks 4-6 high

stack it.

Titanium
Finish
Frame



(-30) Coal
FreeFlex®
Fabric Seat and
Back

Get it!

86725-30

List \$225
Stacks 4-6 high

stack it.

Titanium
Finish
Frame



(-30) Coal
FreeFlex®
Fabric Seat and
Back

DC8309C

List \$200

stack it.

Plastic Seat
and Back



Overall Size
19.75"Wx22"D
x44"H

Chrome Sled
Base

SI-1104-231

List \$200
Stacks 4-6 high

stack it.

Black Finish
Frame



(-231) Black
Icon Fabric
Back and Seat

All items on
this page
have achieved
GREENGUARD
Certification.



stack it.

Stack it!

8610-30

List \$185
Stacks 4-6 high

stack it.

Titanium
Finish
Frame

(-30) Coal
FreeFlex®
Fabric Seat and
Plastic Back

8455-30

List \$135
Stacks 4-6 high

stack it.

Chrome
Sled
Base

(-30) Coal
FreeFlex®
Fabric Seat and
Plastic Back

8620-30

List \$170
Stacks 4-6 high

stack it.

(-30) Coal
FreeFlex®
Fabric Seat and
Plastic Back

Titanium Finish
Frame

OFD-865-3

List \$132
Stacks 4-6 high

stack it.

Plastic Seat
and Back

Chrome Sled
Base

Just what
we need!

STC8302C4-3

List \$110
Stacks 4-6 high

stack it.

Plastic Seat
and Back

Chrome
Sled
Base

get it.

64 we stock it.

Cannot be shipped FedEx/UPS.

STC18A4-2

Gray

Seat Height:
17.5"H

STC18A4-3

Black

STC18A4-11

White
List \$115

stack it.

Metal Seat
and Back



This could work
for our breakroom!

stack it.



DOL06

List \$140
Holds 30 chairs
for SI-1106-3

stack it.

Plastic Seat
and Back



Black Frame

SI-1106-3

List \$125
Stacks 35 high

stack it.

Plastic Seat
and Back



Chrome Sled
Base

OFD-3030-3

List \$132
Stacks 4-6 high

stack it.

Plastic Seat
and Back



Black Frame

SI-1107-3

List \$105
Stacks 20 high

stack it.

Plastic Seat
and Back



Chrome Sled
Base

STC866C4-7

Blue

STC866C4-4

Burgundy

STC866C4-3

Black
List \$132
Stacks 4-6 high

stack it.



(Dolly Only)

DOL865

List \$175
Holds 28 chairs for
OFD-865-3 &
OFD-3030-3

DOL8302

List \$175
Holds 28 chairs
for STC8302C4-3



(All Chairs and Stools Available with Wood or Vinyl Seat)

Awesome Value!

café it.



Black Powder Coat Frame

Seat Height: 19.75"H

(-B6) Black Vinyl Seat

CI-850-B6

List \$259

Choose -B6, or -MAH seat

-MAH
Mahogany Seat



CI-825-B6 (4) & CI-BAR30R-LCH shown

Lunch time!

CI-800-MAH

List \$259

Choose -B6, or -MAH seat

-B6
Black Vinyl Seat

café it.



Black Powder Coat Frame

Seat Height: 19.5"H

(-MAH) Mahogany Seat

café it.



Black Powder Coat Frame

Seat Height: 31"H

(-B6) Black Vinyl Seat

CI-825-B6

List \$319

Choose -B6, or -MAH seat

-MAH
Mahogany Seat

café it.



Black Powder Coat Frame

Seat Height: 30.25"H

(-MAH) Mahogany Seat

CI-875-MAH

List \$319

Choose -B6, or -MAH seat

-B6
Black Vinyl Seat



CI-850-B6 (4)
CI-BREAK-X30SQ-WAL

get it.

All Tables are 29"H. All Bar Tables are 41.5"H.

Dress up your table with these new colors!

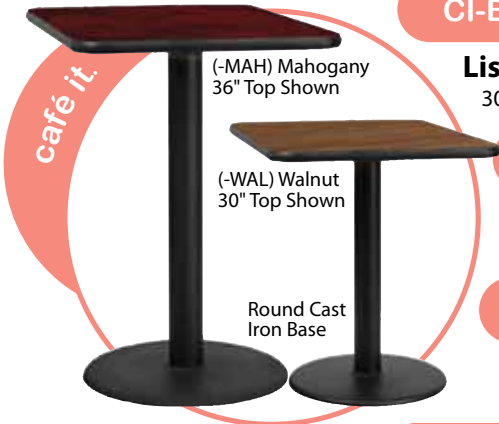

CI-BREAK30SQ

List \$500
30" x 30" Square Table

CI-BREAK36SQ

List \$639
36" x 36" Square Table

CI-BAR30SQ

List \$589
30" x 30" Square Table

CI-BAR36SQ

List \$679
36" x 36" Square Table



CI-BREAK30R

List \$500
30" Dia. Round Table

CI-BREAK36R

List \$639
36" Dia. Round Table

CI-BAR30R

List \$589
30" Dia. Round Table

CI-BAR36R

List \$679
36" Dia. Round Table

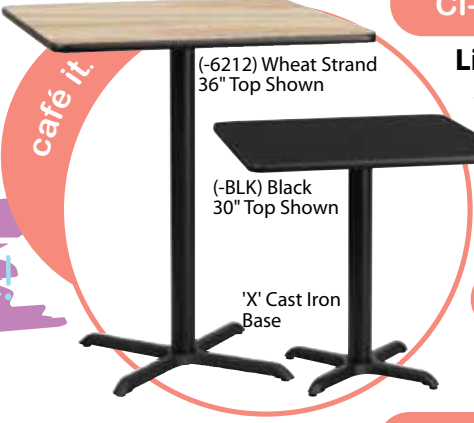

CI-BREAK-X30SQ

List \$500
30" x 30" Square Table

CI-BREAK-X36SQ

List \$639
36" x 36" Square Table

CI-BAR-X30SQ

List \$589
30" x 30" Square Table

CI-BAR-X36SQ

List \$679
36" x 36" Square Table

Tables available with an X base or round base!



CI-BREAK-X30R

List \$500
30" Dia. Round Table

CI-BREAK-X36R

List \$639
36" Dia. Round Table

CI-BAR-X30R

List \$589
30" Dia. Round Table

CI-BAR-X36R

List \$679
36" Dia. Round Table



Burnt Strand Top



Wheat Strand Top



Wenge Strand Top



(-BLK) Black Top



(-MAH) Mahogany Top



(-LCH) Light Cherry Top



(-WAL) Walnut Top

BLK/MAH and LCH/WAL table tops are double-sided.



BRW29A4-

List \$195

Choose a color ^{OS}



Powder Coat Steel Frame

(-AW) Antique White



Powder Coat Steel Frame

(-ASB) Antique Sky Blue

Seat Height: 26"H

BRW3026A4-

List \$141

Choose a color ^{OS}

LOVE it!

Yes!!

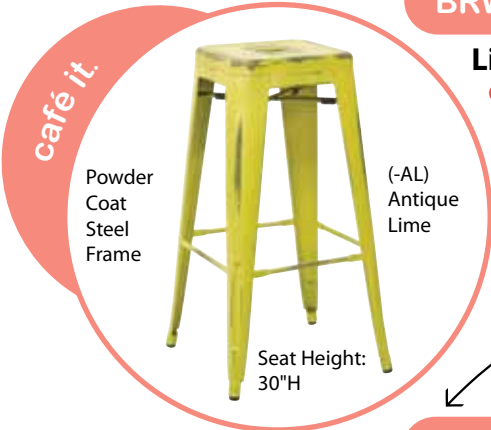

Powder Coat Steel Frame

(-AL) Antique Lime

Seat Height: 30"H

BRW3030A4-

List \$162

Choose a color ^{OS}



(-C216) Pastel Pink

Overall Size 30"Wx30"Dx29.75"H

ALB43211-

List \$390

Choose a color below ^{OS}

(-C216) Pastel Pink

Flip Top!

(-P702) Pastel Lemon

(-P704) Pastel Quarry

(-11) White

(-P705) Pastel Teal



(-CP) Copper

Overall Size 26"Wx26"D x29"H

BRW432-

List \$390

Choose a color below ^{OS}

(-AW) Antique White

(-AB) Antique Black

(-ARD) Antique Red

(-ASB) Antique Sky Blue

(-AY) Antique Yellow

(-AOR) Antique Orange

(-AC) Antique Copper

(-CP) Copper



BRW432-ARD

(All items above are in stock in California. Please allow 7-10 business days.)

Cannot be shipped FedEx/UPS.

Oversized Seating Item - Check Shipping Program

T-Rex Series

add it.



OFD-TREX2-GM

Dual Monitor Arm Grommet Mount

Holds up to 24" Monitors

Compare Price!

OFD-TREX2-CM

Dual Monitor Arm Clamp Mount
List \$399

• Effortlessly adjust the angle and focal depth of your flat-screen monitor for either seated or standing applications

- Impressive 4" - 21" horizontal travel range
- Accommodates all VESA-compliant monitors weighing up to 25 pounds
- Available in both clamp- and grommet-mount versions

- Unique pivot assembly fine tunes monitor angle and height
- Swivel assembly allows flexibility to adjust the monitor for portrait or landscape views

add it.



OFD-TREX1-GM

Single Monitor Arm Grommet Mount

OFD-TREX1-CM

Single Monitor Arm Clamp Mount
List \$269

We'll need these!

get it.

add it.



OFD-200-DR

Plastic Center Drawer

List \$85
• 21"x18.125"x2"

add it.



OFD-800-CPU

Metal CPU Holder

List \$199

- Retractable
- Swivels 360°
- CPU case size: 3.75"-8.25"W x 12"-20.5"H

cube it.



Ultra2 Panel System

Ultra2 Systems. OEM Compatible. Ultra2 Systems offers fabric and glass panels in varying heights with a 6" raceway to meet electrical and data needs. There are multiple work surfaces, components and accessories. Ultra2 is the ideal combination of value and performance. The possibilities are endless! Ultra2 provides you with the flexibility to design your space to meet your needs – from cluster-working environments, to private offices – you can design Ultra2 to work for you. Utilizing low panel height you can create a teaming environment, or integrate high panels to create a more private configuration. Ultra2 now has three distinctive, in-stock fabrics and four options for work surfaces. Let Ultra2 be your in-stock solution for your office space. Free space planning is available.

*In Stock!
Ready to Ship!*

*3 Fabric Choices!
4 Laminate Choices!*

get it.

70 we stock it.

ULTRA2 | Typical Workstations



OFD-U2-66538
53" Tall - 8-Pod Workstation
 6'x6'
 Includes Powered Spine, Base
 Power Feed, BBF Pedestal, Partial
 Glass and 1 Receptacle
List \$34,696
List per Station \$4,337



**Honey Wheat
 Fabric**



**Cloud White
 Laminate**



OFD-U2-24534
53" high 4-Pod Workstation
 2'x4'
 Includes Powered Spine, Base
 Power Feed, BBF Pedestal, and
 1 Receptacle per Station
List \$9,572
List per Station \$2,393



**Midnight Stone
 Fabric**

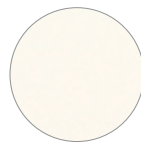

**Cloud White
 Laminate**



OFD-U2-66534
53" high 4-Pod Workstation
 6'x6'
 Includes Powered Spine, Base
 Power Feed, BBF/FF Pedestal,
 2 Receptacles, and a 48" Half
 Shelf per Station
List \$20,140
List per Station \$5,035



**Whiteburst
 Fabric**



**Wild Cherry
 Laminate**



OFD-U2-67534
53" high 4-Pod Workstation
 6'x7'
 Includes Powered Spine, Base
 Power Feed, BBF Pedestal, 2
 Receptacles and a Half Shelf
 per Station
List \$21,749
List per Station \$5,437



**Whiteburst
 Fabric**



**Wild Cherry
 Laminate**



OFD-U2-55534
53" high 4-Pod Workstation
 5'x5'
 Includes Powered Spine, Base
 Power Feed, BBF Pedestal,
 1 Receptacle and a Half Shelf
 per Station
List \$18,526
List per Station \$4,632



**Whiteburst
 Fabric**



**Cloud White
 Laminate**

Ultra2 Panel System

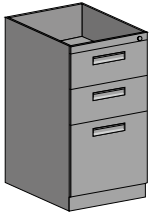

OFD-BBF
Pedestal Box/Box/File
27.5"Hx15"Wx20"D
List \$602

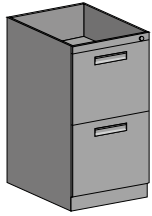

OFD-FF
Pedestal File/File
27.5"Hx15"Wx20"D
List \$602

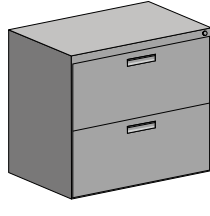

OFD-LAT30
Lateral File Pedestal
27.5"Hx30"Wx20"D
List \$1,346



OFD-PFDU-24
24"W Painted
Flipper Door Unit
List \$412



OFD-PFDU-30
30"W Painted
Flipper Door Unit
List \$441



OFD-PFDU-36
36"W Painted
Flipper Door Unit
List \$490



OFD-PFDU-48
48"W Painted
Flipper Door Unit
List \$547



OFD-PFDU-60
60"W Painted
Flipper Door Unit
List \$606

OFD-PEDFB
File Bar for Side to Side
Filing on Pedestal
List \$22

OFD-LATFB
File Bar for Front to Back
Filing on Lateral File
List \$24



OFD-HALFSHELF24 - 24" "B" Style Shelf, Half Height End Panels List \$163
OFD-HALFSHELF30 - 30" "B" Style Shelf, Half Height End Panels..... List \$177
OFD-HALFSHELF36 - 36" "B" Style Shelf, Half Height End Panels List \$193
OFD-HALFSHELF48 - 48" "B" Style Shelf, Half Height End Panels List \$216
OFD-HALFSHELF60 - 60" "B" Style Shelf, Half Height End Panels List \$239



OFD-SHELF24 - 24" "B" Style Shelf, Full Height End Panels..... List \$191
OFD-SHELF30 - 30" "B" Style Shelf, Full Height End Panels..... List \$205
OFD-SHELF36 - 36" "B" Style Shelf, Full Height End Panels List \$221
OFD-SHELF48 - 48" "B" Style Shelf, Full Height End Panels List \$244
OFD-SHELF60 - 60" "B" Style Shelf, Full Height End Panels List \$267



OFD-LED.20 - Task Light for Overhead/Shelf List \$240
OFD-LED.38 - Task Light for Overhead/Shelf List \$270
OFD-WM - Wire Manager for Task Lights List \$19

Tackboard available in all fabrics.



OFD-UTACK24 - Tackboard 24"x15.5" ... List \$165
OFD-UTACK30 - Tackboard 30"x15.5" ... List \$176
OFD-UTACK36 - Tackboard 36"x15.5" ... List \$183
OFD-UTACK48 - Tackboard 48"x15.5" ... List \$204
OFD-UTACK60 - Tackboard 60"x15.5" ... List \$227

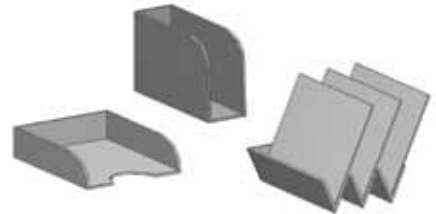

OFD-TRAY - Letter Size Tray 12"x10"x3" List \$84
OFD-VTRAY - Vertical Single Tray 12"x4"x8" List \$84
OFD-3VTRAY - Vertical Triple Tray 12"x4"x8" .. List \$107

OFD-START39 - Wall Start for 39" Panel... List \$59
OFD-START53 - Wall Start for 53" Panel... List \$59
OFD-START67 - Wall Start for 67" Panel... List \$61

OFD-STRIP60 - Wall Strip - 60" List \$77
OFD-STRIP72 - Wall Strip - 72" List \$83

Tool Bar for Trays and Sorter



OFD-TB24 - Tool Bar 24" List \$93
OFD-TB30 - Tool Bar 30" List \$100
OFD-TB36 - Tool Bar 36" List \$108
OFD-TB48 - Tool Bar 48" List \$125
OFD-TB60 - Tool Bar 60" List \$136

OFD-DCL
Dual Column Leg
Support
List \$184
Additional Work Surface
Support Leg, Black
27¾"Hx18"D

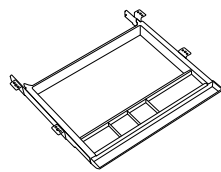
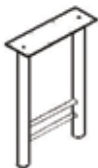

OFD300DR - Center Drawer
List \$130



OFD-TRRS-24 - Transaction Top - Rectangle 14"x 24" List \$141
OFD-TRRS-30 - Transaction Top - Rectangle 14"x 30" List \$162
OFD-TRRS-36 - Transaction Top - Rectangle 14"x 36" List \$174
OFD-TRRS-48 - Transaction Top - Rectangle 14"x 48" List \$212

OFD-TRCS-24 - Transaction Top - Corner 14"x24" List \$267
OFD-TRCS-30 - Transaction Top - Corner 14"x30" List \$368
OFD-TRCS-36 - Transaction Top - Corner 14"x36" List \$393
OFD-TRCS-48 - Transaction Top - Corner 14"x48" List \$558

OFD-TRES - Transaction Surface END Support List \$34
OFD-TRMES - Transaction Surface MID/END Support... List \$34
OFD-TRCS - Transaction Surface CENTER Support List \$35

OFD-Pole-39E - Power Pole to Connect to a 39" High Panel List \$671
OFD-Pole-53E - Power Pole to Connect to a 53" High Panel List \$671
OFD-Pole-67E - Power Pole to Connect to a 67" High Panel List \$671

OFD-Pole-39N - Data Pole to Connect to a 39" High Panel List \$303
OFD-Pole-53N - Data Pole to Connect to a 53" High Panel List \$303
OFD-Pole-67N - Data Pole to Connect to a 67" High Panel List \$303

OFD-BPF - Base Power Feed List \$341

Ultra2 Panel System



ULTRA2



Non-Power Panels

- OFD-3924N - Fabric Panel - Empty Raceway List \$376
- OFD-3930N - Fabric Panel - Empty Raceway List \$411
- OFD-3936N - Fabric Panel - Empty Raceway List \$463
- OFD-3948N - Fabric Panel - Empty Raceway List \$513

- OFD-5324N - Fabric Panel - Empty Raceway List \$406
- OFD-5330N - Fabric Panel - Empty Raceway List \$460
- OFD-5336N - Fabric Panel - Empty Raceway List \$506
- OFD-5348N - Fabric Panel - Empty Raceway List \$617
- OFD-5360N - Fabric Panel - Empty Raceway List \$747

- OFD-6724N - Fabric Panel - Empty Raceway List \$471
- OFD-6730N - Fabric Panel - Empty Raceway List \$528
- OFD-6736N - Fabric Panel - Empty Raceway List \$610
- OFD-6748N - Fabric Panel - Empty Raceway List \$692
- OFD-6760N - Fabric Panel - Empty Raceway List \$831

- OFD-5324GPN - Partial Glazed Fabric Panel - Empty Raceway..... List \$616
- OFD-5330GPN - Partial Glazed Fabric Panel - Empty Raceway..... List \$671
- OFD-5336GPN - Partial Glazed Fabric Panel - Empty Raceway..... List \$808
- OFD-5348GPN - Partial Glazed Fabric Panel - Empty Raceway..... List \$930

- OFD-6724GPN - Partial Glazed Fabric Panel - Empty Raceway..... List \$681
- OFD-6730GPN - Partial Glazed Fabric Panel - Empty Raceway..... List \$738
- OFD-6736GPN - Partial Glazed Fabric Panel - Empty Raceway..... List \$879
- OFD-6748GPN - Partial Glazed Fabric Panel - Empty Raceway..... List \$1,078

Corner Work Surfaces



- OFD-2436WSCC - Curved Corner Work Surface 24"x36" List \$518
- OFD-2448WSCC - Curved Corner Work Surface 24"x48" List \$675

Rectangle Work Surfaces



- OFD-2424WS - Work Surface Rectangle 24"x24" List \$243
- OFD-2430WS - Work Surface Rectangle 24"x30" List \$285
- OFD-2436WS - Work Surface Rectangle 24"x36" List \$296
- OFD-2448WS - Work Surface Rectangle 24"x48" List \$385
- OFD-2460WS - Work Surface Rectangle 24"x60" List \$480
- OFD-2472WS - Work Surface Rectangle 24"x72" List \$554

Bullet Work Surface

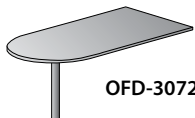

- OFD-3072BUL - Bullet Work Surface 30"x72" List \$684

Power Panels

- OFD-3924E - Fabric Panel - Electric Raceway List \$527
- OFD-3930E - Fabric Panel - Electric Raceway List \$565
- OFD-3936E - Fabric Panel - Electric Raceway List \$616
- OFD-3948E - Fabric Panel - Electric Raceway List \$664

- OFD-5324E - Fabric Panel - Electric Raceway List \$556
- OFD-5330E - Fabric Panel - Electric Raceway List \$614
- OFD-5336E - Fabric Panel - Electric Raceway List \$691
- OFD-5348E - Fabric Panel - Electric Raceway List \$770
- OFD-5360E - Fabric Panel - Electric Raceway List \$871

- OFD-6724E - Fabric Panel - Electric Raceway List \$620
- OFD-6730E - Fabric Panel - Electric Raceway List \$680
- OFD-6736E - Fabric Panel - Electric Raceway List \$762
- OFD-6748E - Fabric Panel - Electric Raceway List \$844
- OFD-6760E - Fabric Panel - Electric Raceway List \$976

- OFD-5324GPE - Partial-Glazed Fabric Panel - Electric Raceway..... List \$767
- OFD-5330GPE - Partial-Glazed Fabric Panel - Electric Raceway..... List \$823
- OFD-5336GPE - Partial-Glazed Fabric Panel - Electric Raceway..... List \$961
- OFD-5348GPE - Partial-Glazed Fabric Panel - Electric Raceway..... List \$1,082

- OFD-6724GPE - Partial-Glazed Fabric Panel - Electric Raceway..... List \$831
- OFD-6730GPE - Partial-Glazed Fabric Panel - Electric Raceway..... List \$891
- OFD-6736GPE - Partial-Glazed Fabric Panel - Electric Raceway..... List \$1,033
- OFD-6748GPE - Partial-Glazed Fabric Panel - Electric Raceway..... List \$1,157

Draw Rods



- OFD-DR39 - Draw Rod for 39" 2 Way Connection 180° List \$24
- OFD-DR53 - Draw Rod for 53" 2 Way Connection 180° List \$25
- OFD-DR67 - Draw Rod for 67" 2 Way Connection 180° List \$25

Connectors



- OFD-2W39 - 2 Way 39" Connector 90° List \$137
- OFD-2W53 - 2 Way 53" Connector 90° List \$168
- OFD-2W67 - 2 Way 67" Connector 90° List \$184

- OFD-3W39 - 3 Way 39" Connector 90° List \$158
- OFD-3W53 - 3 Way 53" Connector 90° List \$200
- OFD-3W67 - 3 Way 67" Connector 90° List \$236

- OFD-4W39 - 4 Way 39" Connector 90° List \$163
- OFD-4W53 - 4 Way 53" Connector 90° List \$210
- OFD-4W67 - 4 Way 67" Connector 90° List \$278

Finished End Trim



- OFD-FE39 - Finished End Trim for 39" Panel List \$64
- OFD-FE53 - Finished End Trim for 53" Panel List \$80
- OFD-FE67 - Finished End Trim for 67" Panel List \$90
- OFD-FECHANGE - Finished End Trim Change of Height Panel. List \$25

Ultra2 | Specifications

Thermofused Laminate Tops

Ultra2 Laminates are selected from premium grade laminates. The Ultra2 Collection is offered in 4 Laminate Finishes. Light Gray is on one side, Brushed Nickel on the other and Cloud White is on one side, Wild Cherry on the other, all with Dark Tone 3mm edge band. Tops are 1-1/8" thick and feature a profiled 3mm edge on all four sides. Tops are installed with pins and buttons.

Fabric: WHB - Whiteburst, MNS - Midnight Stone, HW - Honey Wheat

Paint: DTE - Dark Tone

Trim: DTE - Dark Tone

(All prices in this price list for the work surfaces include the work surface top, 1 pair of mounting cantilevers, pins and buttons to secure work surfaces, and 1 mending bracket. Corner work surfaces include above plus additional corner bracket, grommet and cover. All items above will be listed on your acknowledgement, itemized under each part number.

Pedestals - 20" Deep, BBF and FF style, with locks - "B" Style Fronts

Locks

All pedestals, lateral pedestals, and overheads come standard with lock. All units are keyed random. Requests for different keying can be accommodated, and must be specified.



Optional **W001-W050**
Lock core and keys

List \$25

Panels

Panels are 2" thick, fabric covered on both sides and feature a steel frame, with a painted aluminum top cap. Each panel comes standard with leveling glides and 2 raceway covers. Electric panels come standard with the wiring harness installed, 2 raceway covers with notched receptacle openings and covers, and a panel-to-panel electric connector. (Order receptacles separately) All items above will be listed on your acknowledgement itemized under each part number.

A pass through cable must be ordered separately when connecting power through a 3-way or 4-way connector.

All Power is UL Listed



In Stock Options



Cloud White
Laminate
Side 1



Wild Cherry
Laminate
Side 2

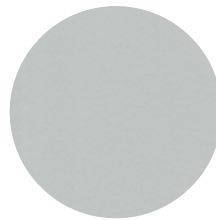

Light Gray
Laminate
Side 1

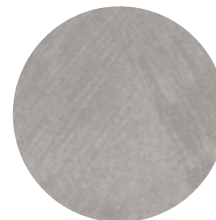

Brushed Nickel
Laminate
Side 2



Dark Tone - Paint, Trim,
and Edge Band



Honey Wheat Fabric

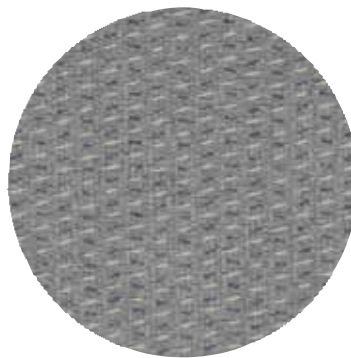

Midnight Stone Fabric



Whiteburst Fabric

Casegood Finishes



Kent - LCH
(pg. 2-4)



Kent - MAH
(pg. 2-4)



Kent - ESP
(pg. 2-4)



Madison - CHY
(pg. 5-7)

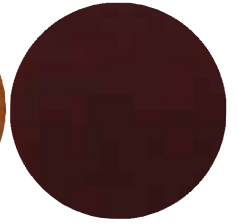

Madison - FMAH
(pg. 5-7)



Nexus - CHY
(pg. 8-10)



Nexus - MAH
(pg. 8-10)



Nexus - ESP
(pg. 8-10)



Ultra - CHY
(pg. 11-13)



Ultra - MAH
(pg. 11-13)

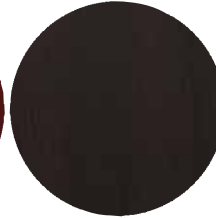

Ultra - ESP
(pg. 11-13)



Ultra - WAL
(pg. 11-13)

Seating Fabrics

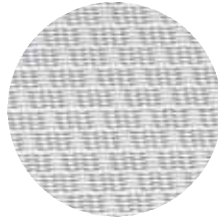

**White
Breathable Mesh**

317W-W1C1F2W (pg. 28),
317W-W11C1F2W (pg. 28)

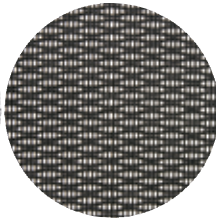

**Black
Breathable Mesh**

2300 (pg. 32), 839-11B35WA
(pg. 34), 69220C-EC3
(pg. 35), DC2990-231
(pg. 37), DC2990V (pg. 37),
MI-95893 (pg. 42), MI-4102-3
(pg. 44) MI-1800-3 (pg. 44),
69906-3 (pg. 44)



**Light
AirGrid®**

317-6C61F6 (pg. 29),
317-ME36C61F6 (pg. 29)



**Dark
AirGrid®**

5500SL (pg. 31), 5700SL
(pg. 31), 5700SL
(pg. 32), 5700E (pg. 32), 5505
(pg. 32), 57906E
(pg. 33), 335-E37P918P
(pg. 33), 5540 (pg. 33), 55403
(pg. 33), 75-37A773 (pg. 34),
63-37A773HM (pg. 34),
75-47A773 (pg. 34),
13-37N20D (pg. 36),
15-37A720D (pg. 36),
213-37N2F3D (pg. 36),
213-37N2F3D (pg. 36)

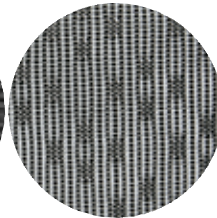

SpaceGrid®

529-M3R2N6F2 (pg. 30),
529-R22N1F2 (pg. 30),
529-E3R2N1F2 (pg. 30),
529-3R2N1F2 (pg. 30)

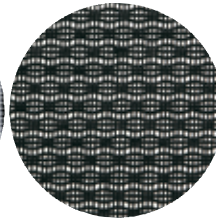

**Black
ProGrid®**

92583-30 (pg. 37) NI-1200-30
(pg. 39), NI-1000-30 (pg. 39),
MI-2102- (pg. 41), MI-2502-
(pg. 41), MI-97728-EC3
(pg. 41), MI-97720-30 (pg. 41),
MI-93720 (pg. 41), MI-1122-30
(pg. 42), MI-1522-30 (pg. 42),
MI-1500-30 (pg. 42),
85670-30 (pg. 42), 85640-30
(pg. 42), MI-2817 (pg. 44),
MI-28174 (pg. 44), 86724-30
(pg. 63), 86725-30 (pg. 63),
86710-30 (pg. 63)



**White
ProGrid®**

MI-8810W (pg. 29, pg. 43),
MI-8810S (pg. 29, pg. 43),
MI-95672 (pg. 43), MI-95673
(pg. 43)

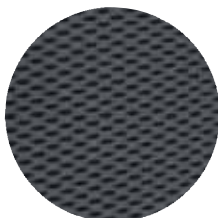

Black Mesh

529-M3R2N6F2 (pg. 30),
529-3R2N1F2 (pg. 30),
5500SL (pg. 31), 5500
(pg. 31) 2300 (pg. 32), 5505
(pg. 32), 5540 (pg. 33), 55403
(pg. 33), 75-37A773 (pg. 34),
63-37A773HM (pg. 34),
13-37N20D (pg. 36),
15-37A720D (pg. 36),
213-37N2F3D (pg. 36),
MI-95893 (pg. 42), 183305
(pg. 45)

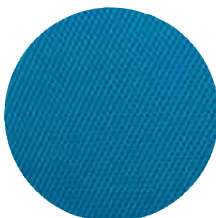

(-7) Blue Mesh

317W-W1C1F2W (pg. 28),
5200W (pg. 28),
317-6C61F6 (pg. 29),
MI-8810W (pg. 29, pg. 43),
MI-8810S (pg. 29, pg. 43),
5500 (pg. 31), 5505
(pg. 32), MI-2102 (pg. 41),
MI-2502 (pg. 41), MI-1122
(pg. 42), MI-1522 (pg. 42),
MI-95672 (pg. 43), MI-95673
(pg. 43)

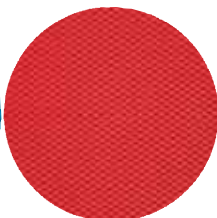

(-9) Red Mesh

317W-W1C1F2W (pg. 28),
5200W (pg. 28),
317-6C61F6 (pg. 29),
MI-8810W (pg. 29, pg. 43),
MI-8810S (pg. 29, pg. 43),
5500 (pg. 31), 5505
(pg. 32), MI-2102 (pg. 41),
MI-2502 (pg. 41), MI-1122
(pg. 42), MI-1522 (pg. 42),
MI-95672 (pg. 43), MI-95673
(pg. 43)

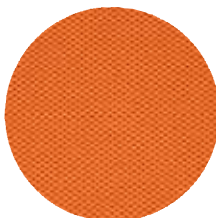

(-18) Orange Mesh

317W-W1C1F2W (pg. 28),
5200W (pg. 28),
317-6C61F6 (pg. 29),
MI-8810W (pg. 29, pg. 43),
MI-8810S (pg. 29, pg. 43),
5500 (pg. 31), 5505
(pg. 32), MI-2102 (pg. 41),
MI-2502 (pg. 41), MI-1122
(pg. 42), MI-1522 (pg. 42),
MI-95672 (pg. 43), MI-95673
(pg. 43)

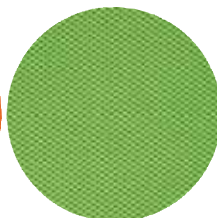

(-6) Green Mesh

317W-W1C1F2W (pg. 28),
5200W (pg. 28),
317-6C61F6 (pg. 29),
MI-8810W (pg. 29, pg. 43),
MI-8810S (pg. 29, pg. 43),
5500 (pg. 31), 5505
(pg. 32), MI-2102 (pg. 41),
MI-2502 (pg. 41), MI-1122
(pg. 42), MI-1522 (pg. 42),
MI-95672 (pg. 43), MI-95673
(pg. 43)

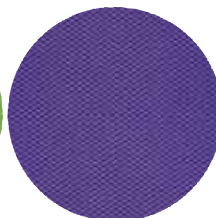

(-512) Purple Mesh

317W-W1C1F2W (pg. 28),
5200W (pg. 28),
317-6C61F6 (pg. 29),
MI-8810W (pg. 29, pg. 43),
MI-8810S (pg. 29, pg. 43),
5500 (pg. 31), 5505
(pg. 32), MI-2102 (pg. 41),
MI-2502 (pg. 41), MI-1122
(pg. 42), MI-1522 (pg. 42),
MI-95672 (pg. 43), MI-95673
(pg. 43)



(-3) Black Mesh

317W-W1C1F2W (pg. 28),
5200W (pg. 28), 317-6C61F6
(pg. 29), MI-8810W (pg. 29,
pg. 43), MI-8810S (pg. 29,
pg. 43), 5505 (pg. 32),
MI-95672 (pg. 43), MI-95673
(pg. 43), MI-4102-3
(pg. 44), MI-1800-3 (pg. 44),
EM51022N-3 (pg. 45)

Seating Fabrics

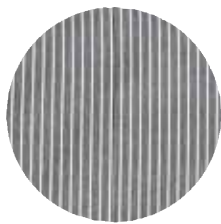

Vertical Mesh Back

30180 (pg. 35)

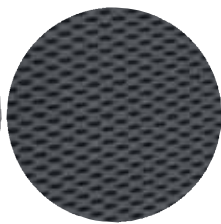

(-3M) Black Mesh

DCY69006-3M (pg. 37)



Breathable Woven Mesh

DC51000NV (pg. 36)



Black Screen

DCY69006-3M (pg. 37),
FC8433-231 (pg. 39),
FC8487-231 (pg. 39),
EM51022N-3 (pg. 45),
183305 (pg. 45)



Black Leather

75-47A773 (pg. 34),
OFD-SL8471
(pg. 54), OFD-SL8472
(pg. 54), OFD-SL8473 (pg. 54)



White Leather

7270 (pg. 46), 7271 (pg. 46),
7275 (pg. 46)



(-3) Black Leather

8200-3 (pg. 46), 8201-3
(pg. 46), 8205-3 (pg. 46)



(-G1) Espresso Glove Soft Leather

OFD-6640-G1 (pg. 46)



(-BLK) Black Faux Leather

OFD-605-BLK (pg. 49),
OFD-7000-BLK (pg. 50),
OFD-7100-BLK (pg. 50),
OFD-7200-BLK (pg. 50)



(-SAD) Saddle Faux Leather

OFD-7000-SAD (pg. 50),
OFD-7100-SAD (pg. 50),
OFD-7200-SAD (pg. 50)



(-W32) White Faux Leather

ATH51-W32 (pg. 58),
ATH52-W32 (pg. 58)



(V) Black Vinyl

DC51000NV (pg. 36)
DC2990V (pg. 37)



(-V18) Black Vinyl

PAC51-V18 (pg. 54),
PAC52-V18 (pg. 54),
PAC53-V18 (pg. 54)



(-V34) Espresso Vinyl

PAC51-V34 (pg. 54),
PAC52-V34 (pg. 54),
PAC53-V34 (pg. 54)



(-U6) Black Faux Leather

FL92017C-U6 (pg. 47),
FL5380C-U6 (pg. 47),
FL5388C-U6 (pg. 47),
FL89675-U6 (pg. 48),
FL9097-U6 (pg. 48), FL3422-U6
(pg. 49), FL7480-U6 (pg. 51),
FL7481-U6 (pg. 51),
FL7485-U6 (pg. 51),
FL7484-U6 (pg. 51), WD300
(pg. 62) GI-300C-U6 (pg. 62),
GI-300M-U6 (pg. 62),
GI-300E-U6 (pg. 62),
GI-400C-U6 (pg. 62),
GI-400M-U6 (pg. 62),
GI-400E-U6 (pg. 62)



(-U11) White Faux Leather

FL5380C-U11 (pg. 47),
FL5388C-U11 (pg. 47),
FL92017C-U11 (pg. 47)

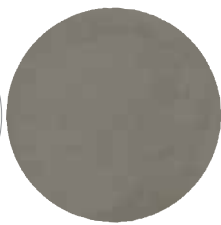

(-U22) Smoke Faux Leather

FL5380C-U22 (pg. 47),
FL5388C-U22 (pg. 47)

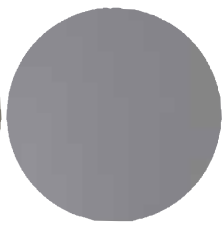

(-U42) Charcoal Gray Faux Leather

FL92017C-U42 (pg. 47)



(-B13) Black Glove Soft Leather

OFD-6640-B13 (pg. 46)

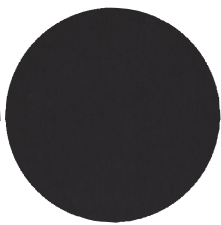

(-B18) Black Faux Leather

WST51P-B18 (pg. 55),
WST51OP-B18 (pg. 55),
WST51A-B18 (pg. 55),
WST51RF-B18 (pg. 55),
WST51C-B18 (pg. 55),
WST51LF-B18 (pg. 55),
WST51N-B18 (pg. 55),
ATH51-B18 (pg. 58),
ATH52-B18 (pg. 58)



(-B6) Black Vinyl

CI-850-B6 (pg. 66), CI-800-B6
(pg. 66), CI-825-B6 (pg. 66),
CI-875-B6 (pg. 66)

Seating Fabrics



Black Eco Leather

317-ME36C61F6 (pg. 29),
335-E37P918P (pg. 33)



(-JTO) Oxblood Vinyl

TR-101-JTO (pg. 61),
TR-102-JTO (pg. 61)



(-03) Black Vinyl

TR-101-03 (pg. 61),
TR-102-03 (pg. 61)



(-E34) Espresso Faux Leather

WST51P-E34 (pg. 55),
WST51OP-E34 (pg. 55),
WST51A-E34 (pg. 55),
WST51RF-E34 (pg. 55),
WST51C-E34 (pg. 55),
WST51LF-E34 (pg. 55),
WST51N-E34 (pg. 55)

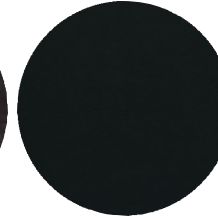

(-EC3) Black Eco Leather

69220C-EC3 (pg. 35),
EC1283C-EC3 (pg. 35),
MI-97728-EC3 (pg. 41),
ECH83507-EC3 (pg. 48),
ECH68807-EC3 (pg. 48),
OFD-6583-EC3 (pg. 49),
OPH61606-EC3 (pg. 49)

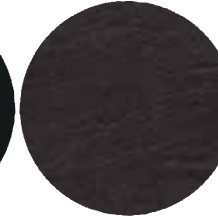

(-EC9) Mocha Eco Leather

EC6582-EC9 (pg. 49)



(-EC10) Latte Eco Leather

OFD-6583-EC10 (pg. 49)

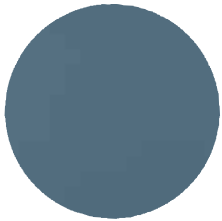

(-R105) Blue Antimicrobial Vinyl

OFD-ST203 (pg. 52),
BC9601 (pg. 52),
BC9602 (pg. 52),
BC9603 (pg. 52)



(-R104) Buff Antimicrobial Vinyl

OFD-ST203 (pg. 52),
BC9601 (pg. 52),
BC9602 (pg. 52),
BC9603 (pg. 52)

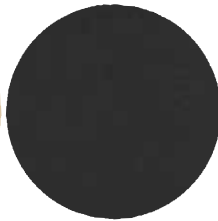

(-R107) Black Antimicrobial Vinyl

ST205 (pg. 37, 52),
ATL51-R107 (pg. 53),
ATL52-R107 (pg. 53),
ATL53-R107 (pg. 53),
MUP51-R107 (pg. 56)

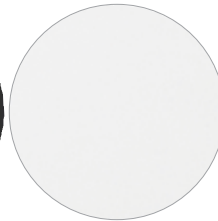

(-R101) Snow Antimicrobial Vinyl

MUP51-R101 (pg. 56)



Black Bonded Leather

529-E3R2N1F2 (pg. 30),
5700SL (pg. 32), 30180 (pg. 35),
39200 (pg. 35)

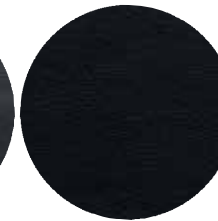

(-9) Black LeatherSoft

OFD-LOOK-9 (pg. 60),
OFD-CUR-9 (pg. 60)



(-10) White LeatherSoft

OFD-LOOK-10 (pg. 60),
OFD-CUR-10 (pg. 60)



(-11) Brown LeatherSoft

OFD-LOOK-11 (pg. 60),
OFD-CUR-11 (pg. 60)



(-15) Red LeatherSoft

OFD-CUR-15 (pg. 60)

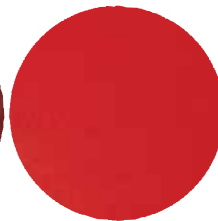

(-RED) Bright Red LeatherSoft

OFD-LOOK-RED (pg. 60)

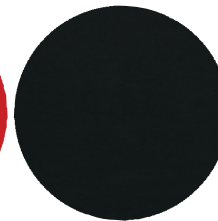

(E) Black Eco Leather

5700E (pg. 32), 57906E (pg. 33),
9333E (pg. 48)

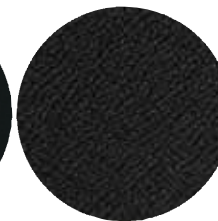

(-231) Black Icon Fabric

FC8433 (pg. 39),
DC2990-231 (pg. 37),
FC8487-231 (pg. 39),
TI-2402-231 (pg. 45),
SI-1104-231 (pg. 63)

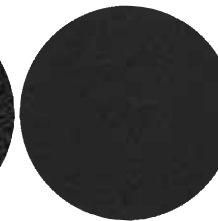

(-30) Coal FreeFlex®

92583-30 (pg. 37), NI-2000-30 (pg. 39),
NI-2200-30 (pg. 39),
NI-1200-30 (pg. 39),
NI-1000-30 (pg. 39),
MI-2102-30 (pg. 41),
MI-2502-30 (pg. 41),
MI-97720-30 (pg. 41),
MI-1122-30 (pg. 42),
MI-1522-30 (pg. 42),
MI-1500-30 (pg. 42),
85670-30 (pg. 42), 85640-30 (pg. 42),
MI-2817-30 (pg. 44),
MI-28174 (pg. 44), TI-1522-30 (pg. 45),
TI-1102-30 (pg. 45),
82740-30 (pg. 63), 86710-30 (pg. 63),
86724-30 (pg. 63),
86725-30 (pg. 63), 8610-30 (pg. 64),
8455-30 (pg. 64),
8620-30 (pg. 64)

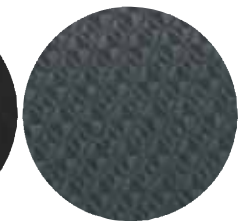

(-33) Guest Chair Black Fabric

K-99 (pg. 61), K-129 (pg. 61),
M-94 (pg. 61)

Seating Fabrics



**(-44) Guest Chair
Black Fabric**

GI-100 (pg. 61), GI-125
(pg. 61)



**(-363) Black
Triangle**

WD-300 (pg. 62),
GI-300C-363 (pg. 62),
GI-300M-363 (pg. 62),
GI-300E-363 (pg. 62),
GI-400C-363 (pg. 62),
GI-400M-363 (pg. 62),
GI-400E-363 (pg. 62)

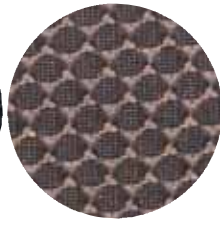

**(-316) Taupe
Fabric**

WD-300 (pg. 62),
GI-300C-316 (pg. 62),
GI-300M-316 (pg. 62),
GI-300E-316 (pg. 62),
GI-400C-316 (pg. 62),
GI-400M-316 (pg. 62),
GI-400E-316 (pg. 62)

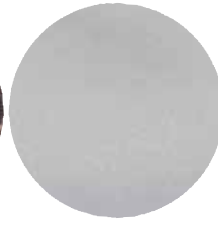

(-2) Gray Fabric

MI-95672-2 (pg. 43),
MI-95673-2 (pg. 43)



**(-L32) Linen
Fabric**

DVS51-L32 (pg. 59),
DVS52-L32 (pg. 59)

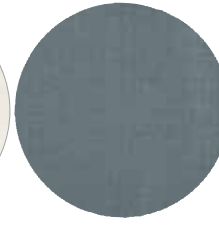

**(-K21) Klein
Sea Fabric**

DVS51-K21 (pg. 59),
DVS52-K21 (pg. 59)

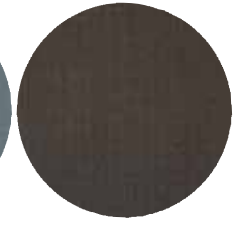

**(-K12) Klein
Otter Fabric**

DVS51-K12 (pg. 59),
DVS52-K12 (pg. 59)



**(-K26) Klein
Charcoal Fabric**

ATH51-K26 (pg. 58),
ATH52-K26 (pg. 58)



**(-S22) Woven
Seaweed**

MST51-S22 (pg. 59),
MST52-S22 (pg. 59),
MST53-S22 (pg. 59),
MST55-S22 (pg. 59)

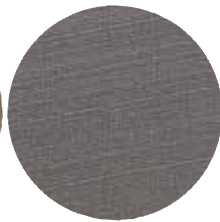

**(-W12) Woven
Charcoal**

MST51-W12 (pg. 59),
MST52-W12 (pg. 59),
MST53-W12 (pg. 59),
MST55-W12 (pg. 59)

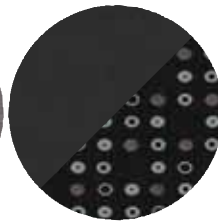

**(-K1R7) Black &
Onyx Fabric**

MST51-K1R7 (pg. 59),
MST52-K1R7 (pg. 59)



**(-K6R4) Buff &
Burch Fabric**

MST51-K6R4 (pg. 59),
MST52-K6R4 (pg. 59)

Item.....	Page	Item.....	Page	Item.....	Page	Item.....	Page
13-37N20D.....	36	ATL52-.....	53	GI-125-.....	61	OFD-7200-.....	50
15-37A720D.....	36	ATL53-.....	53	GI-300C-.....	62	OFD-800-CPU.....	69
183305.....	45	BRW29A4-.....	68	GI-300E-.....	62	OFD-865-3.....	64
213-37N2F3D.....	36	BRW3026A4-.....	68	GI-300M-.....	62	OFD-BC9601-.....	52
2300.....	32	BRW3030A4-.....	68	GI-400C-.....	62	OFD-BC9602-.....	52
30180.....	35	BRW432-.....	68	GI-400E-.....	62	OFD-BC9603-.....	52
317-6C61F6-.....	29	CI-800-.....	66	GI-400M-.....	62	OFD-CUR-.....	60
317-ME36C61F6.....	29	CI-825-.....	66	K-129-.....	61	OFD-LOOK-.....	60
317W-W1C1F2W-.....	28	CI-850-.....	66	K-99-.....	61	OFD-MIHR108M-.....	41
317W-W11C1F2W.....	28	CI-875-.....	66	M-94-CHY.....	61	OFD-MIHR109F.....	41
335-E37P918P.....	33	CI-BAR30R-.....	67	MI-1122-.....	42	OFD-SL8471.....	54
39200.....	35	CI-BAR30SQ-.....	67	MI-1500-30.....	42	OFD-SL8472.....	54
5200W.....	28	CI-BAR36R-.....	67	MI-1522-.....	42	OFD-SL8473.....	54
529-3R2N1F2.....	30	CI-BAR36SQ-.....	67	MI-1800-3.....	44	OFD-ST203-.....	52
529-E3R2N1F2.....	30	CI-BAR-X30R-.....	67	MI-2102-.....	41	OFD-TREX1-.....	69
529-M3R2N6F2.....	30	CI-BAR-X30SQ-.....	67	MI-2502-.....	41	OFD-TREX2-.....	69
529-R22N1F2.....	30	CI-BAR-X36R-.....	67	MI-2817.....	44	OPH61606-EC3.....	49
5500.....	31	CI-BAR-X36SQ-.....	67	MI-28174.....	44	PAC51-.....	54
5500SL.....	31	CI-BREAK30R-.....	67	MI-4102-3.....	44	PAC52-.....	54
5505.....	32	CI-BREAK30SQ-.....	67	MI-8810S-.....	29, 43	PAC53-.....	54
5540.....	33	CI-BREAK36R-.....	67	MI-8810W-.....	29, 43	SI-1104-231.....	63
55403.....	33	CI-BREAK36SQ-.....	67	MI-93720.....	41	SI-1106-3.....	65
5700E.....	32	CI-BREAK-X30R-.....	67	MI-95672-.....	43	SI-1107-3.....	65
5700SL.....	32	CI-BREAK-X30SQ-.....	67	MI-95673-.....	43	STC18A4-.....	65
57906E.....	33	CI-BREAK-X36R-.....	67	MI-95893.....	42	STC205-.....	37, 52
63-37A773HM.....	34	CI-BREAK-X36SQ-.....	67	MI-97720-30.....	41	STC8302C4-3.....	64
69220C-EC3.....	35	DC2990-231.....	37	MI-97728-EC3.....	41	STC866C4-.....	65
69906-3.....	44	DC2990V.....	37	MRG07R1-.....	60	TI-1102-30.....	45
7270.....	46	DC51000NV.....	36	MRG09-.....	60	TI-1522-30.....	45
7271.....	46	DC8309C.....	63	MRG09S-.....	60	TI-2402-231.....	45
7275.....	46	DCY69006-3M.....	37	MRG12-.....	60	TR-101-.....	61
75-37A773.....	34	DOL06.....	65	MRG12SR1-.....	60	TR-102-.....	61
75-47A773.....	34	DOL8302.....	65	MST12.....	60	W001-W050.....	74
8200-3.....	46	DOL865.....	65	MST19.....	60	WD300-.....	62
8201-3.....	46	DVS51-.....	59	MST51-.....	59	WST07.....	57
8205-3.....	46	DVS52-.....	59	MST52-.....	59	WST09.....	57
82740-30.....	63	EC1283C-EC3.....	35	MST53-.....	59	WST12.....	57
839-11B35WA.....	34	EC6582-EC9.....	49	MST55-.....	59	WST16.....	58
8455-30.....	64	ECH68807-EC3.....	48	MUP51-.....	56	WST17.....	57
85640-30.....	42	ECH83507-EC3.....	48	NI-1000-30.....	39	WST51A-.....	55
85670-30.....	42	EM51022N-3.....	45	NI-1200-30.....	39	WST51C-.....	55
8610-30.....	64	FC8433-231.....	39	NI-2000-30.....	39	WST51LF-.....	55
8620-30.....	64	FC8487-231.....	39	NI-2200-30.....	39	WST51N-.....	55
86710-30.....	63	FL3422-U6.....	49	NI-84224T.....	40	WST51OP-.....	55
86724-30.....	63	FL5380C-.....	47	NI-84225T.....	40	WST51P-.....	55
86725-30.....	63	FL5388C-.....	47	NI-84226T.....	40	WST51RF-.....	55
92583-30.....	37	FL7480-U6.....	51	NI-842HR24T.....	40	YLD07.....	58
9333E.....	48	FL7481-U6.....	51	OFD-200-DR.....	69	YLD09.....	58
A15.....	36	FL7484-U6.....	51	OFD-3030-3.....	65	YLD12.....	58
A27WA.....	36	FL7485-U6.....	51	OFD-605-BLK.....	49	YLD14.....	58
ALB43211-.....	68	FL89675-U6.....	48	OFD-6583-.....	49	YLD17.....	58
ATH51-.....	58	FL92017C-.....	47	OFD-6640-.....	46		
ATH52-.....	58	FL9097-U6.....	48	OFD-7000-.....	50		
ATL51-.....	53	GI-100-.....	61	OFD-7100-.....	50		

Limited Lifetime Warranty

Items are warranted from the original purchase date and to the original purchaser for normal commercial usage – defined as a standard 40-hour work week and by persons weighing 250 lbs. or less, unless otherwise stated – according to the below-listed schedule and limitations.

desk it. (Wood & Laminate) nest it. (tables) connect it. bench it.

- 10 years against failure due to materials and workmanship
- Laminate finishes are covered for a period of 5 years.
- Veneer finishes are covered for a period of 3 years.
- Connect It Electrical - One year Limited Warranty, Base in Connection made by Licensed Electrician.
- Task Lights – One Year Limited Warranty
- Height Adjustable Electric Motors are covered for a period of 2 years, the bases for 5 years.
- 1 year on fabric and foam.

lift it.

- 2 year warranty on motor.
- 5 year warranty on base.

space it. big & tall it. raise it. train it. nest it. (chairs) mesh it. task it. guest it. stack it.

- Lifetime on component chair parts including pneumatic cylinder, control mechanism, base and casters.
 - 3 years on upholstery fabric and foam against wear and deterioration.
 - Leather is not warranted against routine scratching and scuffing, as leather is subject to minor blemishes in use.
- The 839-11B35WA, 63-37A773HM, 75-37A773, 75-47A773, 30180, 69220C-EC3, and 39200 are for persons weighing 400 lbs. or less, the TI-2402-231 is 300 lbs. or less, the 15-37A720D is 325 lbs. or less and the EC1283C-EC3 are 350 lbs. or less. When usage is more than 40 hours per week, a five year warranty on all parts applies. Fabric is warranted for one year.

screen it.

- 5 year warranty
- 2 years on component parts including pneumatic cylinders, control mechanisms, wood, plastic parts, base and casters.
- 1 year on upholstery fabric and foam against wear and deterioration.
- The 183305 is warranted for 200 lbs. weight limit. Recommended for residential use.

leather it. manage it.

- 15 years on all non-moving metal parts.
- 5 years on component parts including pneumatic cylinders, control mechanisms, wood, plastic parts, base and casters.
- 3 years on upholstery fabric and foam against wear and deterioration.
- Leather is not warranted against routine scratching and scuffing, as leather is subject to minor blemishes in use.

healthcare it.

- 5 Year warranty
- The OFD-BC9601 are for persons weighing 300 lbs. or less, the OFD-BC9602 are 400 lbs. or less and the OFD-BC9603 are 500 lbs. or less.

guest it. lounge it. accent it.

- 5 years on structural integrity of frame.
- 3 years on seating wood finishes.
- 3 years on upholstery fabric and Foam against wear and deterioration (except leather).
- Leather is not warranted against routine scratching and scuffing, as leather is subject to minor blemishes in use. Minor variations in color, texture and grain are a natural part of leather hides, and therefore, are not covered by this warranty.
- C.O.M. Fabrics are not warranted.

café it.

- 2 year warranty for parts.

cube it.

- 3 year warranty for fabric on all panel products.
- Task Light Bulbs and Ballasts are normal wear and tear replaceable parts, and are warranted for 1 year.

Grain, Color and Finishes

Variation of grain and color are natural, inherent characteristics of wood, a living material. This variation is part of the beauty of real wood and anticipated in wood veneer furnishings. Therefore, the Seller is not warranted to match in grain or color or texture. It is a natural phenomenon for wood grain to change in color as it ages, and wood finishes are not warranted for color-fastness.

The Seller will, at their discretion, repair or replace, to the original purchaser, any product that is defective in materials or workmanship, given normal use and care of single shift service, standard commercial usage, defined as a standard 8 hour work day, 5 days a week. Variations occurring in wood, fabric and other natural materials are inherent to their character and are not considered defects. This warranty does not cover: damage caused by transportation, cost of transportation or labor, freight, misuse, abuse, negligence, alteration, accident, vandalism, rusting, cosmetic damage that may result from normal use, acts of nature or any other event beyond the control of the Seller.

Limitation of Liability

Under no circumstance, including but not limited to breach of contract, breach of warranty of negligence, shall the Seller be liable for lost profits, loss of goodwill, stored data, general, special, consequential or exemplary damages, even if the Seller had notice of these damages or they were foreseeable. The Seller shall not be responsible for verifying customer's description of needs, data, or the fitness for a particular purpose of goods. The Seller's liability in all cases shall be limited to repair or replacement of the defective parts, or the purchase price of the product.

EXCEPT AS OTHERWISE PROVIDED, SELLER MAKES NO OTHER WARRANTIES, EXPRESSED OR IMPLIED, INCLUDING BUT NOT LIMITED TO THE WARRANTIES OF MERCHANTABILITY AND FITNESS FOR A PARTICULAR PURPOSE. PRICES SUBJECT TO CHANGE WITHOUT NOTICE.

Ordering Procedure

An approved credit application is required to open an OFFICE FURNITURE DISTRIBUTORS (OFD) account and process an order. Orders can only be accepted from authorized OFD dealers. Orders from customers without a previous OFD credit rating will not be accepted without satisfactory references accompanying the order or other arrangements being made. OFD does not accept verbal purchase orders or revisions. Orders are accepted via fax or e-mail only. Please fax purchase orders to 972-386-5300 or e-mail to cs@ofd.com

Order Acknowledgement

OFD sends acknowledgements on all orders. Please examine the acknowledgement carefully and advise us immediately of any discrepancies. The Order Acknowledgment is the final agreement between OFD and the customer, superseding all previous communication regarding that order.

Cancellation and Order Changes

In-Stock Program

Cancellations or revisions will not be accepted after the order has shipped.

Build-To-Order Program

Cancellations or revisions will not be accepted after the order has been acknowledged and entered into production and any deposit made will be forfeited.

Delivery Time

In-Stock Program

Normally, credit approved orders will be ready next day if purchase order is received by 12:00 p.m. CST. Orders received after these times will be ready the following business day. For orders requiring assembly, a minimum of 72 hours (depending on size of order) is normally required. Please contact Warehouse Scheduling for ready date confirmation.

Build-To-Order Program

A 50% deposit is required to enter your order into production. Products are shipped to any point of destination within the continental USA in 6–10 weeks.

Availability

OFD maintains a high level of inventory in our In-Stock Program in our regional distribution center. Our inventory is replenished on a regular basis, and orders are filled on a first come first served basis once a confirmed order is placed and an order acknowledgement is received.

A 20% deposit is required in order to hold inventory based on availability. OFD will hold product up to 14 calendar days. Deposit will be forfeited after this period unless a written cancellation request is submitted within 14 calendar days or a confirmed purchase order is received. **Please note:** large orders may require an extended lead time. In the event an item is not available, two options may apply that require written authorization from the dealer:

Option 1

Partial ship available quantity and back order remaining items — **minimum drop off charges (if applicable) apply to BOTH the initial partial shipment as well as any subsequent back order shipments.**

Option 2

Hold until complete order is available.

Drop Shipments and Price Zoning

Please contact Customer Service for pricing on orders requiring shipment to a destination other than the dealers dock.

Parts Replacement

Replacement parts are available from our distribution center for certain products. Parts for items designated as '**Pre-Assembled**' require ordering from our factory.

Claims

Freight Damage | Refusals | Shortages

OFD Customer Service will administer the filing of these claims if the order is shipped via our designated carriers. All claims must be filed with OFD within 15 calendar days of receipt of goods. Claim will be disputed if product is moved from original 'ship to' location. In order to expedite the process, the following documents are required to file a claim:

- Copy of bill of lading with notations for any visible damages, refusals, or shortages
- OFD Claim Form
- Digital photos of the damaged material

OFD will not be responsible for filing claims if order is shipped via the customer's selected carrier.

Manufacturing Defect | Concealed Damage

Claims for a manufacturing defect or concealed damage must be filed with OFD within 15 days of receipt of goods. The following documents are required to process your claim:

- Digital photos
- OFD claim form

In order to send out an immediate replacement to fulfill your customer needs pending resolution of the claim, the following document is required:

- A signed OFD Disclaimer regarding product responsibility

Returns

Due to the likelihood of damage, OFD discourages product returns. In the event a product return is found necessary, we will make every attempt to assist our customers to keep the product in the field. Please contact Customer Service for assistance with this service. If attempts to keep the product in the field are unsuccessful, OFD will allow returns on stock items only and issue a Return Merchandise Authorization (RMA) with the following stipulations:

- A 30% restocking fee will apply
- Freight charges are prepaid by dealer
- Product has never been removed from original carton
- Product must be returned within 30 days of RMA issue date
- Credit will not be issued if product is returned damaged

Credit will not be provided on any items returned without an RMA, or on merchandise that has been subject to freight damage, missing parts, usage or been removed from the original carton. Returns without a pre-authorized RMA will be refused. OFD will not be responsible for resolving damage and/or freight claims on returned product.

Warranty Issues

Claims for warranty issues must be filed with OFD. The following documents are required:

- Original OFD invoice number
- Detailed description of issues
- OFD Claim Form
- Digital photos

Delivery Information

All shipments are FOB point of shipment. Pricing is based on standard delivery (8 a.m. to 5 p.m. Monday through Friday). OFD reserves the right to select the most appropriate carrier and routing on all shipments. Orders requiring special delivery services (including but not limited to the following) will incur additional charges:

- Drop shipping
- Assembly charges
- Inside delivery
- Installation
- Call before delivery
- No dock delivery
- Non-standard delivery time
- Residential delivery
- Lift gate truck

General Information

Prices shown are list prices for shipment within the OFD coverage area. Merchandise is billed at the prevailing price at time of order placement. Prices are subject to change without notice. Should a typographical error be found, we reserve the right to correct it. OFD reserves the right to make changes in design or construction without prior notice.

Payment by check must be made out to Office Furniture Distributors. A \$50 fee will be charged for return checks. Past due accounts will be subject to a finance charge of 1½% per month.

Distribution of the OFD price list does not in itself constitute an offer to sell. Possession of the price list does not constitute authority to purchase.

in stock • in stock • in stock • in stock • in stock • in stock • in stock •



Need it!



Gotta have it!



Wow!



OFD

Distribution Center | Showroom

2901 Trade Center Dr., Suite 100

Carrollton, TX 75007

972-386-5200 Phone

866-648-3635 Toll Free

972-386-5300 Fax

www.ofdist.com

