

TR101/TR102 TRADITIONAL VISITORS CHAIR ASSEMBLY INSTRUCTIONS

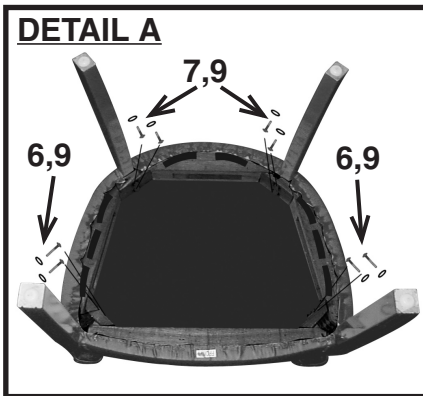
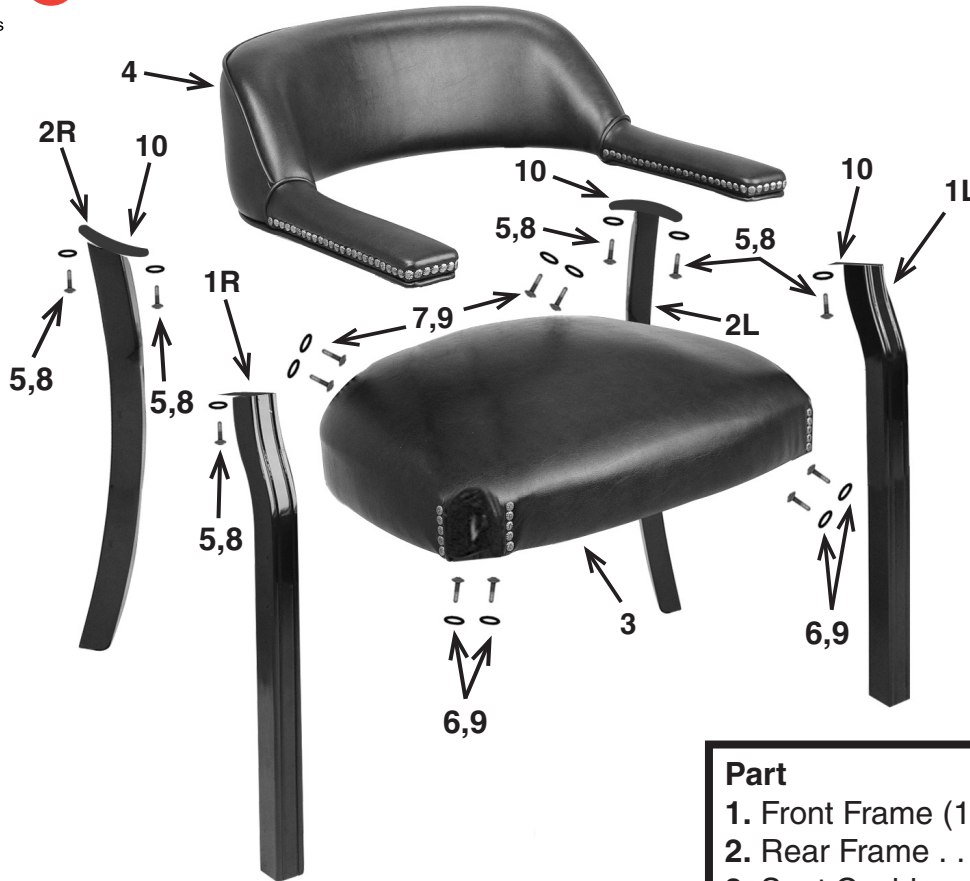

Part	QTY
1. Front Frame (1L & 1R)	2
2. Rear Frame	2
3. Seat Cushion	1
4. Back Cushion	1
5. 1" Screws	6
6. 3 1/2" Screws	4
7. 2" Screws	4
8. Small Washers	6
9. Large Washers	8
10. Metal Brackets	4
11. Allen Wrench (not shown) . .	1

- STEP 1** Remove all the parts from carton, separate them into part numbers indicated on the list and make sure part quantities are correct.
- STEP 2** Attach Front Frame (1L & 1R) to Seat Cushion (3) using two 3 1/2" Screws (6) and two Large Washers (9) for each frame. **(SEE DETAIL A)**
DO NOT TIGHTEN SCREWS
- STEP 3** Attach Rear Frame (2) to Seat Cushion (3) using two 2" Screws (7) and two Large Washers (9) for each frame. **(SEE DETAIL A)**
DO NOT TIGHTEN SCREWS
- STEP 4** Insert Back Cushion (4) onto Metal Brackets (10) of Front Frame (1L & 1R) and Rear Frame (2) using six 1" Screws (5) and six Small Washers (8). **FULLY TIGHTEN ALL SCREWS.**
- STEP 5** Attach fabric under seat to velcro.
- NOTE: MODEL TV231 CASTERS ARE PRE-INSTALLED**
- ATTENTION: MAKE SURE ALL SCREWS ARE FULLY TIGHTENED BEFORE USING CHAIR.**